

# GEWISS

## Serie 42 RV

**IP 55** 

---

**CON PULSANTE 1NA + 1NC**

*WITH PUSH BUTTON 1NO + 1NC - AVEC BOUTON-POUSOIR 1NO + 1NF - CON  
PULSADOR 1NA + 1NC - MIT TASTE 1 SCHLIEßER + 1 ÖFFNER*

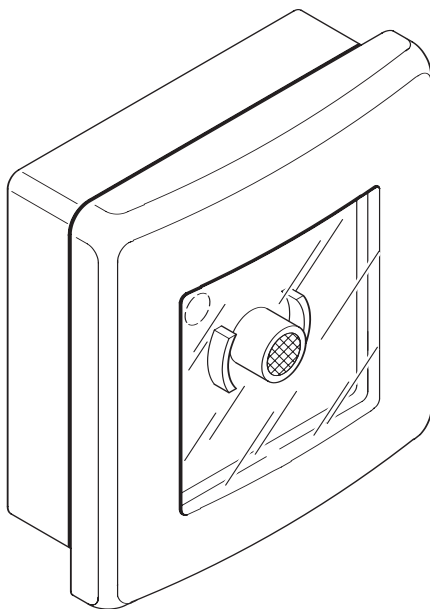

**Rosso - Red - Rouge - Rojo -Rot**  
**RAL 3000**



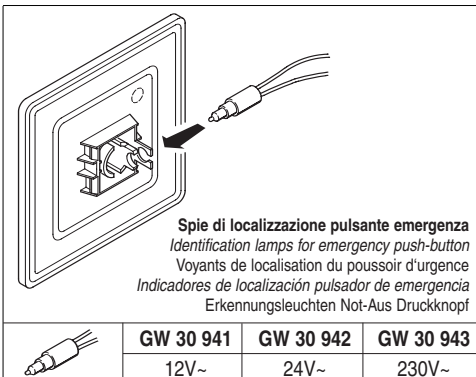
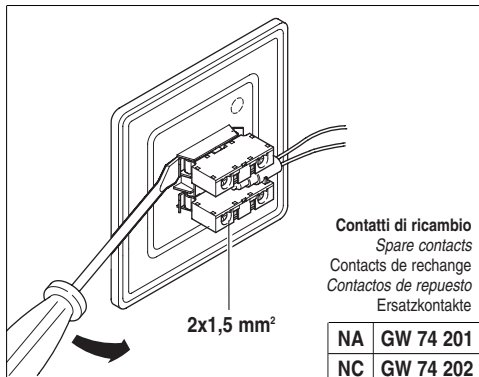
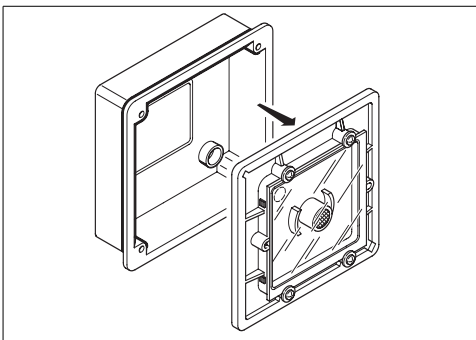
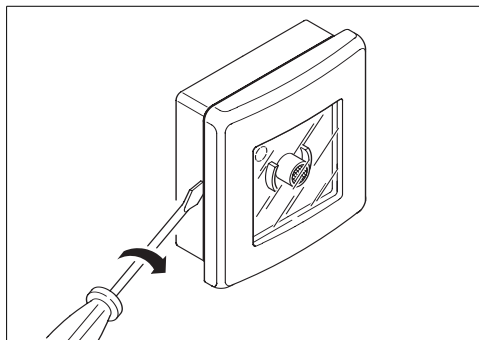



**GW 42 201**

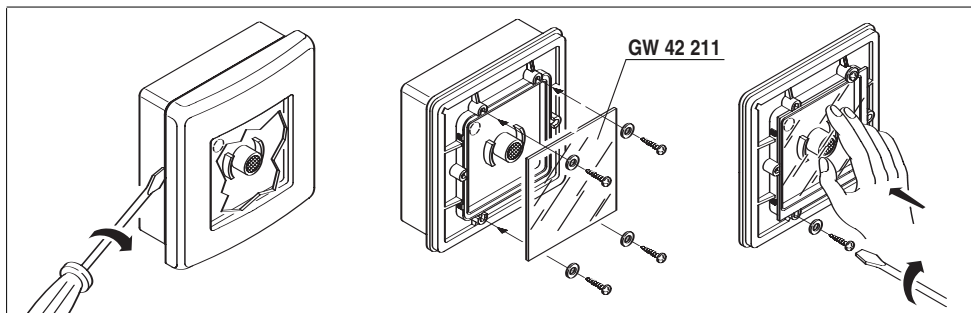
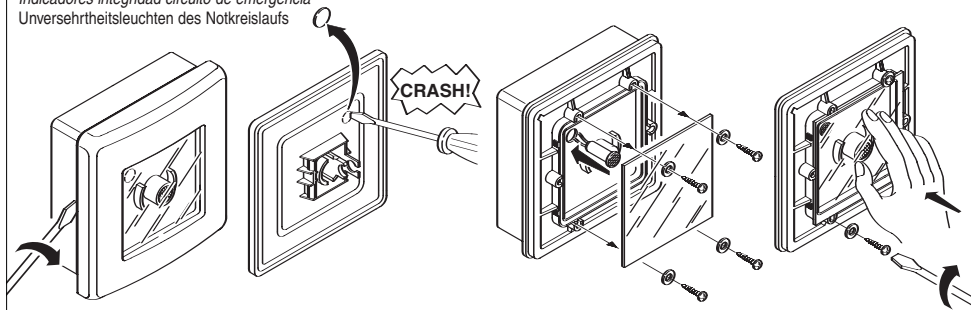

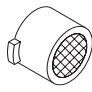
**Spie integrità circuito emergenza**  
Emergency circuit intactness lamp  
Témoins de l'intégrité du circuit d'urgence  
Indicadores integridad circuito de emergencia  
Unversehrtheitsleuchten des Notkreislaufs

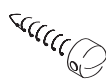
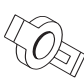
	<b>GW 30 958</b> 12-24V~/–	<b>GW 30 959</b> 110-230V~/–
--	-------------------------------	---------------------------------



					 3,5x16		 3,5x30
1	1	1	2	2	2	2	2

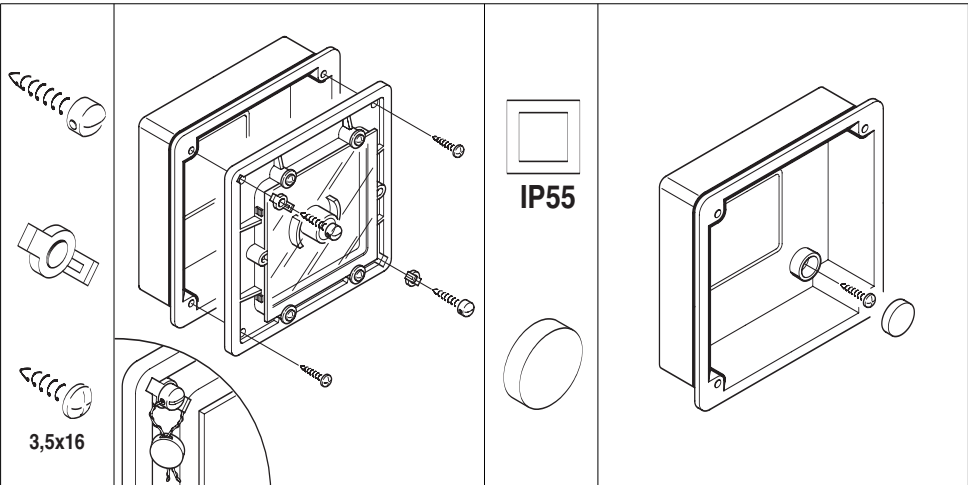
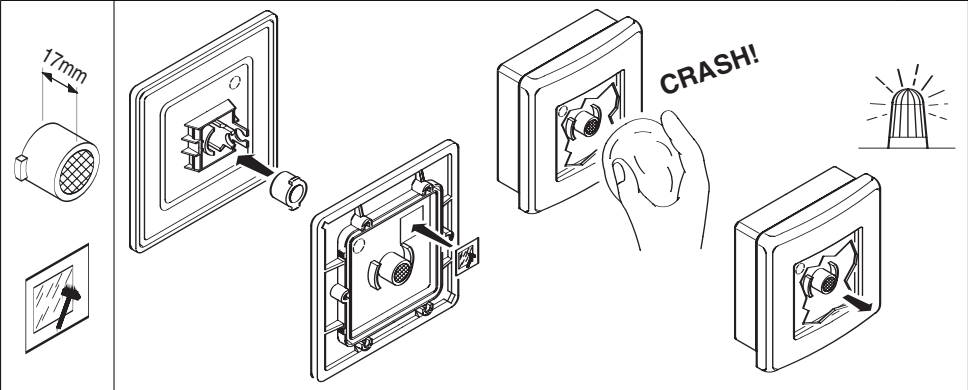
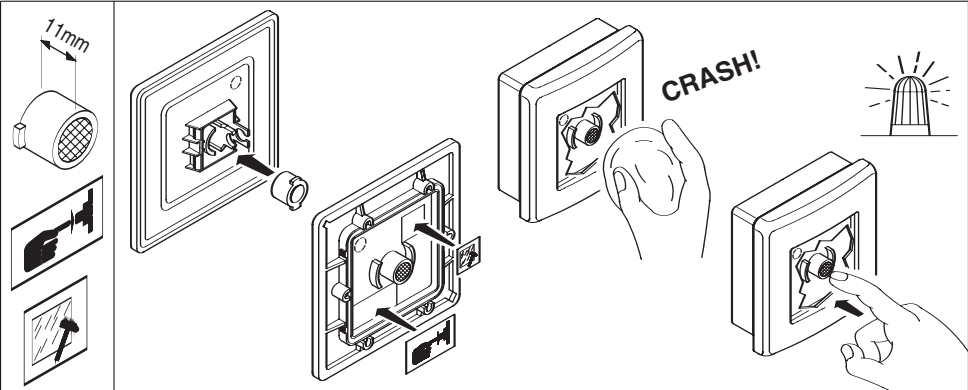

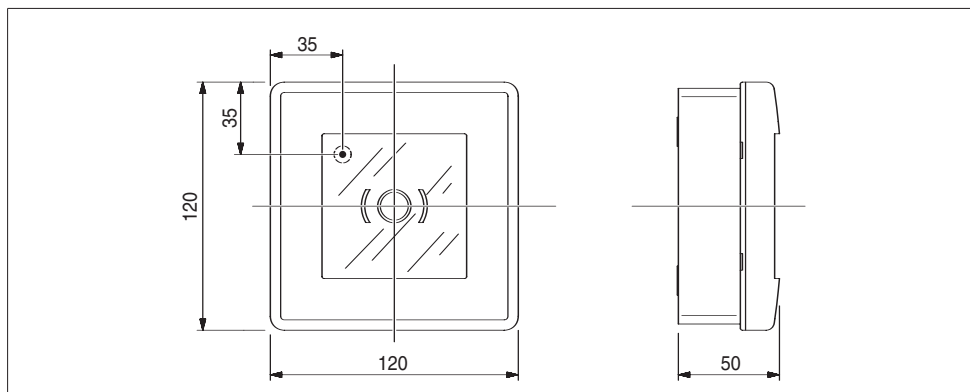
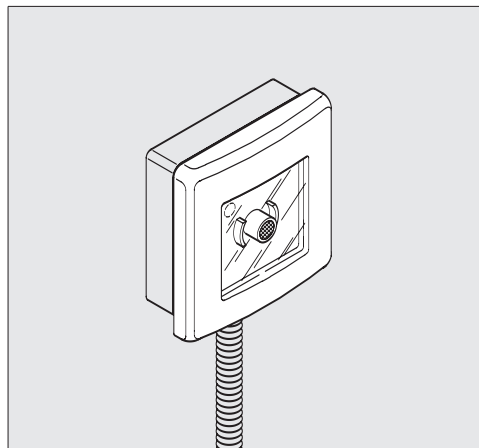
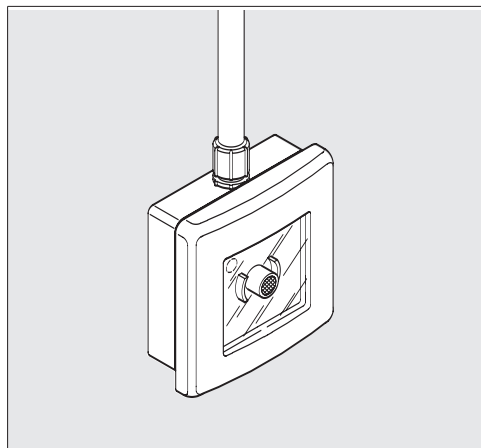
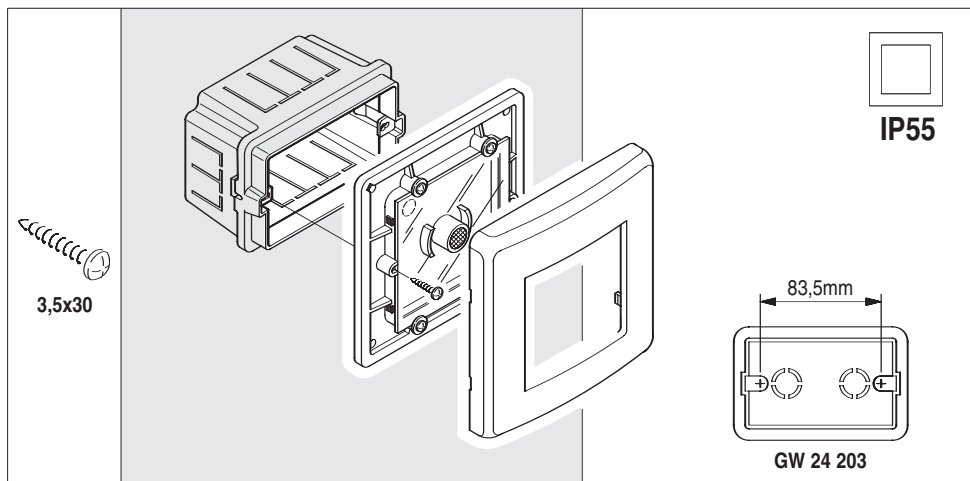

**GEWISS - MATERIALE ELETTRICO**

**SAT**



+39 035 946 111  
8.30 - 12.30 / 14.00 - 18.00  
da lunedì a venerdì



+39 035 946 260  
24 ore al giorno



@ SAT on line  
gewiss@gewiss.com