



**Tabela Preços | Caminho de Cabos**

TABELA DE PREÇOS  
2010





**5 Acabamentos****Caminho de Cabos** (Galvanizado [G] / Galvanizado a Quente [Q])**7 Chapa de Aço**

- . Calha Perfurada Estampada
- . Calha Perfurada
- . Calha Não Perfurada
- . Acessórios

**47 Varão Electro Soldado**

- . Calha em Varão Electro Soldado
- . Acessórios

**51 Chapa de Aço** (Alimentação de Motores)

- . Calha Perfurada para Alimentação de Motores
- . Acessórios

**55 Sistemas de Suspensão**

- . Acessórios

**67 Chapa de Aço** (Resistente ao Fogo)

- . Calha Perfurada Estampada Resistente ao Fogo
- . Acessórios

Notas

---

---

---

---

---

---

---

---

---

---

---

---

---

---

---

## Seleção de acabamentos

Os Caminhos de Cabos e Acessórios da INDELAGUE estão disponíveis em vários tipos de acabamentos para satisfazer as necessidades da Indústria.

Poderá recorrer aos símbolos seguintes para o ajudar a determinar o melhor acabamento para a sua aplicação.

Símbolos	Acabamento	Norma	Aplicação
<b>G</b>	<b>Pré-Galvanizada:</b> Galvanização Contínua antes da Fabricação	EN 10327	<b>Aplicações Interiores:</b> Superfícies Comerciais; Escritórios Comerciais: Salas de Computadores
<b>Q</b>	<b>Galvanizada por Imersão a Quente:</b> Após Corte e Quinagem	NP EN ISO 1461	<b>Aplicações Exteriores:</b> Ambientes Corrosivos

## Outros Acabamentos, sob consulta

Símbolos	Acabamento	Norma	Aplicação
<b>I</b>	<b>Aço Inox</b>		<b>Ambientes Marítimos:</b> Navios, Refinarias, Espaços Fabris, Estações de Tratamentos de Águas
<b>D</b>	<b>Dacromete:</b> Zinco e Proteção de Alumínio equivalente ao Galvanizado por Imersão a Quente	EN ISO 10683	<b>Aplicações Exteriores:</b> Ambientes Corrosivos
<b>ZB</b>	<b>Electrozincado:</b> Zincado e Pasivado a Branco (ZB)	EN 10152 (ZB)	<b>Aplicações Interiores:</b> Superfícies Comerciais, Escritórios, Salas de Computadores
<b>P</b> <b>B</b>	<b>Pintado:</b> Epoxy poliéster em Branco (B), em Preto (P), ou outro RAL pretendido		<b>Aplicações Interiores Expostas:</b> Escolas, Casinos, Salas de Computadores, Hospitais

Notas

---

---

---

---

---

---

---

---

---

---

---

---

---

---

---

## Caminho de Cabos em Chapa de Aço

. Calha Perfurada Estampada / Tampa	Pg. 8/9
. Calha Perfurada / Tampa e Mola de Fixação	Pg. 10/11
. Calha Não Perfurada / Tampa	Pg. 12/13
<b>Acessórios</b>	
. Uniões Rápidas / Simples	Pg. 14/15
. Uniões Articuladas	Pg. 16
. Suportes Caixa Derivação	Pg. 17
. Curvas / Tampa	Pg. 18/19
. Curvas a 45° / Tampa	Pg. 20/21
. Cruzetas / Tampa	Pg. 22/23
. Derivações “T” / Tampa	Pg. 24/25
. Derivações Laterais / Tampa	Pg. 26/27
. Ângulos Subida-Descida / Tampa	Pg. 28/29
. Curvas Ângulo Subida / Tampa	Pg. 30/31
. Curvas Ângulo Descida / Tampa	Pg. 32/33
. Reduções Simples	Pg. 34/35
. Reduções Direitas / Tampa	Pg. 36/37
. Reduções Esquerdas / Tampa	Pg. 38/39
. Reduções Centrais / Tampa	Pg. 40/41
. Topos	Pg. 42/43
. Cantos de Derivação Lateral Dupla	Pg. 44
. Separadores	Pg. 45/46



## Chapa de Aço Perfurada e Estampada

**CHG/CHQ**

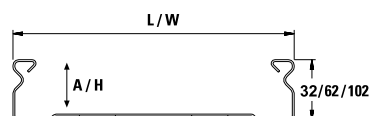
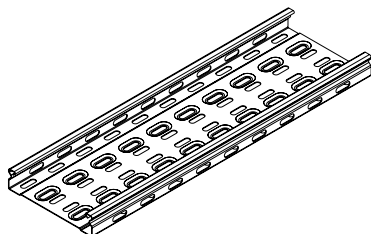

### . ABA 30 .

Código		Largura L(mm)	Espessura (mm)	Peso Atado(Kg)		Volume Atado(m3)		Euros €	
G	Q			Calha 2m	Calha 3m	Calha 2m	Calha 3m	G	Q
CHG10030E3	CHQ10030E3	100	0,7	3,750	5,580	0,00768	0,01210	<b>5,84</b>	<b>8,76</b>
CHG15030E3	CHQ15030E3	150	0,7	4,825	7,015	0,01108	0,01730	<b>7,60</b>	<b>11,40</b>
CHG20030E3	CHQ20030E3	200	0,7	5,790	8,915	0,01448	0,02260	<b>8,27</b>	<b>12,41</b>
CHG25030E3	CHQ25030E3	250	0,7	6,985	10,310	0,01788	0,02780	<b>11,54</b>	<b>17,31</b>
CHG30030E3	CHQ30030E3	300	0,7	7,910	11,825	0,02135	0,03310	<b>12,77</b>	<b>19,16</b>
CHG40030E3	CHQ40030E3	400	0,8	10,125	15,170	0,02910	0,04360	<b>19,22</b>	<b>28,83</b>

Atados de 4m > Calha de 2m / Atados de 6m > Calha de 3m

### . ABA 60 .

Código		Largura L(mm)	Espessura (mm)	Peso Atado(Kg)		Volume Atado(m3)		Euros €	
G	Q			Calha 2m	Calha 3m	Calha 2m	Calha 3m	G	Q
CHG10060E3	CHQ10060E3	100	0,7	4,975	6,075	0,01449	0,02136	<b>6,78</b>	<b>10,17</b>
CHG15060E3	CHQ15060E3	150	0,7	5,925	8,790	0,02054	0,03081	<b>8,25</b>	<b>12,38</b>
CHG20060E3	CHQ20060E3	200	0,7	7,105	10,490	0,02684	0,04026	<b>9,38</b>	<b>14,07</b>
CHG25060E3	CHQ25060E3	250	0,7	8,145	13,960	0,03314	0,04743	<b>12,30</b>	<b>18,45</b>
CHG30060E3	CHQ30060E3	300	0,7	9,185	13,610	0,03956	0,05935	<b>13,10</b>	<b>19,65</b>
CHG40060E3	CHQ40060E3	400	0,8	11,000	16,760	0,05400	0,07626	<b>20,42</b>	<b>30,63</b>
CHG50060E3	CHQ50060E3	500	1,0	16,230	24,000	0,06700	0,10040	<b>24,59</b>	<b>36,89</b>
CHG60060E3	CHQ60060E3	600	1,0	18,800	30,250	0,07990	0,11990	<b>28,75</b>	<b>43,13</b>

Atados de 4m > Calha de 2m / Atados de 6m > Calha de 3m

### . ABA 100 .

Código		Largura L(mm)	Espessura (mm)	Peso Atado(Kg)		Volume Atado(m3)		Euros €	
G	Q			Calha 2m	Calha 3m	Calha 2m	Calha 3m	G	Q
CHG100100E3	CHQ100100E3	100	0,7	6,365	9,550	0,02650	0,03970	<b>25,41</b>	<b>38,15</b>
CHG200100E3	CHQ200100E3	200	0,7	8,688	12,640	0,04100	0,06770	<b>29,70</b>	<b>44,55</b>
CHG300100E3	CHQ300100E3	300	0,7	10,505	15,950	0,06620	0,09920	<b>35,26</b>	<b>52,90</b>
CHG400100E3	CHQ400100E3	400	0,9	16,210	25,150	0,08720	0,13070	<b>43,01</b>	<b>64,55</b>
CHG500100E3	CHQ500100E3	500	0,9	-	28,350	-	0,16220	<b>47,94</b>	<b>71,95</b>

Atados de 4m > Calha de 2m / Atados de 6m > Calha de 3m

### Acessórios

### Tampa para Calha

TCHG/TCHQ

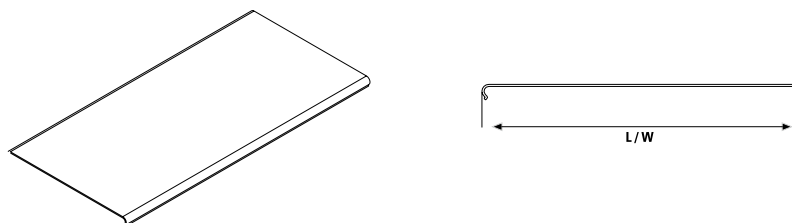

G/Q

Código		Largura L(mm)	Peso(Kg)		Volume(m3)		Euros €	
G	Q		Calha 2m	Calha 3m	Calha 2m	Calha 3m	G	Q
TCHG100E3	TCHQ100E3	100	1,130	1,688	0,00208	0,00309	6,07	9,11
TCHG150E3	TCHQ150E3	150	-	-	-	-	7,10	10,65
TCHG200E3	TCHQ200E3	200	1,746	2,636	0,00416	0,00630	10,05	15,10
TCHG250E3	TCHQ250E3	250	-	-	-	-	10,65	16,00
TCHG300E3	TCHQ300E3	300	2,535	4,642	0,00626	0,00945	13,50	20,25
TCHG400E3	TCHQ400E3	400	-	-	-	-	21,10	31,65
TCHG500E3	TCHQ500E3	500	-	-	-	-	26,90	40,35
TCHG600E3	TCHQ600E3	600	-	-	-	-	38,40	57,60

## Chapa de Aço Perfurada

**CAG/CAQ**

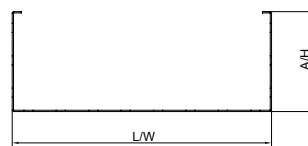
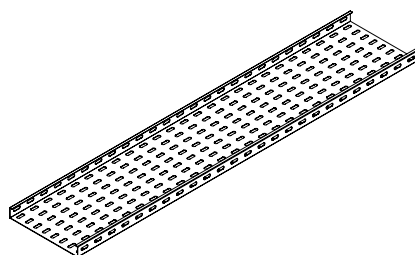

### . ABA 25 .

Código		Largura L (mm)	Espessura (mm)	Peso/Atado (Kg)	Volume/Atado (m3)	Atado (m)	Euros €	
G	Q						G	Q
CAG05025R2	CAQ05025R2	50	1,0	10,600	0,00277	16	5,70	5,10
CAG07525R2	CAQ07525R2	75	1,0	5,120	0,00400	8	6,25	8,55
CAG10025R2	CAQ10025R2	100	1,0	-	-	8	8,80	9,38
CAG15025R2	CAQ15025R2	150	1,0	-	-	8	11,50	13,20
CAG20025R2	CAQ20025R2	200	1,0	-	-	8	12,45	17,25

### . ABA 50 .

Código		Largura L (mm)	Espessura (mm)	Peso/Atado (Kg)	Volume/Atado (m3)	Atado (m)	Euros €	
G	Q						G	Q
CAG05050R2	CAQ05050R2	50	1,0	6,220	0,00520	8	6,25	9,38
CAG07550R2	CAQ07550R2	75	1,0	7,140	0,01190	8	8,20	12,30
CAG10050R2	CAQ10050R2	100	1,0	-	-	8	10,20	15,30
CAG15050R2	CAQ15050R2	150	1,0	-	-	8	12,40	18,60
CAG20050R2	CAQ20050R2	200	1,0	-	-	8	14,10	21,15

### . ABA 75 .

Código		Largura L (mm)	Espessura (mm)	Peso/Atado (Kg)	Volume/Atado (m3)	Atado (m)	Euros €	
G	Q						G	Q
CAG07575R2	CAQ07575R2	75	1,0	-	-	8	9,90	14,85
CAG10075R2	CAQ10075R2	100	1,0	-	-	8	14,25	21,38
CAG15075R2	CAQ15075R2	150	1,0	-	-	8	16,75	25,13
CAG20075R2	CAQ20075R2	200	1,0	-	-	8	19,65	29,48

### . ABA 100 .

Código		Largura L (mm)	Espessura (mm)	Peso/Atado (Kg)	Volume/Atado (m3)	Atado (m)	Euros €	
G	Q						G	Q
CAG100100R2	CAQ100100R2	100	1,0	-	-	8	38,15	57,23
CAG150100R2	CAQ150100R2	150	1,0	-	-	8	41,40	62,10
CAG200100R2	CAQ200100R2	200	1,0	-	-	8	44,55	66,83

### Acessórios

#### Tampa para Calha

**TCAG/TCAQ**

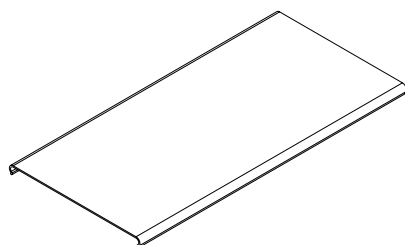

**G/Q**

Código		Largura L (mm)	Peso (Kg)	Volume (m3)	Euros €	
G	Q				G	Q
TCAG050R2	TCAQ050R2	50	0,630	0,00092	<b>4,20</b>	<b>6,30</b>
TCAG075R2	TCAQ075R2	75	0,710	0,00133	<b>5,40</b>	<b>8,10</b>
TCAG100R2	TCAQ100R2	100	-	-	<b>6,07</b>	<b>9,11</b>
TCAG150R2	TCAQ150R2	150	-	-	<b>7,10</b>	<b>10,65</b>
TCAG200R2	TCAQ200R2	200	-	-	<b>10,05</b>	<b>15,08</b>

Tampa em Inox e lacada > Preço sob consulta

#### Mola Fixação da Tampa

**FIXTAMP**

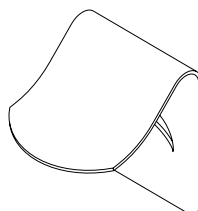

Código		Un/Emb	Peso (Kg)	Volume (m3)	Euros €	
G	Q				G	Q
FIXTAMP	-	1	0,004	0,00001	<b>2,90</b>	-

Mola em Inox e lacada > Preço sob consulta

## Chapa de Aço Não Perfurada

**CHG/CHQ**

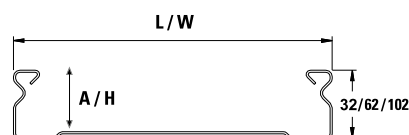
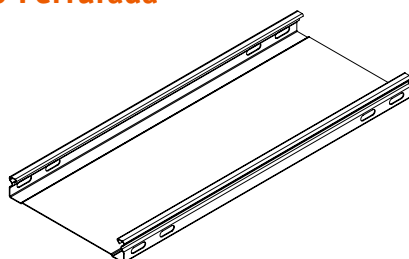

### . ABA 30 .

Código		Largura L(mm)	Espessura (mm)	Peso Atado(Kg)		Volume Atado(m3)		Euros €	
G	Q			Calha 2m	Calha 3m	Calha 2m	Calha 3m	G	Q
CHG10030L3	CHQ10030L3	100	0,7	4,210	-	0,00810	-	7,60	11,40
CHG15030L3	CHQ15030L3	150	0,7	5,320	-	0,01160	-	9,90	14,85
CHG20030L3	CHQ20030L3	200	0,7	6,395	-	0,01510	-	10,75	16,13
CHG30030L3	CHQ30030L3	300	0,7	12,710	-	0,02210	-	16,60	24,90
CHG40030L3	CHQ40030L3	400	0,8	-	-	0,02910	-	25,00	37,50

Atados de 4m > Calha de 2m / Atados de 6m > Calha de 3m

### . ABA 60 .

Código		Largura L(mm)	Espessura (mm)	Peso Atado(Kg)		Volume Atado(m3)		Euros €	
G	Q			Calha 2m	Calha 3m	Calha 2m	Calha 3m	G	Q
CHG10060L3	CHQ10060L3	100	0,7	2,732	-	0,01277	-	8,85	13,28
CHG15060L3	CHQ15060L3	150	0,7	6,740	-	0,02150	-	10,75	16,13
CHG20060L3	CHQ20060L3	200	0,7	8,220	-	0,02800	-	12,20	18,30
CHG30060L3	CHQ30060L3	300	0,7	12,575	-	0,04100	-	17,05	25,58
CHG40060L3	CHQ40060L3	400	0,8	11,980	-	0,05400	-	26,55	39,83
CHG50060L3	CHQ50060L3	500	0,8	-	-	-	-	32,00	48,00

Atados de 4m > Calha de 2m / Atados de 6m > Calha de 3m

### . ABA 100 .

Código		Largura L(mm)	Espessura (mm)	Peso Atado(Kg)		Volume Atado(m3)		Euros €	
G	Q			Calha 2m	Calha 3m	Calha 2m	Calha 3m	G	Q
CHG100100L3	CHQ100100L3	100	0,7	9,165	-	0,02650	-	36,53	54,80
CHG200100L3	CHQ200100L3	200	0,7	-	-	0,04520	-	44,98	67,47
CHG300100L3	CHQ300100L3	300	0,7	14,710	-	0,06620	-	53,43	80,15
CHG400100L3	CHQ400100L3	400	0,9	-	-	0,08720	-	63,18	94,77
CHG500100L3	CHQ500100L3	500	0,9	-	-	-	-	77,22	115,83

Atados de 4m > Calha de 2m / Atados de 6m > Calha de 3m

### Acessórios

### Tampa para Calha

**TCHG/TCHQ**

**G/Q**

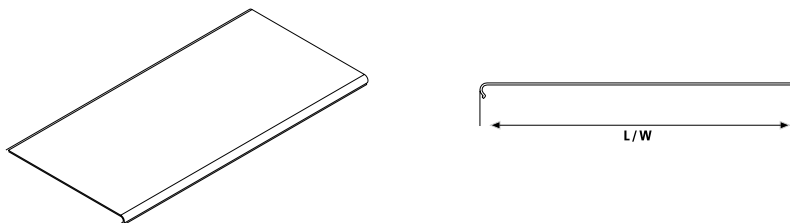

Código		Largura L(mm)	Peso(Kg)		Volume(m3)		Euros €	
G	Q		Calha 2m	Calha 3m	Calha 2m	Calha 3m	G	Q
TCHG100E3	TCHQ100E3	100	1,130	1,688	0,00208	0,00309	<b>6,07</b>	<b>9,11</b>
TCHG150E3	TCHQ150E3	150	-	-	-	-	<b>7,10</b>	<b>10,65</b>
TCHG200E3	TCHQ200E3	200	1,746	2,636	0,00416	0,00630	<b>10,05</b>	<b>15,10</b>
TCHG300E3	TCHQ300E3	300	2,535	4,642	0,00626	0,00945	<b>13,50</b>	<b>20,25</b>
TCHG400E3	TCHQ400E3	400	-	-	-	-	<b>21,10</b>	<b>31,65</b>
TCHG500E3	TCHQ500E3	500	-	-	-	-	<b>26,90</b>	<b>40,35</b>

### Acessórios

#### União Rápida

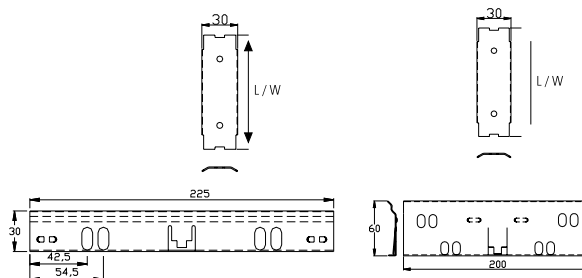
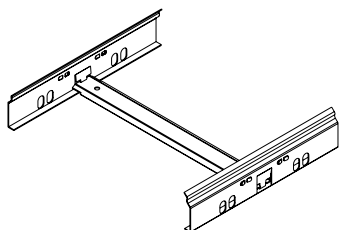

UNR

#### . ABA 30 .

Código		Largura L(mm)	Peso (Kg)	Volume (m3)	Euros €	
G	Q				G	Q
UNR10030G	UNR10030Q	100	0,152	0,00012	1,60	2,40
UNR15030G	UNR15030Q	150	0,162	0,00012	1,68	2,52
UNR20030G	UNR20030Q	200	0,170	0,00016	1,76	2,64
UNR25030G	UNR25030Q	250	0,180	0,00019	1,84	2,76
UNR30030G	UNR30030Q	300	0,190	0,00023	1,90	2,85
UNR40030G	UNR40030Q	400	0,218	0,00029	1,92	2,88

#### . ABA 60 .

Código		Largura L(mm)	Peso (Kg)	Volume (m3)	Euros €	
G	Q				G	Q
UNR10060G	UNR10060Q	100	0,220	0,00014	2,08	3,12
UNR15060G	UNR15060Q	150	0,235	0,00014	2,16	3,24
UNR20060G	UNR20060Q	200	0,240	0,00014	2,24	3,36
UNR25060G	UNR25060Q	250	0,255	0,00018	2,32	3,48
UNR30060G	UNR30060Q	300	0,260	0,00021	2,80	4,20
UNR40060G	UNR40060Q	400	0,300	0,00029	2,96	4,44
UNR50060G	UNR50060Q	500	0,310	0,00036	3,04	4,56
UNR60060G	UNR60060Q	600	0,345	0,00043	3,12	4,68

União rápida > 2 uniões e 1 travessão

#### União Simples

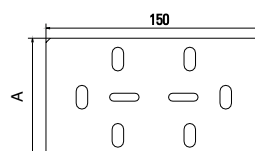
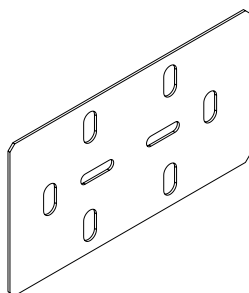

UNS

#### . ABA 100 .

Código		Altura A(mm)	Peso (Kg)	Volume (m3)	Euros €	
G	Q				G	Q
UNS000100G	UNS000100Q	82	0,500	0,00015	4,00	6,00

### Acessórios

#### Uniões Simples

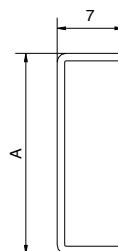
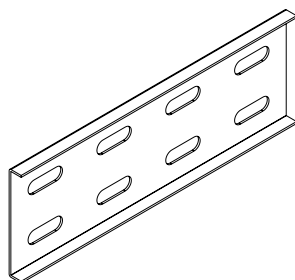

UNS

G/Q

#### . ABA 25 .

Código		Altura A(mm)	Peso (Kg)	Volume (m3)	Euros €	
G	Q				G	Q
UNS00025G	UNS00025Q	27	0,050	0,00004	1,50	2,25

#### . ABA 50 .

Código		Altura A(mm)	Peso (Kg)	Volume (m3)	Euros €	
G	Q				G	Q
UNS00050G	UNS00050Q	52	0,084	0,00008	1,90	2,85

#### . ABA 75 .

Código		Altura A(mm)	Peso (Kg)	Volume (m3)	Euros €	
G	Q				G	Q
UNS00075G	UNS00075Q	77	-	-	2,55	3,83

#### . ABA 100 .

Código		Altura A(mm)	Peso (Kg)	Volume (m3)	Euros €	
G	Q				G	Q
UNS00100G	UNS00100Q	102	-	-	3,15	4,73



## Acessórios

### Unões Articuladas

UNA

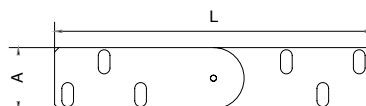
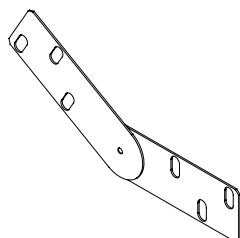

#### . ABA 25 .

G	Código		Medidas LxA(mm)	Peso (Kg)	Volume (m3)	Euros €	
	Q					G	Q
UNA02530G	UNA02530Q		14x206	0,046	0,00003	1,50	2,25

#### . ABA 30 .

G	Código		Medidas LxA(mm)	Peso (Kg)	Volume (m3)	Euros €	
	Q					G	Q
UNA02530G	UNA02530Q		14x206	0,046	0,00003	1,50	2,25

#### . ABA 50 .

G	Código		Medidas LxA(mm)	Peso (Kg)	Volume (m3)	Euros €	
	Q					G	Q
UNA05060G	UNA05060Q		42x218	0,102	0,00009	2,50	3,75

#### . ABA 60 .

G	Código		Medidas LxA(mm)	Peso (Kg)	Volume (m3)	Euros €	
	Q					G	Q
UNA05060G	UNA05060Q		42x218	0,102	0,00009	2,50	3,75

#### . ABA 75 .

G	Código		Medidas LxA(mm)	Peso (Kg)	Volume (m3)	Euros €	
	Q					G	Q
UNA00075G	UNA00075Q		60x240	-	-	4,50	6,75

#### . ABA 100 .

G	Código		Medidas LxA(mm)	Peso (Kg)	Volume (m3)	Euros €	
	Q					G	Q
UNA00100G	UNA00100Q		82x260	0,210	0,00021	5,50	8,25

## Acessórios

### Suporte Caixa Derivação

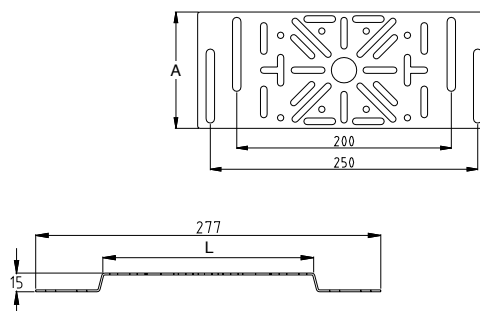
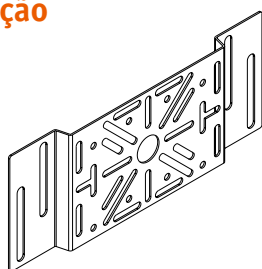

SFP

G/Q

G	Código		Medidas LxA(mm)	Peso (Kg)	Volume (m3)	Euros €	
		Q				G	Q
SFP170G		SFP170Q	170x110	7,385	0,00892	4,40	6,60

### Suporte Caixa Derivação

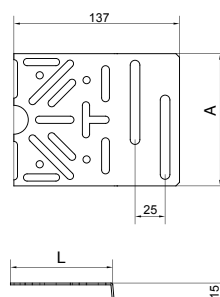
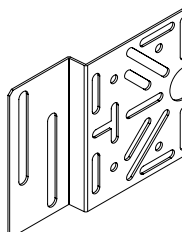

SFP

G	Código		Medidas LxA(mm)	Peso (Kg)	Volume (m3)	Euros €	
		Q				G	Q
SFP085G		SFP085Q	85x110	-	-	3,40	5,10

### Acessórios

### Curvas

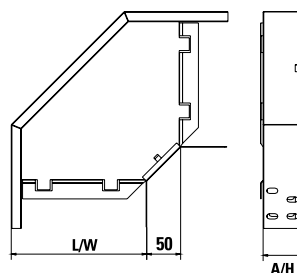
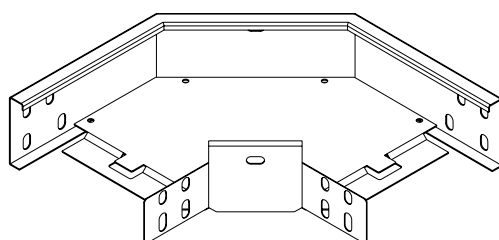

### CURV

#### . ABA 25 .

Código		Largura L(mm)	Peso (Kg)	Volume (m3)	Euros €	
G	Q				G	Q
CURV05025G	CURV05025Q	50	-	-	15,00	22,50
CURV07525G	CURV75025Q	75	-	-	16,00	24,00
CURV10025G	CURV10025Q	100	-	-	18,00	27,00
CURV15025G	CURV15025Q	150	-	-	20,00	30,00
CURV20025G	CURV20025Q	200	-	-	23,00	34,50

#### . ABA 30 .

Código		Largura L(mm)	Peso (Kg)	Volume (m3)	Euros €	
G	Q				G	Q
CURV10030G	CURV10030Q	100	0,365	0,00211	18,00	27,00
CURV15030G	CURV15030Q	150	0,540	0,00368	20,00	30,00
CURV20030G	CURV20030Q	200	0,694	0,00503	23,00	34,50
CURV25030G	CURV25030Q	250	0,998	0,00450	25,00	37,50
CURV30030G	CURV30030Q	300	1,134	0,00959	26,00	39,00
CURV40030G	CURV40030Q	400	1,900	0,00880	41,00	61,50

#### . ABA 50 .

Código		Largura L(mm)	Peso (Kg)	Volume (m3)	Euros €	
G	Q				G	Q
CURV05050G	CURV05050Q	50	-	-	15,90	23,85
CURV07550G	CURV75050Q	75	-	-	17,00	25,50
CURV10050G	CURV10050Q	100	-	-	18,50	27,75
CURV15050G	CURV15050Q	150	-	-	22,80	34,20
CURV20050G	CURV20050Q	200	-	-	24,60	36,80

#### . ABA 60 .

Código		Largura L(mm)	Peso (Kg)	Volume (m3)	Euros €	
G	Q				G	Q
CURV10060G	CURV10060Q	100	0,520	0,00361	18,50	27,75
CURV15060G	CURV15060Q	150	0,722	0,00632	22,80	34,20
CURV20060G	CURV20060Q	200	0,876	0,00892	24,60	36,90
CURV25060G	CURV25060Q	250	1,102	0,01191	25,50	38,25
CURV30060G	CURV30060Q	300	1,356	0,01590	26,50	39,75
CURV40060G	CURV40060Q	400	2,142	0,01710	45,00	67,50
CURV50060G	CURV50060Q	500	2,970	0,02420	50,00	75,00
CURV60060G	CURV60060Q	600	3,916	0,03260	61,00	91,50

As curvas incluem os parafusos, porcas e anilhas  
Curvas em Inox e lacada > Preço sob consulta

## Acessórios

### Curvas

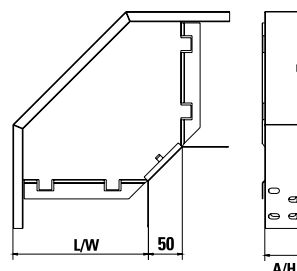
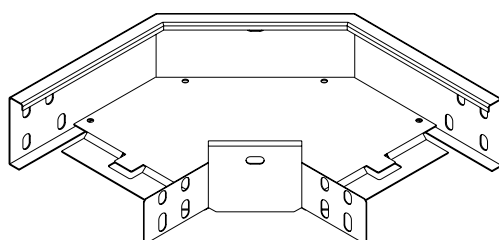

**CURV**

**G/Q**

#### . ABA 75 .

G	Código		Largura L(mm)	Peso (Kg)	Volume (m3)	Euros €	
		Q				G	Q
CURV07575G		CURV07575Q	75	-	-	21,00	31,50
CURV10075G		CURV10075Q	100	-	-	22,50	33,75
CURV15075G		CURV15075Q	150	-	-	25,50	38,25
CURV20075G		CURV20075Q	200	-	-	27,30	40,95

#### . ABA 100 .

G	Código		Largura L(mm)	Peso (Kg)	Volume (m3)	Euros €	
		Q				G	Q
CURV100100G		CURV100100Q	100	0,810	0,0050	24,00	36,00
CURV150100G		CURV150100Q	150	-	-	28,00	42,00
CURV200100G		CURV200100Q	200	1,228	0,0100	30,00	45,00
CURV300100G		CURV300100Q	300	1,770	0,0230	34,00	51,00
CURV400100G		CURV400100Q	400	2,456	0,0300	55,00	82,50
CURV500100G		CURV500100Q	500	3,250	0,0410	80,00	120,00

### Tampa para Curvas

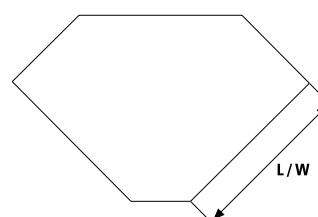
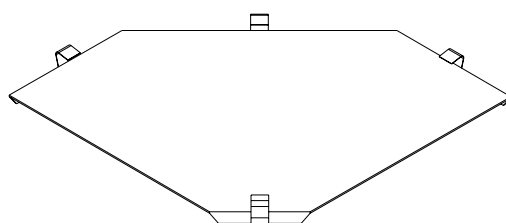

**TCURV**

G	Código		Largura L(mm)	Peso (Kg)	Volume (m3)	Euros €	
		Q				G	Q
TCURV050G		TCURV050Q	50	-	-	16,00	24,00
TCURV075G		TCURV075Q	75	-	-	19,00	28,50
TCURV100G		TCURV100Q	100	0,128	0,00017	21,00	31,50
TCURV150G		TCURV150Q	150	0,250	0,00038	22,80	34,20
TCURV200G		TCURV200Q	200	0,362	0,00057	24,60	36,90
TCURV250G		TCURV250Q	250	-	-	28,00	42,00
TCURV300G		TCURV300Q	300	0,704	0,00108	30,00	45,00
TCURV400G		TCURV400Q	400	1,138	0,00183	36,00	54,00
TCURV500G		TCURV500Q	500	-	-	44,50	66,75
TCURV600G		TCURV600Q	600	-	-	50,00	75,00

G > Pré-Galvanizado Q > Galvanizada por Imersão a Quente

As curvas incluem os parafusos, porcas e anilhas  
Curvas em Inox e lacada > Preço sob consulta

### Acessórios

### Curvas a 45°

### CUR45

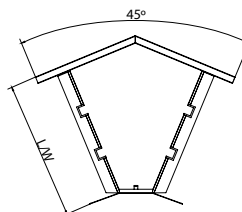
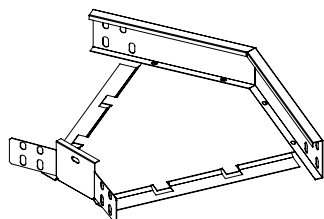

#### . ABA 25 .

Código		Largura L(mm)	Peso (Kg)	Volume (m3)	Euros €	
G	Q				G	Q
CUR4505025G	CUR4505025Q	50	-	-	15,00	22,50
CUR4507525G	CUR4507525Q	75	-	-	16,00	24,00
CUR4510025G	CUR4510025Q	100	-	-	18,00	27,00
CUR4515025G	CUR4515025Q	150	-	-	20,00	30,00
CUR4520025G	CUR4520025Q	200	-	-	23,00	34,50

#### . ABA 30 .

Código		Largura L(mm)	Peso (Kg)	Volume (m3)	Euros €	
G	Q				G	Q
CUR4510030G	CUR4510030Q	100	-	-	18,00	27,00
CUR4515030G	CUR4515030Q	150	-	-	20,00	30,00
CUR4520030G	CUR4520030Q	200	-	-	23,00	34,50
CUR4525030G	CUR4525030Q	250	-	-	25,00	37,50
CUR4530030G	CUR4530030Q	300	-	-	26,00	39,00
CUR4540030G	CUR4540030Q	400	-	-	41,00	61,50

#### . ABA 50 .

Código		Largura L(mm)	Peso (Kg)	Volume (m3)	Euros €	
G	Q				G	Q
CUR4505050G	CUR4505050Q	50	-	-	15,90	23,85
CUR4507550G	CUR4507550Q	75	-	-	17,00	25,50
CUR4510050G	CUR4510050Q	100	-	-	18,50	27,75
CUR4515050G	CUR4515050Q	150	-	-	22,80	34,20
CUR4520050G	CUR4520050Q	200	-	-	24,60	36,80

#### . ABA 60 .

Código		Largura L(mm)	Peso (Kg)	Volume (m3)	Euros €	
G	Q				G	Q
CUR4510060G	CUR4510060Q	100	-	-	18,50	27,75
CUR4515060G	CUR4515060Q	150	-	-	22,80	34,20
CUR4520060G	CUR4520060Q	200	-	-	24,60	36,90
CUR4525060G	CUR4525060Q	250	-	-	25,50	38,25
CUR4530060G	CUR4530060Q	300	0,917	0,01283	26,50	39,75
CUR4540060G	CUR4540060Q	400	-	-	45,00	67,50
CUR4550060G	CUR4550060Q	500	-	-	50,00	75,00
CUR4560060G	CUR4560060Q	600	-	-	61,00	91,50

As curvas incluem os parafusos, porcas e anilhas  
Curvas em Inox e lacada > Preço sob consulta

## Acessórios

### Curvas a 45°

### CUR45

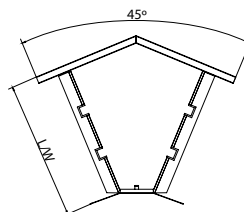
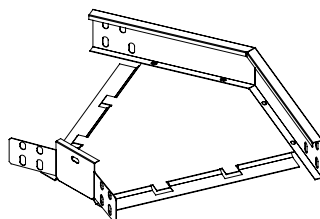

G/Q

#### . ABA 75 .

Código		Largura L (mm)	Peso (Kg)	Volume (m3)	Euros €	
G	Q				G	Q
CUR4507575G	CUR4507575Q	75	-	-	21,00	31,50
CUR4510075G	CUR4510075Q	100	-	-	22,50	33,75
CUR4515075G	CUR4515075Q	150	-	-	25,50	38,25
CUR4520075G	CUR4520075Q	200	-	-	27,30	40,95

#### . ABA 100 .

Código		Largura L (mm)	Peso (Kg)	Volume (m3)	Euros €	
G	Q				G	Q
CUR45100100G	CUR45100100Q	100	-	-	24,00	36,00
CUR45150100G	CUR45150100Q	150	-	-	28,00	42,00
CUR45200100G	CUR45200100Q	200	-	-	30,00	45,00
CUR45300100G	CUR45300100Q	300	-	-	34,00	51,00
CUR45400100G	CUR45400100Q	400	-	-	55,00	82,50
CUR45500100G	CUR45500100Q	500	-	-	80,00	120,00

### Tampa para Curvas a 45°

### TCUR45

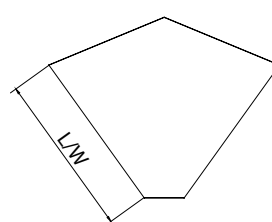
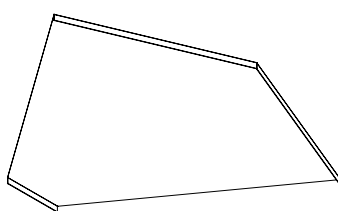

Código		Largura L (mm)	Peso (Kg)	Volume (m3)	Euros €	
G	Q				G	Q
TCUR45050G	TCUR45050Q	50	-	-	16,00	24,00
TCUR45075G	TCUR45075Q	75	-	-	19,00	28,50
TCUR45100G	TCUR45100Q	100	-	-	21,00	31,50
TCUR45150G	TCUR45150Q	150	-	-	22,80	34,20
TCUR45200G	TCUR45200Q	200	-	-	24,60	36,90
TCUR45250G	TCUR45250Q	250	-	-	28,00	42,00
TCUR45300G	TCUR45300Q	300	-	-	30,00	45,00
TCUR45400G	TCUR45400Q	400	-	-	36,00	54,00
TCUR45500G	TCUR45500Q	500	-	-	44,50	66,75
TCUR45600G	TCUR45600Q	600	-	-	50,00	75,00

G > Pré-Galvanizado Q > Galvanizada por Imersão a Quente

As curvas incluem os parafusos, porcas e anilhas  
Curvas em Inox e lacada > Preço sob consulta

### Acessórios

#### Cruzeta

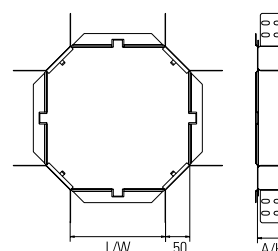
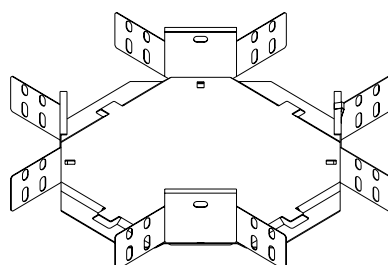

**CRZT**

#### . ABA 25 .

Código		Largura L(mm)	Peso (Kg)	Volume (m3)	Euros €	
G	Q				G	Q
CRZT05025G	CRZT05025Q	50	-	-	37,00	55,50
CRZT07525G	CRZT07525Q	75	-	-	38,00	57,00
CRZT10025G	CRZT10025Q	100	-	-	39,00	58,50
CRZT15025G	CRZT15025Q	150	-	-	41,00	61,50
CRZT20025G	CRZT20025Q	200	-	-	42,00	63,00

#### . ABA 30 .

Código		Largura L(mm)	Peso (Kg)	Volume (m3)	Euros €	
G	Q				G	Q
CRZT10030G	CRZT10030Q	100	0,528	0,00370	39,00	52,65
CRZT15030G	CRZT15030Q	150	0,784	0,00490	41,00	55,35
CRZT20030G	CRZT20030Q	200	0,942	0,00620	42,00	56,70
CRZT25030G	CRZT25030Q	250	1,322	0,00770	46,00	62,10
CRZT30030G	CRZT30030Q	300	1,660	0,00930	47,00	70,50
CRZT40030G	CRZT40030Q	400	2,450	0,01310	60,00	90,00

#### . ABA 50 .

Código		Largura L(mm)	Peso (Kg)	Volume (m3)	Euros €	
G	Q				G	Q
CRZT05050G	CRZT05050Q	50	-	-	36,50	54,75
CRZT07550G	CRZT07550Q	75	-	-	38,00	57,00
CRZT10050G	CRZT10050Q	100	-	-	40,00	60,00
CRZT15050G	CRZT15050Q	150	-	-	42,00	63,00
CRZT20050G	CRZT20050Q	200	-	-	44,00	66,00

#### . ABA 60 .

Código		Largura L(mm)	Peso (Kg)	Volume (m3)	Euros €	
G	Q				G	Q
CRZT10060G	CRZT10060Q	100	0,778	0,00720	40,00	54,00
CRZT15060G	CRZT15060Q	150	1,020	0,00940	42,00	56,70
CRZT20060G	CRZT20060Q	200	1,276	0,01200	44,00	59,40
CRZT25060G	CRZT25060Q	250	1,556	0,01490	47,00	63,45
CRZT30060G	CRZT30060Q	300	1,896	0,01810	50,00	67,50
CRZT40060G	CRZT40060Q	400	2,686	0,02540	66,00	99,00
CRZT50060G	CRZT50060Q	500	3,602	0,03400	84,00	126,00
CRZT60060G	CRZT60060Q	600	4,656	0,04370	96,00	144,00

As Cruzetas incluem os parafusos, porcas e anilhas  
Cruzeta em Inox e lacada > Preço sob consulta

### Acessórios

#### Cruzeta

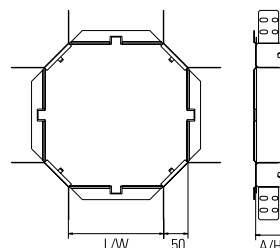
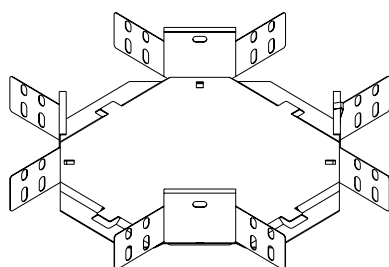

CRZT

G/Q

#### . ABA 75 .

Código		Largura L (mm)	Peso (Kg)	Volume (m3)	Euros €	
G	Q				G	Q
CRZT07575G	CRZT07575Q	75	-	-	45,50	68,25
CRZT10075G	CRZT10075Q	100	-	-	46,00	69,00
CRZT15075G	CRZT15075Q	150	-	-	47,00	70,50
CRZT20075G	CRZT20075Q	200	-	-	49,00	73,50

#### . ABA 100 .

Código		Largura L (mm)	Peso (Kg)	Volume (m3)	Euros €	
G	Q				G	Q
CRZT100100G	CRZT100100Q	100	1,242	0,0110	50,00	75,00
CRZT150100G	CRZT150100Q	150	-	-	53,00	79,50
CRZT200100G	CRZT200100Q	200	1,756	0,0185	55,00	82,50
CRZT300100G	CRZT300100Q	300	2,350	0,0280	60,00	78,00
CRZT400100G	CRZT400100Q	400	3,108	0,0475	80,00	120,00
CRZT500100G	CRZT500100Q	500	4,034	0,0670	90,00	135,00

#### Tampa para Cruzetas

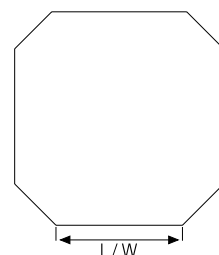
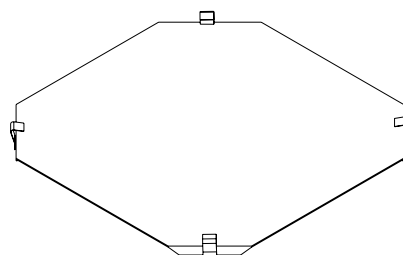

TCRZT

Código		Largura L (mm)	Peso (Kg)	Volume (m3)	Euros €	
G	Q				G	Q
TCRZT050G	TCRZT050Q	50	-	-	16,00	24,00
TCRZT075G	TCRZT075Q	75	-	-	19,00	28,50
TCRZT100G	TCRZT100Q	100	-	0,00034	21,00	31,50
TCRZT150G	TCRZT150Q	150	-	0,00053	22,80	34,20
TCRZT200G	TCRZT200Q	200	-	0,00077	24,60	36,90
TCRZT250G	TCRZT250Q	250	-	0,00104	28,00	42,00
TCRZT300G	TCRZT300Q	300	-	0,00136	30,00	45,00
TCRZT400G	TCRZT400Q	400	-	0,00213	36,00	54,00
TCRZT500G	TCRZT500Q	500	-	0,00306	44,50	66,75
TCRZT600G	TCRZT600Q	600	-	0,00417	50,00	75,00

G > Pré-Galvanizado Q > Galvanizada por Imersão a Quente

As Cruzetas incluem os parafusos, porcas e anilhas  
Cruzeta em Inox e lacada > Preço sob consulta



### Acessórios

#### Derivação "T"

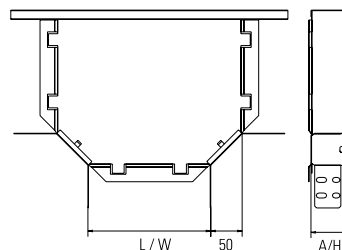
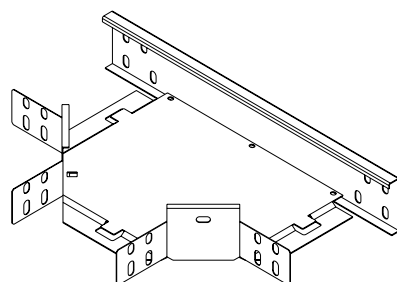

**DRVT**

#### . ABA 25 .

Código		Largura L(mm)	Peso (Kg)	Volume (m3)	Euros €	
G	Q				G	Q
DRVT05025G	DRVT05025Q	50	-	-	19,00	28,50
DRVT07525G	DRVT07525Q	75	-	-	20,00	30,00
DRVT10025G	DRVT10025Q	100	-	-	22,00	33,00
DRVT15025G	DRVT15025Q	150	-	-	27,00	40,50
DRVT20025G	DRVT20025Q	200	-	-	28,00	42,00

#### . ABA 30 .

Código		Largura L(mm)	Peso (Kg)	Volume (m3)	Euros €	
G	Q				G	Q
DRVT10030G	DRVT10030Q	100	0,502	0,00334	22,00	33,00
DRVT15030G	DRVT15030Q	150	0,690	0,00473	27,00	40,50
DRVT20030G	DRVT20030Q	200	0,918	0,00622	28,00	42,00
DRVT25030G	DRVT25030Q	250	1,286	0,00590	30,00	45,00
DRVT30030G	DRVT30030Q	300	1,454	0,00996	32,00	48,00
DRVT40030G	DRVT40030Q	400	2,376	0,01080	45,00	67,50

#### . ABA 50 .

Código		Largura L(mm)	Peso (Kg)	Volume (m3)	Euros €	
G	Q				G	Q
DRVT05050G	DRVT05050Q	50	-	-	20,00	30,00
DRVT07550G	DRVT07550Q	75	-	-	21,00	31,50
DRVT10050G	DRVT10050Q	100	-	-	22,80	34,20
DRVT15050G	DRVT15050Q	150	-	-	27,50	41,25
DRVT20050G	DRVT20050Q	200	-	-	28,50	42,75

#### . ABA 60 .

Código		Largura L(mm)	Peso (Kg)	Volume (m3)	Euros €	
G	Q				G	Q
DRVT10060G	DRVT10060Q	100	0,708	0,00567	22,80	34,20
DRVT15060G	DRVT15060Q	150	0,952	0,00670	27,50	41,25
DRVT20060G	DRVT20060Q	200	1,216	0,00890	28,50	42,75
DRVT25060G	DRVT25060Q	250	1,486	0,01150	30,50	45,75
DRVT30060G	DRVT30060Q	300	1,742	0,01691	33,00	49,50
DRVT40060G	DRVT40060Q	400	2,608	0,02100	50,00	75,00
DRVT50060G	DRVT50060Q	500	3,534	0,02880	60,00	90,00
DRVT60060G	DRVT60060Q	600	4,180	0,03790	70,00	105,00

As derivações "T" incluem os parafusos, porcas e anilhas  
Derivação em Inox e lacada > Preço sob consulta

### Acessórios

#### Derivação "T"

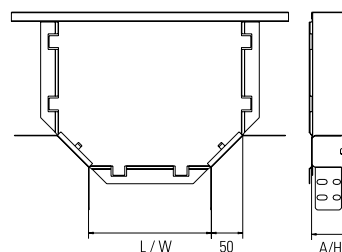
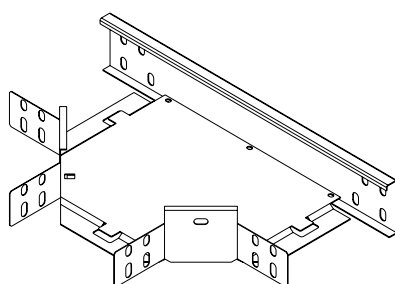

DRVT

G/Q

#### . ABA 75 .

Código		Largura L (mm)	Peso (Kg)	Volume (m3)	Euros €	
G	Q				G	Q
DRVT07575G	DRVT07575Q	75	-	-	25,00	37,50
DRVT10075G	DRVT10075Q	100	-	-	26,50	39,75
DRVT15075G	DRVT15075Q	150	-	-	29,00	43,50
DRVT20075G	DRVT20075Q	200	-	-	31,00	46,50

#### . ABA 100 .

Código		Largura L (mm)	Peso (Kg)	Volume (m3)	Euros €	
G	Q				G	Q
DRVT100100G	DRVT100100Q	100	1,092	0,00750	30,00	45,00
DRVT150100G	DRVT150100Q	150	-	-	31,50	47,25
DRVT200100G	DRVT200100Q	200	1,566	0,01350	33,00	49,50
DRVT300100G	DRVT300100Q	300	2,178	0,02170	43,00	64,50
DRVT400100G	DRVT400100Q	400	2,942	0,03180	73,00	109,50
DRVT500100G	DRVT500100Q	500	3,860	0,04200	83,00	124,50

#### Tampa para Derivação "T"

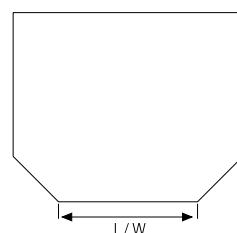
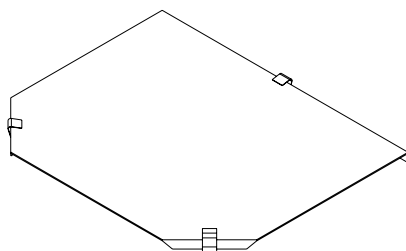

TDRVT

Código		Largura L (mm)	Peso (Kg)	Volume (m3)	Euros €	
G	Q				G	Q
TDRVT050G	TDRVT050Q	50	-	-	16,00	24,00
TDRVT075G	TDRVT075Q	75	-	-	19,00	28,50
TDRVT100G	TDRVT100Q	100	0,218	-	21,00	31,50
TDRVT150G	TDRVT150Q	150	0,350	-	22,80	34,20
TDRVT200G	TDRVT200Q	200	0,626	0,00064	24,60	36,90
TDRVT250G	TDRVT250Q	250	0,766	-	28,00	42,00
TDRVT300G	TDRVT300Q	300	1,158	0,00119	30,00	45,00
TDRVT400G	TDRVT400Q	400	1,827	0,00191	36,00	54,00
TDRVT500G	TDRVT500Q	500	2,496	0,00281	44,50	66,75
TDRVT600G	TDRVT600Q	600	3,161	0,00387	50,00	75,00

As derivações "T" incluem os parafusos, porcas e anilhas  
Derivação em Inox e lacada > Preço sob consulta

G > Pré-Galvanizado Q > Galvanizada por Imersão a Quente

Tabela de Preços | Caminho de Cabos | 2010

### Acessórios

### Derivação Lateral

**DRVL**

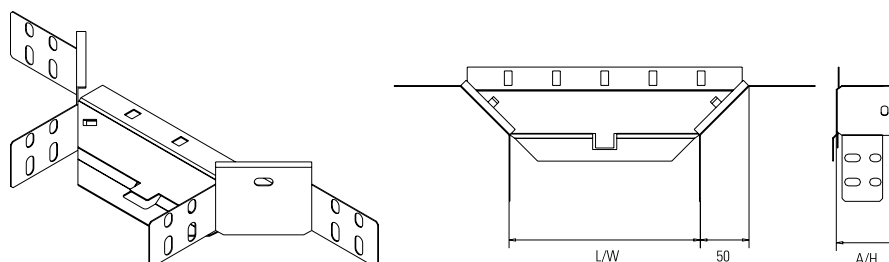

#### . ABA 25 .

Código		Largura L(mm)	Peso (Kg)	Volume (m3)	Euros €	
G	Q				G	Q
DRVL05025G	DRVL05025Q	50	-	-	15,00	28,50
DRVL07525G	DRVL07525Q	75	-	-	16,00	30,00
DRVL10025G	DRVL10025Q	100	-	-	18,00	33,00
DRVL15025G	DRVL15025Q	150	-	-	20,00	40,50
DRVL20025G	DRVL20025Q	200	-	-	23,00	42,00

#### . ABA 30 .

Código		Largura L(mm)	Peso (Kg)	Volume (m3)	Euros €	
G	Q				G	Q
DRVL10030G	DRVL10030Q	100	0,224	0,00150	22,00	27,00
DRVL15030G	DRVL15030Q	150	0,256	0,00170	27,00	30,00
DRVL20030G	DRVL20030Q	200	0,306	0,00200	28,00	34,50
DRVL25030G	DRVL25030Q	250	0,344	0,00220	30,00	37,50
DRVL30030G	DRVL30030Q	300	0,378	0,00240	32,00	39,00
DRVL40030G	DRVL40030Q	400	0,494	0,00280	45,00	61,50

#### . ABA 50 .

Código		Largura L(mm)	Peso (Kg)	Volume (m3)	Euros €	
G	Q				G	Q
DRVL05050G	DRVL05050Q	50	-	-	15,90	30,00
DRVL07550G	DRVL07550Q	75	-	-	17,00	31,50
DRVL10050G	DRVL10050Q	100	-	-	18,50	34,20
DRVL15050G	DRVL15050Q	150	-	-	22,80	41,25
DRVL20050G	DRVL20050Q	200	-	-	24,60	42,75

#### . ABA 60 .

Código		Largura L(mm)	Peso (Kg)	Volume (m3)	Euros €	
G	Q				G	Q
DRVL10060G	DRVL10060Q	100	0,326	0,00350	22,80	27,75
DRVL15060G	DRVL15060Q	150	0,362	0,00405	27,50	34,20
DRVL20060G	DRVL20060Q	200	0,422	-	28,50	36,90
DRVL25060G	DRVL25060Q	250	0,460	-	30,50	38,25
DRVL30060G	DRVL30060Q	300	0,482	0,00572	33,00	39,75
DRVL40060G	DRVL40060Q	400	0,580	-	50,00	67,50
DRVL50060G	DRVL50060Q	500	0,656	-	60,00	75,00
DRVL60060G	DRVL60060Q	600	0,730	-	70,00	91,50

As derivações laterais incluem os parafusos, porcas e anilhas  
Derivação Lateral em Inox e lacada > Preço sob consulta

## Acessórios

### Derivação Lateral

DRV L

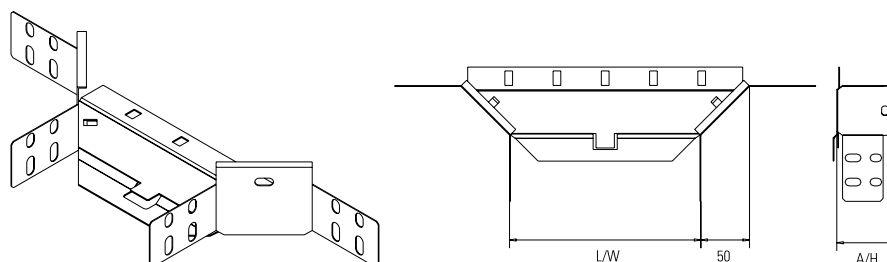

G/Q

#### . ABA 75 .

Código		Largura L (mm)	Peso (Kg)	Volume (m3)	Euros €	
G	Q				G	Q
DRV L07575G	DRV L07575Q	75	-	-	21,00	37,50
DRV L10075G	DRV L10075Q	100	-	-	22,50	39,75
DRV L15075G	DRV L15075Q	150	-	-	25,50	43,50
DRV L20075G	DRV L20075Q	200	-	-	27,30	46,50

#### . ABA 100 .

Código		Largura L (mm)	Peso (Kg)	Volume (m3)	Euros €	
G	Q				G	Q
DRV L100100G	DRV L100100Q	100	0,570	0,0045	30,00	42,00
DRV L150100G	DRV L150100Q	150	-	-	32,00	47,25
DRV L200100G	DRV L200100Q	200	0,638	0,0060	33,00	49,50
DRV L300100G	DRV L300100Q	300	0,734	0,0085	43,00	51,00
DRV L400100G	DRV L400100Q	400	0,806	0,0100	73,00	82,50
DRV L500100G	DRV L500100Q	500	0,874	0,0115	83,00	120,00

### Tampa para Derivação Lateral

TDRVL

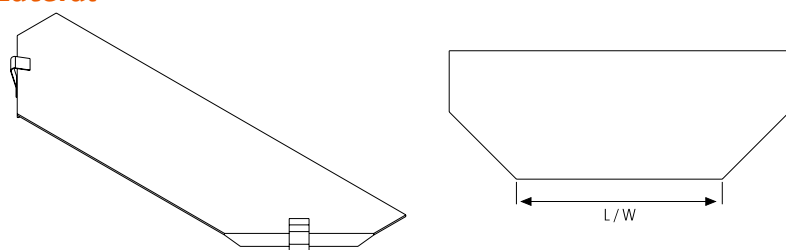

Código		Largura L (mm)	Peso (Kg)	Volume (m3)	Euros €	
G	Q				G	Q
TDRVL050G	TDRVL050Q	50	-	-	16,00	24,00
TDRVL075G	TDRVL075Q	75	-	-	19,00	28,50
TDRVL100G	TDRVL100Q	100	0,066	0,00009	21,00	31,50
TDRVL150G	TDRVL150Q	150	-	-	22,80	34,20
TDRVL200G	TDRVL200Q	200	0,112	0,00014	24,60	36,90
TDRVL250G	TDRVL250Q	250	-	0,00018	28,00	42,00
TDRVL300G	TDRVL300Q	300	0,144	0,00019	30,00	45,00
TDRVL400G	TDRVL400Q	400	-	0,00026	36,00	54,00
TDRVL500G	TDRVL500Q	500	-	0,00031	44,50	66,75
TDRVL600G	TDRVL600Q	600	-	0,00036	50,00	75,00

G > Pré-Galvanizado Q > Galvanizada por Imersão a Quente

As derivações laterais incluem os parafusos, porcas e anilhas  
Derivação Lateral em Inox e lacada > Preço sob consulta

## Acessórios

### Ângulo subida-descida

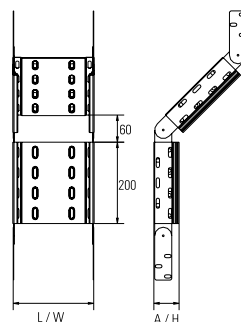
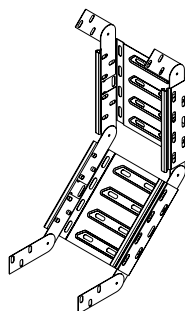

**ANGS**

#### . ABA 25 .

Código		Largura L(mm)	Peso (Kg)	Volume (m3)	Euros €	
G	Q				G	Q
ANGS05025G	ANGS05025Q	50	-	-	27,00	40,50
ANGS07525G	ANGS07525Q	75	-	-	28,00	42,00
ANGS10025G	ANGS10025Q	100	-	-	29,00	43,50
ANGS15025G	ANGS15025Q	150	-	-	29,40	44,10
ANGS20025G	ANGS20025Q	200	-	-	30,35	45,53

#### . ABA 30 .

Código		Largura L(mm)	Peso (Kg)	Volume (m3)	Euros €	
G	Q				G	Q
ANGS10030G	ANGS10030Q	100	0,738	0,00296	29,00	43,00
ANGS15030G	ANGS15030Q	150	0,740	0,00423	29,40	44,10
ANGS20030G	ANGS20030Q	200	0,866	0,00410	30,35	45,55
ANGS25030G	ANGS25030Q	250	0,960	0,00510	31,40	47,10
ANGS30030G	ANGS30030Q	300	1,166	0,00620	40,15	60,25
ANGS40030G	ANGS40030Q	400	1,562	0,00820	45,65	68,50

#### . ABA 50 .

Código		Largura L(mm)	Peso (Kg)	Volume (m3)	Euros €	
G	Q				G	Q
ANGS05050G	ANGS05050Q	50	-	-	37,00	55,50
ANGS07550G	ANGS07550Q	75	-	-	38,00	57,00
ANGS10050G	ANGS10050Q	100	-	-	40,80	61,20
ANGS15050G	ANGS15050Q	150	-	-	42,60	63,90
ANGS20050G	ANGS20050Q	200	-	-	44,40	66,60

#### . ABA 60 .

Código		Largura L(mm)	Peso (Kg)	Volume (m3)	Euros €	
G	Q				G	Q
ANGS10060G	ANGS10060Q	100	1,254	0,00551	40,80	61,20
ANGS15060G	ANGS15060Q	150	1,224	0,00600	42,60	63,90
ANGS20060G	ANGS20060Q	200	1,316	0,00790	44,40	66,60
ANGS25060G	ANGS25060Q	250	1,406	0,01214	46,20	69,30
ANGS30060G	ANGS30060Q	300	1,506	0,01190	48,00	72,00
ANGS40060G	ANGS40060Q	400	2,182	0,01390	52,80	79,20
ANGS50060G	ANGS50060Q	500	2,355	0,01990	66,00	99,00
ANGS60060G	ANGS60060Q	600	2,658	0,02380	72,00	108,00

Kit: 2 elementos c/ uniões artic. rebitados, parafusos, porcas e anilhas  
Ângulo em Inox e lacado > Preço sob consulta

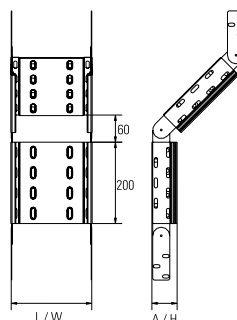
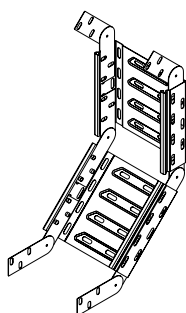
**Acessórios**
**Ângulo subida-descida**

**ANGS**
**G/Q**
**. ABA 75 .**

Código		Largura L(mm)	Peso (Kg)	Volume (m3)	Euros €	
G	Q				G	Q
ANGS07575G	ANGS07575Q	75	-	-	<b>49,40</b>	<b>74,10</b>
ANGS10075G	ANGS10075Q	100	-	-	<b>53,04</b>	<b>79,56</b>
ANGS15075G	ANGS15075Q	150	-	-	<b>55,38</b>	<b>83,07</b>
ANGS20075G	ANGS20075Q	200	-	-	<b>57,72</b>	<b>86,58</b>

**. ABA 100 .**

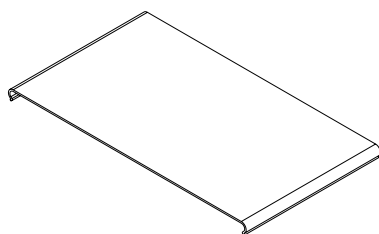
Código		Largura L(mm)	Peso (Kg)	Volume (m3)	Euros €	
G	Q				G	Q
ANGS100100G	ANGS100100Q	100	2,332	0,0070	<b>63,00</b>	<b>94,50</b>
ANGS150100G	ANGS150100Q	150	-	-	<b>65,00</b>	<b>97,50</b>
ANGS200100G	ANGS200100Q	200	2,560	0,0150	<b>66,00</b>	<b>99,00</b>
ANGS300100G	ANGS300100Q	300	2,732	0,0185	<b>75,00</b>	<b>112,50</b>
ANGS400100G	ANGS400100Q	400	3,094	0,0225	<b>84,00</b>	<b>126,00</b>
ANGS500100G	ANGS500100Q	500	3,654	0,0300	<b>96,00</b>	<b>144,00</b>

**Tampa para ângulo subida-descida**
**TANGS**

Código		Largura L(mm)	Peso (Kg)	Volume (m3)	Euros €	
G	Q				G	Q
TANGS050G	TANGS050Q	50	-	-	<b>18,30</b>	<b>27,45</b>
TANGS075G	TANGS075Q	75	-	-	<b>20,10</b>	<b>30,15</b>
TANGS100G	TANGS100Q	100	0,194	0,00215	<b>21,00</b>	<b>31,50</b>
TANGS150G	TANGS150Q	150	-	-	<b>22,80</b>	<b>34,20</b>
TANGS200G	TANGS200Q	200	0,626	0,00431	<b>24,60</b>	<b>36,90</b>
TANGS250G	TANGS250Q	250	-	-	<b>27,00</b>	<b>40,50</b>
TANGS300G	TANGS300Q	300	-	-	<b>30,00</b>	<b>45,00</b>
TANGS400G	TANGS400Q	400	-	-	<b>36,00</b>	<b>54,00</b>
TANGS500G	TANGS500Q	500	-	-	<b>44,80</b>	<b>67,20</b>
TANGS600G	TANGS600Q	600	-	-	<b>54,60</b>	<b>81,90</b>

 Kit: 2 elementos c/ uniões artic. rebitados, parafusos, porcas e anilhas  
 Ângulo em Inox e lacado > Preço sob consulta

G &gt; Pré-Galvanizado    Q &gt; Galvanizada por Imersão a Quente

Tabela de Preços | Caminho de Cabos | 2010

## Acessórios

### Curva ângulo de subida

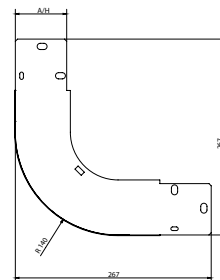
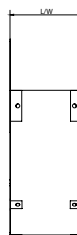
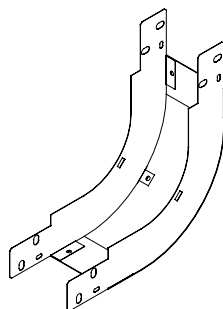

CAS

#### . ABA 25 .

Código		Largura L(mm)	Peso (Kg)	Volume (m3)	Euros €	
G	Q				G	Q
CAS05025G	CAS05025Q	50	-	-	19,00	39,75
CAS07525G	CAS07525Q	75	-	-	19,50	42,00
CAS10025G	CAS10025Q	100	-	-	20,50	43,50
CAS15025G	CAS15025Q	150	-	-	21,25	44,10
CAS20025G	CAS20025Q	200	-	-	22,00	45,53

#### . ABA 30 .

Código		Largura L(mm)	Peso (Kg)	Volume (m3)	Euros €	
G	Q				G	Q
CAS10030G	CAS10030Q	100	0,452	0,00346	29,00	43,50
CAS15030G	CAS15030Q	150	-	-	29,40	44,10
CAS20030G	CAS20030Q	200	-	-	30,35	45,53
CAS25030G	CAS25030Q	250	-	-	45,00	67,50
CAS30030G	CAS30030Q	300	-	-	48,00	72,00
CAS40030G	CAS40030Q	400	-	-	45,65	68,48

#### . ABA 50 .

Código		Largura L(mm)	Peso (Kg)	Volume (m3)	Euros €	
G	Q				G	Q
CAS05050G	CAS05050Q	50	-	-	20,00	56,25
CAS07550G	CAS07550Q	75	-	-	21,30	58,50
CAS10050G	CAS10050Q	100	-	-	22,45	61,20
CAS15050G	CAS15050Q	150	-	-	23,20	63,90
CAS20050G	CAS20050Q	200	-	-	24,00	66,60

#### . ABA 60 .

Código		Largura L(mm)	Peso (Kg)	Volume (m3)	Euros €	
G	Q				G	Q
CAS10060G	CAS10060Q	100	-	-	40,80	61,20
CAS15060G	CAS15060Q	150	-	-	42,60	63,90
CAS20060G	CAS20060Q	200	0,868	0,00686	44,40	66,60
CAS25060G	CAS25060Q	250	-	-	46,00	69,00
CAS30060G	CAS30060Q	300	-	-	48,00	72,00
CAS40060G	CAS40060Q	400	1,368	0,01432	52,80	79,20
CAS50060G	CAS50060Q	500	-	-	66,00	99,00
CAS60060G	CAS60060Q	600	-	-	68,00	102,00

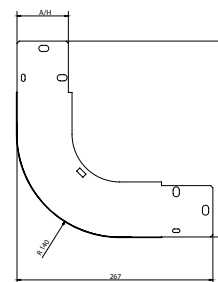
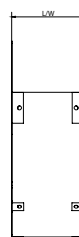
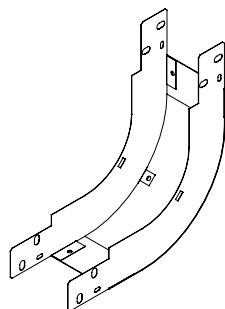
**Acessórios**
**Curva ângulo de subida**

**CAS**
**G/Q**
**. ABA 75 .**

Código		Largura L (mm)	Peso (Kg)	Volume (m3)	Euros €	
G	Q				G	Q
CAS07575G	CAS07575Q	75	-	-	50,00	75,00
CAS10075G	CAS10075Q	100	-	-	52,00	78,00
CAS15075G	CAS15075Q	150	-	-	54,00	81,00
CAS20075G	CAS20075Q	200	-	-	55,50	83,25

**. ABA 100 .**

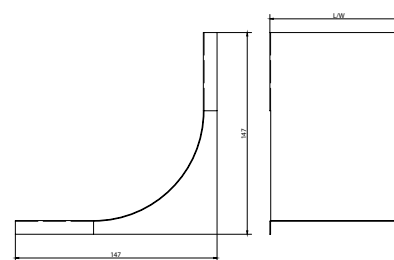
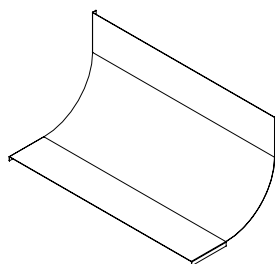
Código		Largura L (mm)	Peso (Kg)	Volume (m3)	Euros €	
G	Q				G	Q
CAS100100G	CAS100100Q	100	-	-	63,00	94,50
CAS150100G	CAS150100Q	150	-	-	64,50	96,75
CAS200100G	CAS200100Q	200	-	-	66,00	99,00
CAS300100G	CAS300100Q	300	-	-	75,00	112,50
CAS400100G	CAS400100Q	400	-	-	84,00	126,00
CAS500100G	CAS500100Q	500	-	-	96,00	144,00

**Tampa para curva ângulo de subida**

**TCAS**

Código		Largura L (mm)	Peso (Kg)	Volume (m3)	Euros €	
G	Q				G	Q
TCAS050G	TCAS050Q	50	-	-	16,00	24,00
TCAS075G	TCAS075Q	75	-	-	19,00	28,50
TCAS100G	TCAS100Q	100	-	-	21,00	31,50
TCAS150G	TCAS150Q	150	-	-	22,80	34,20
TCAS200G	TCAS200Q	200	-	-	24,60	36,90
TCAS250G	TCAS250Q	250	-	-	26,00	39,00
TCAS300G	TCAS300Q	300	-	-	30,00	45,00
TCAS400G	TCAS400Q	400	-	-	36,00	54,00
TCAS500G	TCAS500Q	500	-	-	44,50	66,75
TCAS600G	TCAS600Q	600	-	-	48,00	72,00

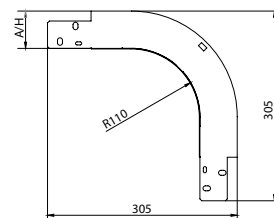
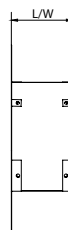
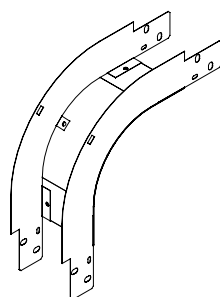

### Acessórios

### Curva ângulo de descida



CAD

#### . ABA 25 .

Código		Largura L(mm)	Peso (Kg)	Volume (m3)	Euros €	
G	Q				G	Q
CAD05025G	CAD05025Q	50	-	-	26,50	39,75
CAD07525G	CAD07525Q	75	-	-	28,00	42,00
CAD10025G	CAD10025Q	100	-	-	29,00	43,50
CAD15025G	CAD15025Q	150	-	-	29,40	44,10
CAD20025G	CAD20025Q	200	-	-	30,35	45,53

#### . ABA 30 .

Código		Largura L(mm)	Peso (Kg)	Volume (m3)	Euros €	
G	Q				G	Q
CAD10030G	CAD10030Q	100	-	-	29,00	43,50
CAD15030G	CAD15030Q	150	-	-	29,40	44,10
CAD20030G	CAD20030Q	200	0,638	0,00745	30,35	45,53
CAD25030G	CAD25030Q	250	-	-	45,00	67,50
CAD30030G	CAD30030Q	300	-	-	40,15	60,23
CAD40030G	CAD40030Q	400	-	-	45,65	68,48

#### . ABA 50 .

Código		Largura L(mm)	Peso (Kg)	Volume (m3)	Euros €	
G	Q				G	Q
CAD05050G	CAD05050Q	50	-	-	37,50	56,25
CAD07550G	CAD07550Q	75	-	-	39,00	58,50
CAD10050G	CAD10050Q	100	-	-	40,80	61,20
CAD15050G	CAD15050Q	150	-	-	42,60	63,90
CAD20050G	CAD20050Q	200	-	-	44,40	66,60

#### . ABA 60 .

Código		Largura L(mm)	Peso (Kg)	Volume (m3)	Euros €	
G	Q				G	Q
CAD10060G	CAD10060Q	100	0,676	0,00465	40,80	61,20
CAD15060G	CAD15060Q	150	-	-	42,60	63,90
CAD20060G	CAD20060Q	200	0,898	0,00924	44,40	66,60
CAD25060G	CAD25060Q	250	-	-	46,00	69,00
CAD30060G	CAD30060Q	300	1,102	0,01395	48,00	72,00
CAD40060G	CAD40060Q	400	1,300	0,01910	52,80	79,20
CAD50060G	CAD50060Q	500	1,546	0,02326	66,00	99,00
CAD60060G	CAD60060Q	600	-	-	68,00	102,00

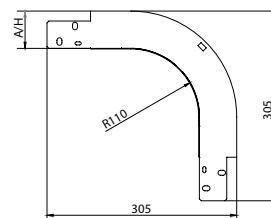
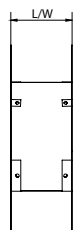
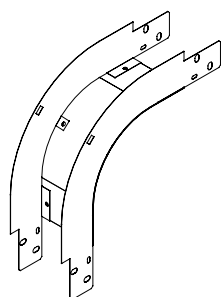
**Acessórios**
**Curva ângulo de descida**

**CAD**
**G/Q**
**. ABA 75 .**

Código		Largura L(mm)	Peso (Kg)	Volume (m3)	Euros €	
G	Q				G	Q
CAD07575G	CAD07575Q	75	-	-	50,00	75,00
CAD10075G	CAD10075Q	100	-	-	52,00	78,00
CAD15075G	CAD15075Q	150	-	-	54,00	81,00
CAD20075G	CAD20075Q	200	-	-	55,50	83,25

**. ABA 100 .**

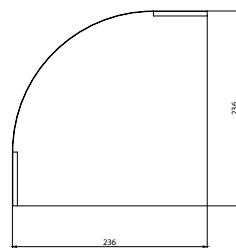
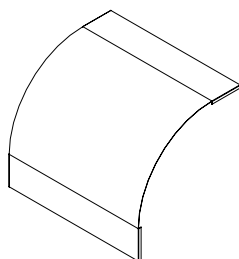
Código		Largura L(mm)	Peso (Kg)	Volume (m3)	Euros €	
G	Q				G	Q
CAD100100G	CAD100100Q	100	-	-	63,00	94,50
CAD150100G	CAD150100Q	150	-	-	64,50	96,75
CAD200100G	CAD200100Q	200	-	-	66,00	99,00
CAD300100G	CAD300100Q	300	-	-	75,00	112,50
CAD400100G	CAD400100Q	400	-	-	84,00	126,00
CAD500100G	CAD500100Q	500	-	-	96,00	144,00

**Tampa para curva ângulo de descida**

**TCAD**

Código		Largura L(mm)	Peso (Kg)	Volume (m3)	Euros €	
G	Q				G	Q
TCAD050G	TCAD050Q	50	-	-	16,00	24,00
TCAD075G	TCAD075Q	75	-	-	19,00	28,50
TCAD100G	TCAD100Q	100	-	-	21,00	31,50
TCAD150G	TCAD150Q	150	-	-	22,80	34,20
TCAD200G	TCAD200Q	200	-	-	24,60	36,90
TCAD250G	TCAD250Q	250	-	-	26,00	39,00
TCAD300G	TCAD300Q	300	-	-	30,00	45,00
TCAD400G	TCAD400Q	400	-	-	36,00	54,00
TCAD500G	TCAD500Q	500	-	-	44,50	66,75
TCAD600G	TCAD600Q	600	-	-	48,00	72,00

## Acessórios

### Redução simples

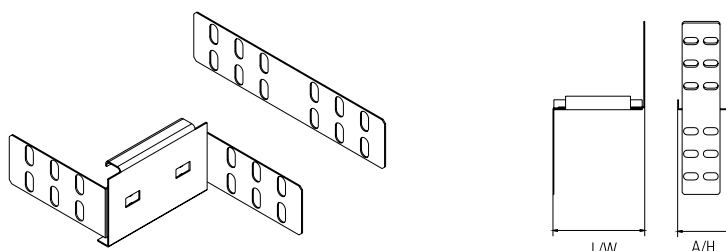
RE



#### . ABA 25 .

Código		Largura L(mm)	Peso (Kg)	Volume (m3)	Euros €	
G	Q				G	Q
RE02525G	RE02525Q	25	-	-	8,40	12,60
RE05025G	RE05025Q	50	-	-	8,50	12,75
RE07525G	RE07525Q	75	-	-	8,60	12,90
RE10025G	RE10025Q	100	-	-	8,70	13,05
RE12525G	RE12525Q	125	-	-	8,80	13,20
RE15025G	RE15025Q	150	-	-	8,90	13,35

#### . ABA 30 .

Código		Largura L(mm)	Peso (Kg)	Volume (m3)	Euros €	
G	Q				G	Q
RE05030G	RE05030Q	50	0,086	-	6,70	10,05
RE10030G	RE10030Q	100	0,142	-	6,80	12,20
RE15030G	RE15030Q	150	0,160	-	8,90	13,35
RE20030G	RE20030Q	200	0,180	-	10,30	15,45
RE25030G	RE25030Q	250	0,200	-	11,50	17,25
RE30030G	RE30030Q	300	0,220	-	13,50	20,25

#### . ABA 50 .

Código		Largura L(mm)	Peso (Kg)	Volume (m3)	Euros €	
G	Q				G	Q
RE02550G	RE02550Q	25	-	-	10,00	15,00
RE05050G	RE05050Q	50	-	-	10,50	15,75
RE07550G	RE07550Q	75	-	-	11,00	16,50
RE10050G	RE10050Q	100	-	-	11,50	17,25
RE12550G	RE12550Q	125	-	-	11,70	17,55
RE15050G	RE15050Q	150	-	-	11,90	17,85

## Acessórios

### Redução simples

RE

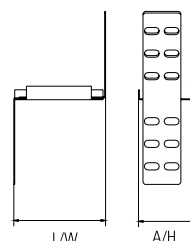
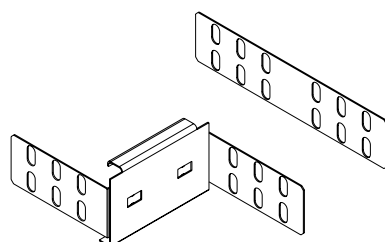

G/Q

#### . ABA 60 .

Código		Largura L (mm)	Peso (Kg)	Volume (m3)	Euros €	
G	Q				G	Q
RE05060G	RE05060Q	50	0,218	-	9,10	13,65
RE10060G	RE10060Q	100	0,262	-	10,30	15,45
RE15060G	RE15060Q	150	0,294	-	11,90	17,85
RE20060G	RE20060Q	200	0,330	-	12,25	18,38
RE25060G	RE25060Q	250	0,366	-	14,10	21,15
RE30060G	RE30060Q	300	0,402	-	16,00	24,00
RE35060G	RE35060Q	350	0,438	-	16,40	24,60
RE40060G	RE40060Q	400	0,474	-	16,80	25,20
RE45060G	RE45060Q	450	0,490	-	18,90	28,35
RE50060G	RE50060Q	500	0,548	-	20,20	30,00

#### . ABA 75 .

Código		Largura L (mm)	Peso (Kg)	Volume (m3)	Euros €	
G	Q				G	Q
RE02575G	RE02575Q	25	-	-	17,00	25,50
RE05075G	RE05075Q	50	-	-	17,50	26,25
RE07575G	RE07575Q	75	-	-	18,00	27,00
RE10075G	RE10075Q	100	-	-	18,50	27,75
RE12575G	RE12575Q	125	-	-	19,00	28,50

#### . ABA 100 .

Código		Largura L (mm)	Peso (Kg)	Volume (m3)	Euros €	
G	Q				G	Q
RE050100G	RE050100Q	50	-	-	20,10	-
RE100100G	RE100100Q	100	-	-	26,00	39,00
RE200100G	RE200100Q	200	-	-	28,00	42,00
RE300100G	RE300100Q	300	-	-	32,00	48,00
RE400100G	RE400100Q	400	-	-	36,00	54,00

### Acessórios

#### Redução direita

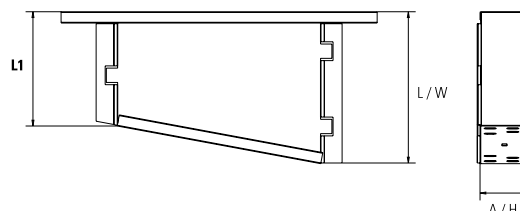
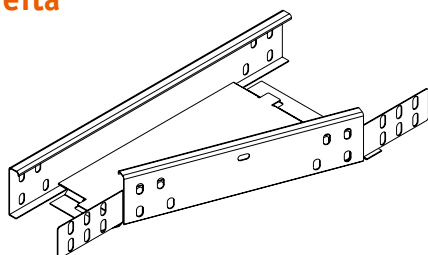

**RED**

#### . ABA 25 .

Código		Largura L(mm)	Peso (Kg)	Volume (m3)	Euros €	
G	Q				G	Q
RED075L125G	RED075L125Q	75	-	-	48,00	72,00
RED100L125G	RED100L125Q	100	-	-	50,00	75,00
RED150L125G	RED150L125Q	150	-	-	53,00	79,50
RED200L125G	RED200L125Q	200	-	-	57,00	85,50

#### . ABA 30 .

Código		Largura L(mm)	Peso (Kg)	Volume (m3)	Euros €	
G	Q				G	Q
RED150L130G	RED150L130Q	150	-	-	53,00	79,50
RED200L130G	RED200L130Q	200	-	-	57,00	85,50
RED250L130G	RED250L130Q	250	-	-	63,00	94,50
RED300L130G	RED300L130Q	300	-	-	75,00	112,50
RED400L130G	RED400L130Q	400	-	-	86,00	129,00

#### . ABA 50 .

Código		Largura L(mm)	Peso (Kg)	Volume (m3)	Euros €	
G	Q				G	Q
RED075L150G	RED075L150Q	75	-	-	48,00	72,00
RED100L150G	RED100L150Q	100	-	-	50,00	75,00
RED150L150G	RED150L150Q	150	-	-	55,00	82,50
RED200L150G	RED200L150Q	200	-	-	60,00	90,00

#### . ABA 60 .

Código		Largura L(mm)	Peso (Kg)	Volume (m3)	Euros €	
G	Q				G	Q
RED150L160G	RED150L160Q	150	-	-	55,00	82,50
RED200L160G	RED200L160Q	200	-	-	60,00	90,00
RED250L160G	RED250L160Q	250	-	-	65,00	97,50
RED300L160G	RED300L160Q	300	-	0,00960	80,00	120,00
RED400L160G	RED400L160Q	400	-	0,01773	92,00	138,00
RED500L160G	RED500L160Q	500	-	-	126,00	189,00
RED600L160G	RED600L160Q	600	-	-	137,00	205,50

### Acessórios

#### Redução direita

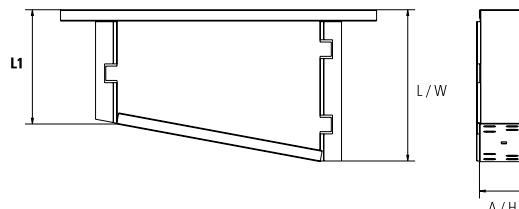
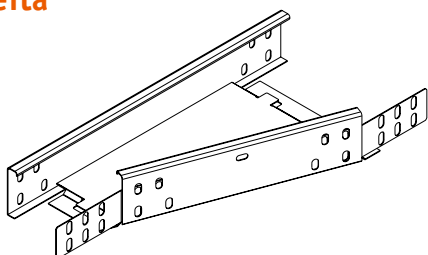

RED

G/Q

#### . ABA 75 .

Código		Largura L (mm)	Peso (Kg)	Volume (m3)	Euros €	
G	Q				G	Q
RED100L175G	RED100L175Q	100	-	-	62,00	93,00
RED150L175G	RED150L175Q	150	-	-	65,00	97,50
RED200L175G	RED200L175Q	200	-	-	69,00	103,50

#### . ABA 100 .

Código		Largura L (mm)	Peso (Kg)	Volume (m3)	Euros €	
G	Q				G	Q
RED150L1100G	RED150L1100Q	150	-	-	74,00	111,00
RED200L1100G	RED200L1100Q	200	-	-	78,00	117,00
RED300L1100G	RED300L1100Q	300	-	-	112,00	168,00
RED400L1100G	RED400L1100Q	400	-	-	129,00	193,50
RED500L1100G	RED500L1100Q	500	-	-	177,00	265,50

#### Tampa para redução direita

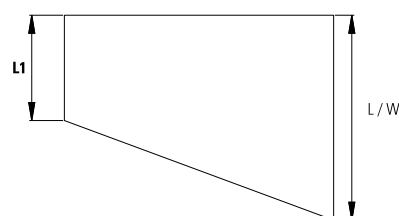
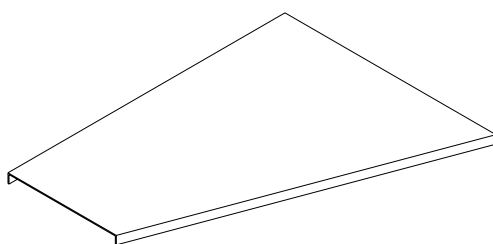

TRED

Código		Largura L (mm)	Peso (Kg)	Volume (m3)	Euros €	
G	Q				G	Q
TRED075L1G	TRED075L1Q	75	-	-	19,00	28,50
TRED100L1G	TRED100L1Q	100	-	-	21,00	31,50
TRED150L1G	TRED150L1Q	150	-	0,00034	22,80	34,20
TRED200L1G	TRED200L1Q	200	-	0,00056	24,60	36,90
TRED250L1G	TRED250L1Q	250	-	0,00057	27,00	40,50
TRED300L1G	TRED300L1Q	300	-	0,00069	30,00	45,00
TRED400L1G	TRED400L1Q	400	-	0,00092	36,00	54,00
TRED500L1G	TRED500L1Q	500	-	0,00115	44,50	66,75
TRED600L1G	TRED600L1Q	600	-	0,00138	54,60	81,90

### Acessórios

#### Redução esquerda

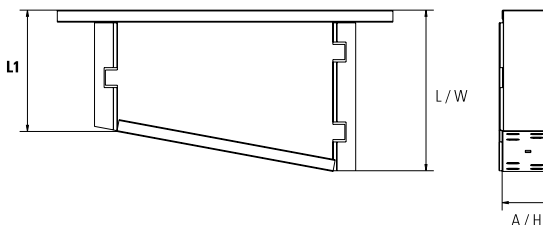
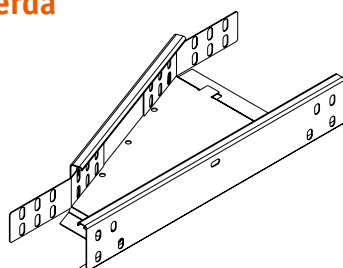

REE

#### . ABA 25 .

Código		Largura L(mm)	Peso (Kg)	Volume (m3)	Euros €	
G	Q				G	Q
REE075L125G	REE075L125Q	75	-	-	48,00	72,00
REE100L125G	REE100L125Q	100	-	-	50,00	75,00
REE150L125G	REE150L125Q	150	-	-	53,00	79,50
REE200L125G	REE200L125Q	200	-	-	57,00	85,50

#### . ABA 30 .

Código		Largura L(mm)	Peso (Kg)	Volume (m3)	Euros €	
G	Q				G	Q
REE150L130G	REE150L130Q	150	-	-	53,00	79,50
REE200L130G	REE200L130Q	200	-	-	57,00	85,50
REE250L130G	REE250L130Q	250	-	-	63,00	94,50
REE300L130G	REE300L130Q	300	-	-	75,00	112,50
REE400L130G	REE400L130Q	400	-	-	86,00	129,00

#### . ABA 50 .

Código		Largura L(mm)	Peso (Kg)	Volume (m3)	Euros €	
G	Q				G	Q
REE075L150G	REE075L150Q	75	-	-	48,00	72,00
REE100L150G	REE100L150Q	100	-	-	50,00	75,00
REE150L150G	REE150L150Q	150	-	-	55,00	82,50
REE200L150G	REE200L150Q	200	-	-	60,00	90,00

#### . ABA 60 .

Código		Largura L(mm)	Peso (Kg)	Volume (m3)	Euros €	
G	Q				G	Q
REE150L160G	REE150L160Q	150	-	-	55,00	82,50
REE200L160G	REE200L160Q	200	-	0,00665	60,00	90,00
REE250L160G	REE250L160Q	250	-	-	65,00	97,50
REE300L160G	REE300L160Q	300	-	-	80,00	120,00
REE400L160G	REE400L160Q	400	-	0,01830	92,00	138,00
REE500L160G	REE500L160Q	500	-	-	126,00	189,00
REE600L160G	REE600L160Q	600	-	-	137,00	205,50

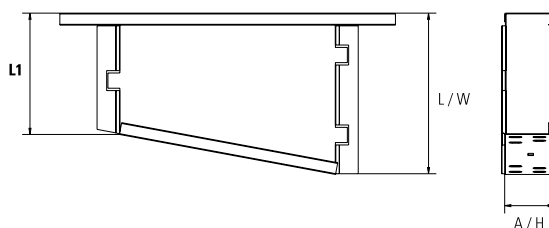
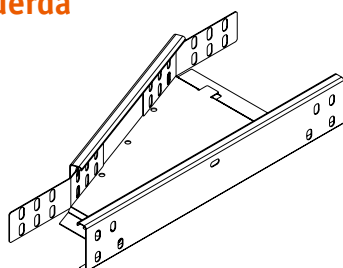
**Acessórios**
**Redução esquerda**

**REE**
**G/Q**
**. ABA 75 .**

Código		Largura L (mm)	Peso (Kg)	Volume (m3)	Euros €	
G	Q				G	Q
REE100L175G	REE100L175Q	100	-	-	<b>62,00</b>	<b>93,00</b>
REE150L175G	REE150L175Q	150	-	-	<b>65,00</b>	<b>97,50</b>
REE200L175G	REE200L175Q	200	-	-	<b>69,00</b>	<b>103,50</b>

**. ABA 100 .**

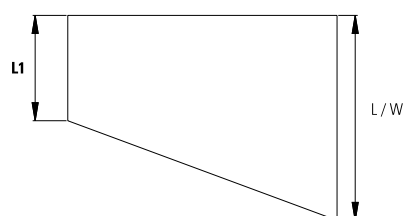
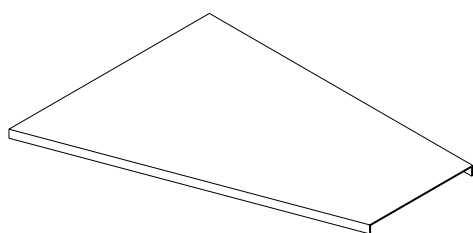
Código		Largura L (mm)	Peso (Kg)	Volume (m3)	Euros €	
G	Q				G	Q
REE150L1100G	REE150L1100Q	150	-	-	<b>74,00</b>	<b>111,00</b>
REE200L1100G	REE200L1100Q	200	-	-	<b>78,00</b>	<b>117,00</b>
REE300L1100G	REE300L1100Q	300	-	-	<b>112,00</b>	<b>168,00</b>
REE400L1100G	REE400L1100Q	400	-	-	<b>129,00</b>	<b>193,50</b>
REE500L1100G	REE500L1100Q	500	-	-	<b>177,00</b>	<b>265,50</b>

**Tampa para redução esquerda**

**TREE**

Código		Largura L (mm)	Peso (Kg)	Volume (m3)	Euros €	
G	Q				G	Q
TREE075L1G	TREE075L1Q	75	-	-	<b>19,00</b>	<b>28,50</b>
TREE100L1G	TREE100L1Q	100	-	-	<b>21,00</b>	<b>31,50</b>
TREE150L1G	TREE150L1Q	150	-	0,00034	<b>22,80</b>	<b>34,20</b>
TREE200L1G	TREE200L1Q	200	-	0,00056	<b>24,60</b>	<b>36,90</b>
TREE250L1G	TREE250L1Q	250	-	0,00057	<b>27,00</b>	<b>40,50</b>
TREE300L1G	TREE300L1Q	300	-	0,00069	<b>30,00</b>	<b>45,00</b>
TREE400L1G	TREE400L1Q	400	-	0,00092	<b>36,00</b>	<b>54,00</b>
TREE500L1G	TREE500L1Q	500	-	0,00115	<b>44,50</b>	<b>66,75</b>
TREE600L1G	TREE600L1Q	600	-	0,00138	<b>54,60</b>	<b>81,90</b>

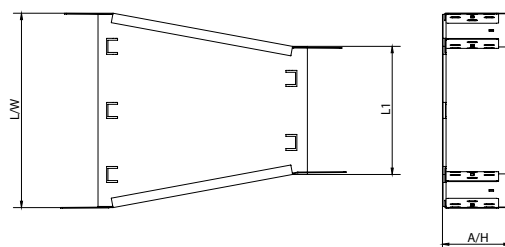
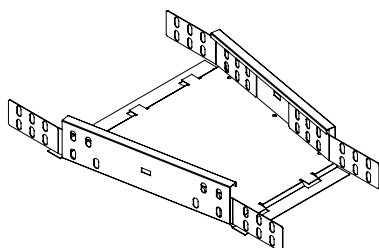

### Acessórios

#### Redução central



**REC**

#### . ABA 25 .

Código		Largura L(mm)	Peso (Kg)	Volume (m3)	Euros €	
G	Q				G	Q
REC075L125G	REC075L125Q	75	-	-	48,00	72,00
REC100L125G	REC100L125Q	100	-	-	50,00	75,00
REC150L125G	REC150L125Q	150	-	-	53,00	79,50
REC200L125G	REC200L125Q	200	-	-	57,00	85,50

#### . ABA 30 .

Código		Largura L(mm)	Peso (Kg)	Volume (m3)	Euros €	
G	Q				G	Q
REC150L130G	REC150L130Q	150	-	-	53,00	79,50
REC200L130G	REC200L130Q	200	-	-	57,00	85,50
REC250L130G	REC250L130Q	250	-	-	63,00	94,50
REC300L130G	REC300L130Q	300	-	-	75,00	112,50
REC400L130G	REC400L130Q	400	-	-	86,00	129,00

#### . ABA 50 .

Código		Largura L(mm)	Peso (Kg)	Volume (m3)	Euros €	
G	Q				G	Q
REC075L150G	REC075L150Q	75	-	-	48,00	72,00
REC100L150G	REC100L150Q	100	-	-	50,00	75,00
REC150L150G	REC150L150Q	150	-	-	55,00	82,50
REC200L150G	REC200L150Q	200	-	-	60,00	90,00

#### . ABA 60 .

Código		Largura L(mm)	Peso (Kg)	Volume (m3)	Euros €	
G	Q				G	Q
REC150L160G	REC150L160Q	150	-	-	55,00	82,50
REC200L160G	REC200L160Q	200	-	-	60,00	90,00
REC250L160G	REC250L160Q	250	-	-	65,00	97,50
REC300L160G	REC300L160Q	300	-	-	80,00	120,00
REC400L160G	REC400L160Q	400	-	0,01830	92,00	138,00
REC500L160G	REC500L160Q	500	-	-	126,00	189,00
REC600L160G	REC600L160Q	600	-	-	137,00	205,50

## Acessórios

### Redução central

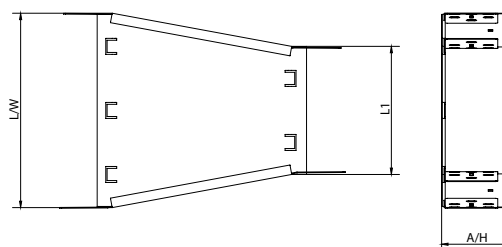
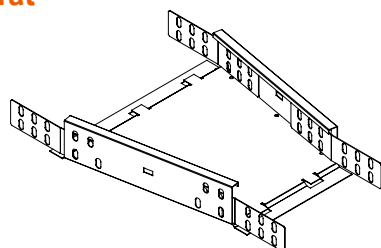
**REC**
**G/Q**

#### . ABA 75 .

Código		Largura L (mm)	Peso (Kg)	Volume (m3)	Euros €	
G	Q				G	Q
REC100L175G	REC100L175Q	100	-	-	62,00	93,00
REC150L175G	REC150L175Q	150	-	-	65,00	97,50
REC200L175G	REC200L175Q	200	-	-	69,00	103,50

#### . ABA 100 .

Código		Largura L (mm)	Peso (Kg)	Volume (m3)	Euros €	
G	Q				G	Q
REC150L1100G	REC150L1100Q	150	-	-	74,00	111,00
REC200L1100G	REC200L1100Q	200	-	-	78,00	117,00
REC300L1100G	REC300L1100Q	300	-	-	112,00	168,00
REC400L1100G	REC400L1100Q	400	-	-	129,00	193,50
REC500L1100G	REC500L1100Q	500	-	-	177,00	265,50

### Tampa para redução central

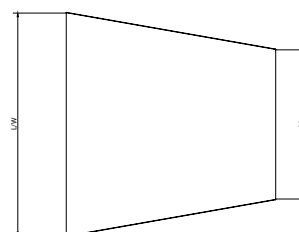
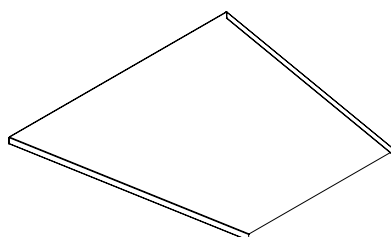

**TREC**

Código		Largura L (mm)	Peso (Kg)	Volume (m3)	Euros €	
G	Q				G	Q
TREC075L1G	TREC075L1Q	75	-	-	19,00	28,50
TREC100L1G	TREC100L1Q	100	-	-	21,00	31,50
TREC150L1G	TREC150L1Q	150	-	-	22,80	34,20
TREC200L1G	TREC200L1Q	200	-	-	24,60	36,90
TREC250L1G	TREC250L1Q	250	-	-	27,00	40,50
TREC300L1G	TREC300L1Q	300	-	-	30,00	45,00
TREC400L1G	TREC400L1Q	400	-	-	36,00	54,00
TREC500L1G	TREC500L1Q	500	-	-	44,50	66,75
TREC600L1G	TREC600L1Q	600	-	-	54,60	81,90

### Acessórios

#### Topo

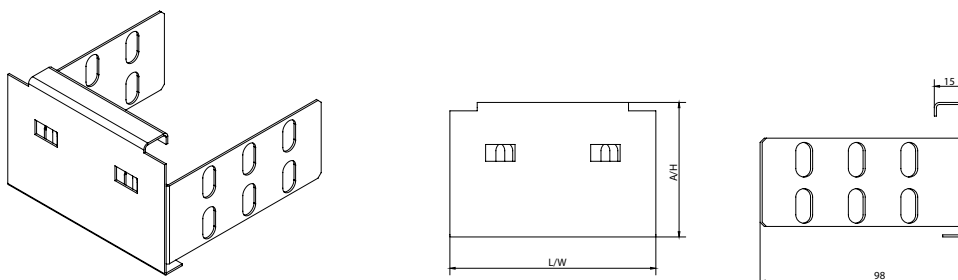
#### TOP



#### . ABA 25 .

Código		Largura L(mm)	Peso (Kg)	Volume (m3)	Euros €	
G	Q				G	Q
TOP05025G	TOP05025Q	50	-	-	8,50	12,75
TOP07525G	TOP07525Q	75	-	-	8,60	12,90
TOP10025G	TOP10025Q	100	-	-	8,70	13,05
TOP15025G	TOP15025Q	150	-	-	8,90	13,35
TOP20025G	TOP20025Q	200	-	-	9,00	13,50

#### . ABA 30 .

Código		Largura L(mm)	Peso (Kg)	Volume (m3)	Euros €	
G	Q				G	Q
TOP10030G	TOP10030Q	100	0,138	0,00032	8,50	13,05
TOP15030G	TOP15030Q	150	-	-	8,90	13,35
TOP20030G	TOP20030Q	200	-	-	10,30	15,45
TOP25030G	TOP25030Q	250	-	-	11,50	17,25
TOP30030G	TOP30030Q	300	-	-	13,20	19,80
TOP40030G	TOP40030Q	400	-	-	13,50	20,25

#### . ABA 50 .

Código		Largura L(mm)	Peso (Kg)	Volume (m3)	Euros €	
G	Q				G	Q
TOP05050G	TOP05050Q	50	-	-	10,50	15,75
TOP07550G	TOP07550Q	75	-	-	11,00	16,50
TOP10050G	TOP10050Q	100	-	-	11,50	17,25
TOP15050G	TOP15050Q	150	-	-	11,90	17,85
TOP20050G	TOP20050Q	200	-	-	12,20	18,30

#### . ABA 60 .

Código		Largura L(mm)	Peso (Kg)	Volume (m3)	Euros €	
G	Q				G	Q
TOP10060G	TOP10060Q	100	-	-	11,00	15,45
TOP15060G	TOP15060Q	150	0,244	0,00097	11,90	17,85
TOP20060G	TOP20060Q	200	-	-	12,25	18,38
TOP25060G	TOP25060Q	250	0,314	0,00162	14,10	21,15
TOP30060G	TOP30060Q	300	-	-	16,00	24,00
TOP40060G	TOP40060Q	400	0,426	0,00259	16,80	25,20
TOP50060G	TOP50060Q	500	-	-	22,20	33,30
TOP60060G	TOP60060Q	600	-	-	22,30	33,45

## Acessórios

### Topo

### TOP

G/Q

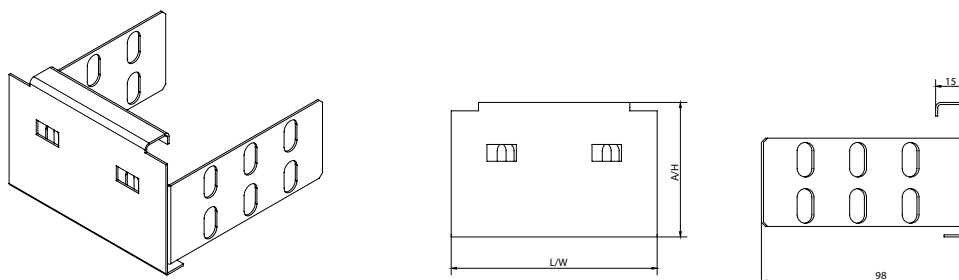

### . ABA 75 .

G	Código		Largura L(mm)	Peso (Kg)	Volume (m3)	Euros €	
	G	Q				G	Q
TOP07575G		TOP07575Q	75	-	-	18,00	27,00
TOP10075G		TOP10075Q	100	-	-	18,50	27,75
TOP15075G		TOP15075Q	150	-	-	19,50	29,25
TOP20075G		TOP20075Q	200	-	-	20,50	30,75

### . ABA 100 .

G	Código		Largura L(mm)	Peso (Kg)	Volume (m3)	Euros €	
	G	Q				G	Q
TOP100100G		TOP100100Q	100	-	-	26,00	39,00
TOP150100G		TOP150100Q	150	-	-	27,00	40,50
TOP200100G		TOP200100Q	200	-	-	28,00	42,00
TOP300100G		TOP300100Q	300	-	-	32,00	48,00
TOP400100G		TOP400100Q	400	-	-	36,00	54,00
TOP500100G		TOP500100Q	500	-	-	41,00	61,50

## Acessórios

### Canto de derivação lateral dupla

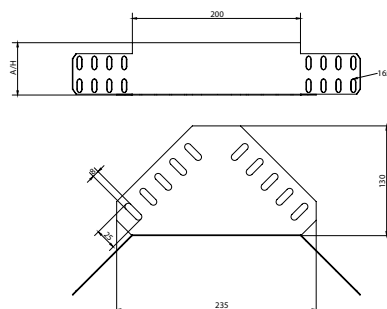
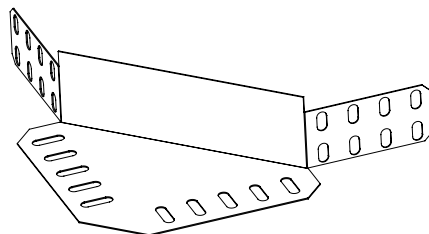

**DRDV**

#### . ABA 25 .

G	Código		Altura A(mm)	Peso (Kg)	Volume (m3)	Euros €	
	Q					G	Q
DRDV025G	DRDV025Q		25	-	-	7,30	10,95

#### . ABA 30 .

G	Código		Altura A(mm)	Peso (Kg)	Volume (m3)	Euros €	
	Q					G	Q
DRDV030G	DRDV030Q		30	-	-	7,30	10,95

#### . ABA 50 .

G	Código		Altura A(mm)	Peso (Kg)	Volume (m3)	Euros €	
	Q					G	Q
DRDV050G	DRDV050Q		50	-	-	8,05	12,08

#### . ABA 60 .

G	Código		Altura A(mm)	Peso (Kg)	Volume (m3)	Euros €	
	Q					G	Q
DRDV060G	DRDV060Q		60	0,284	0,00435	8,05	12,08

#### . ABA 75 .

G	Código		Altura A(mm)	Peso (Kg)	Volume (m3)	Euros €	
	Q					G	Q
DRDV075G	DRDV075Q		75	-	-	9,00	13,95

#### . ABA 100 .

G	Código		Altura A(mm)	Peso (Kg)	Volume (m3)	Euros €	
	Q					G	Q
DRDV100G	DRDV100Q		100	-	-	9,90	14,85

### Acessórios

#### Separador

#### SEPARA

G/Q

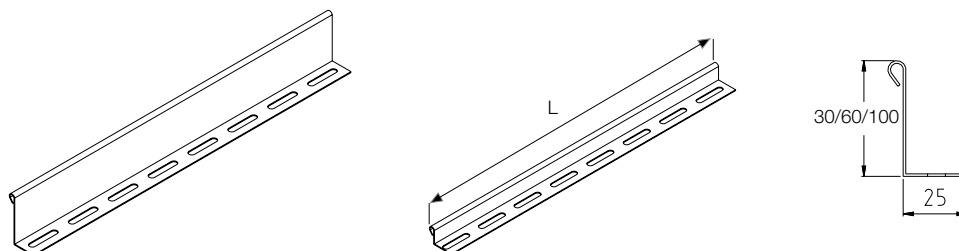

#### . ABA 30 .

G	Código		Comprimento L(mm)	Peso (Kg)	Volume (m3)	Euros €	
		Q				G	Q
SEPARA30G3	SEPARA30Q3		3000	-	-	4,00	6,00

#### . ABA 60 .

G	Código		Comprimento L(mm)	Peso (Kg)	Volume (m3)	Euros €	
		Q				G	Q
SEPARA60G3	SEPARA60Q3		3000	-	-	4,65	6,98

#### . ABA 100 .

G	Código		Comprimento L(mm)	Peso (Kg)	Volume (m3)	Euros €	
		Q				G	Q
SEPARA100G3	SEPARA100Q3		3000	-	-	13,60	20,40

## Acessórios

### Separador

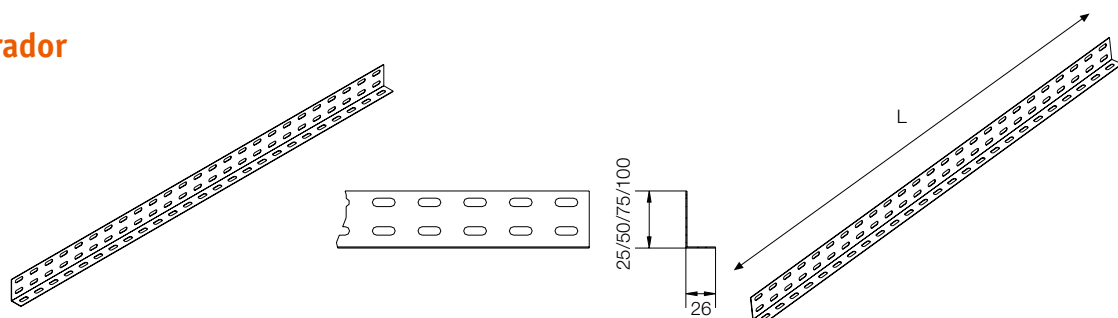

#### . ABA 25 .

G	Código		Comprimento L(mm)	Peso (Kg)	Volume (m3)	Euros €	
	G	Q				G	Q
SEPARA25G2		SEPARA25Q2	2000	0,565	0,00131	4,00	6,00

#### . ABA 50 .

G	Código		Comprimento L(mm)	Peso (Kg)	Volume (m3)	Euros €	
	G	Q				G	Q
SEPARA50G2		SEPARA50Q2	2000	-	-	4,65	6,98

#### . ABA 75 .

G	Código		Comprimento L(mm)	Peso (Kg)	Volume (m3)	Euros €	
	G	Q				G	Q
SEPARA75G2		SEPARA75Q2	2000	-	-	9,15	13,73

#### . ABA 100 .

G	Código		Comprimento L(mm)	Peso (Kg)	Volume (m3)	Euros €	
	G	Q				G	Q
SEPARA100G2		SEPARA100Q2	2000	-	-	13,60	20,40

## Caminho de Cabos em Varão Electro Soldado

. Calha em Varão Electro Soldado Pg. 48

### Acessórios

. Suportes Caixa Derivação Pg. 49

. Distanciadores

. Fixação de Calha

. Fixadores de Suspensão ao Tecto Pg. 50

. Uniões Simples

. Uniões Laterais



### Caminho de Cabos

### Calha varão electro soldado

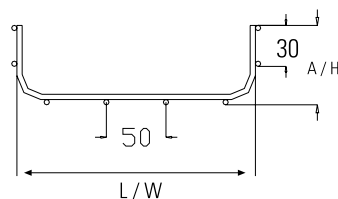
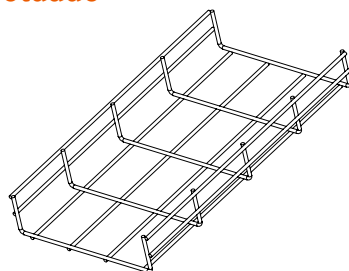

#### . ABA 30 .

Código		Largura L(mm)	Diâmetro (mm)	Peso Atado (Kg)	Volume Atado (m3)	Atado (m)	Euros €	
G	Q						G	Q
100G030	100Q030	100	4,4	14,000	0,05738	24	3,78	6,05
150G030	150Q030	150	4,4	12,570	0,06375	18	5,56	8,90
200G030	200Q030	200	4,4	16,950	0,08625	18	5,62	8,99
300G030	300Q030	300	4,4	15,440	0,11040	12	7,56	12,10

Calha de 3m

#### . ABA 60 .

Código		Largura L(mm)	Diâmetro (mm)	Peso Atado (Kg)	Volume Atado (m3)	Atado (m)	Euros €	
G	Q						G	Q
060G060	060Q060	60	4,4	19,860	0,06278	36	4,86	7,78
100G060	100Q060	100	4,4	16,170	0,08190	18	4,86	7,78
150G060	150Q060	150	4,4	17,520	0,10455	18	5,40	8,64
200G060	200Q060	200	4,4	22,230	0,09240	18	5,94	9,50
300G060	300Q060	300	4,9	18,900	0,13632	12	7,56	12,10
400G060	400Q060	400	4,9	11,420	0,16380	6	10,26	16,42
500G060	500Q060	500	4,9	13,550	0,20280	6	13,50	21,60
600G060	600Q060	600	4,9	15,580	0,24180	6	15,75	25,20

Calha de 3m

#### . ABA 100 .

Código		Largura L(mm)	Diâmetro (mm)	Peso Atado (Kg)	Volume Atado (m3)	Atado (m)	Euros €	
G	Q						G	Q
200G100	200Q100	200	4,9	-	-	6	14,04	22,46
300G100	300Q100	300	4,9	-	-	6	18,09	28,94
400G100	400Q100	400	4,9	-	-	6	22,85	36,56
450G100	450Q100	450	4,9	-	-	6	27,32	43,71
600G100	600Q100	600	4,9	-	-	6	30,13	48,21

Calha de 3m

### Acessórios

#### Suporte para caixa

SFP

G/Q

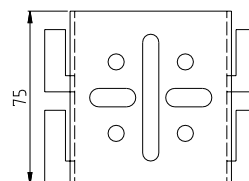
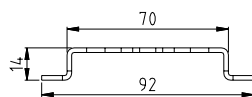
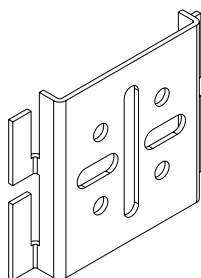

Código		Un/Emb.	Peso (Kg)	Volume (m3)	Euros €	
G	Q				G	Q
SFP070G	SFP070Q	25	2,642	0,00427	2,20	3,30

#### Distanciador

DST

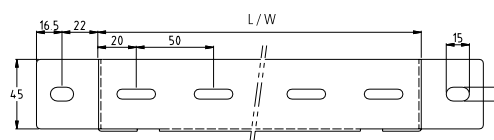
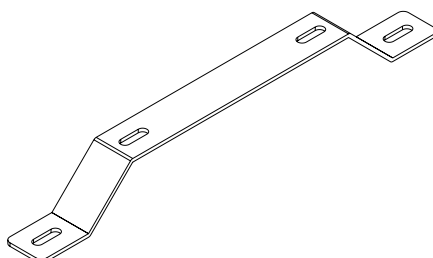

Código		Largura L(mm)	Un/Emb.	Peso (Kg)	Volume (m3)	Euros €	
G	Q					G	Q
DST100G	DST100Q	100	25	6,125	0,00337	4,80	7,68
DST200G	DST200Q	200	20	6,540	0,00315	5,20	8,32
DST300G	DST300Q	300	20	8,215	0,00299	6,00	9,60
DST400G	DST400Q	400	15	7,375	0,00331	6,32	10,11
DST500G	DST500Q	500	10	5,740	0,00359	6,88	11,01
DST600G	DST600Q	600	10	6,620	0,00418	8,55	13,68

#### Fixação de calha

FIXCON

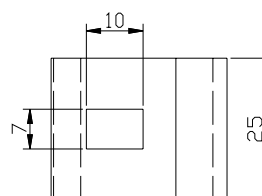
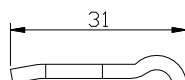
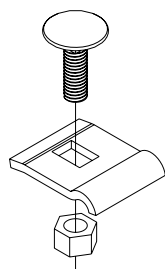

Código		Un/Emb.	Peso (Kg)	Volume (m3)	Euros €	
G	Q				G	Q
FIXCONG	FIXCONQ	100	2,210	0,00252	0,90	1,44

### Acessórios

#### Fixador de suspensão ao teto

**FIZUTE**

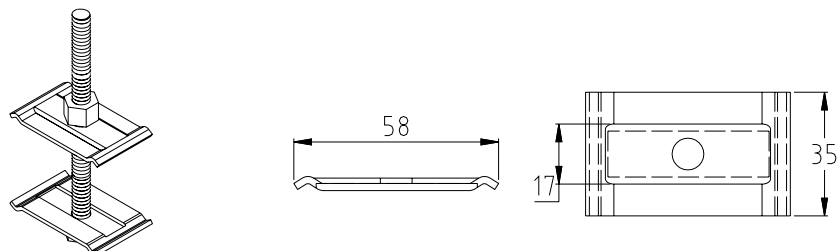

G	Código		Un/Emb.	Peso (Kg)	Volume (m3)	Euros €	
	Q					G	Q
FIZUTEG	FIZUTEQ		100	6,555	0,00356	2,40	3,84

#### União simples

**UNSIMP**

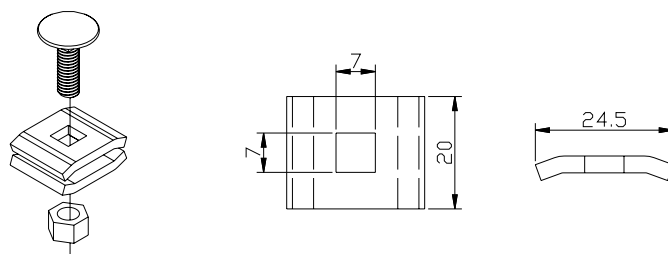

G	Código		Un/Emb.	Peso (Kg)	Volume (m3)	Euros €	
	Q					G	Q
UNSIMPG	UNSIMPQ		100	3,098	0,00240	1,07	1,71

#### União lateral

**UNLT**

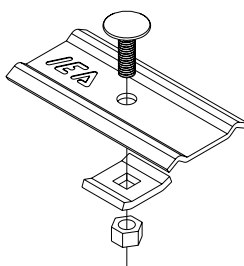

G	Código		Un/Emb.	Peso (Kg)	Volume (m3)	Euros €	
	Q					G	Q
UNLT30G	UNLT30Q		100	5,050	0,00253	1,35	2,16
UNLT60G	UNLT60Q		100	7,300	0,00349	1,65	2,64

## Caminho de Cabos em Chapa de Aço (Alimentação de Motores)

. Calha Perfurada para Alimentação de Motores	Pg. 52
---	--------

### Acessórios

. Tampas	Pg. 53
. Molas	
. Uniões Simples	
. Curvas Interiores	Pg. 54
. Curvas Exteriores	

### Caminho de Cabos

### Calha perfurada para alimentação de motores

**CMG/CMQ**

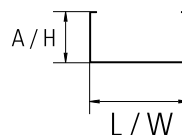
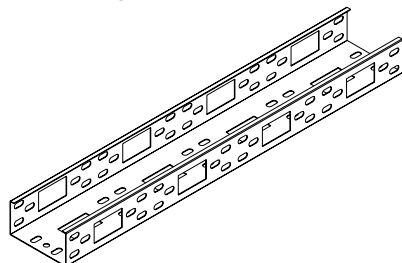

#### . ABA 50 .

Código		Largura L(mm)	Espessura (mm)	Peso Atado(Kg)		Volume Atado(m3)		Euros €	
G	Q			Calha 2m	Calha 3m	Calha 2m	Calha 3m	G	Q
CMG05050E3	CMQ05050E3	50	1,0	-	-	-	-	<b>10,10</b>	<b>16,16</b>
CMG10050E3	CMQ10050E3	100	1,0	-	-	-	-	<b>15,15</b>	<b>24,24</b>

Atado de 6m > Calha de 3m  
Atado de 4m > Calha de 2m (sob consulta)

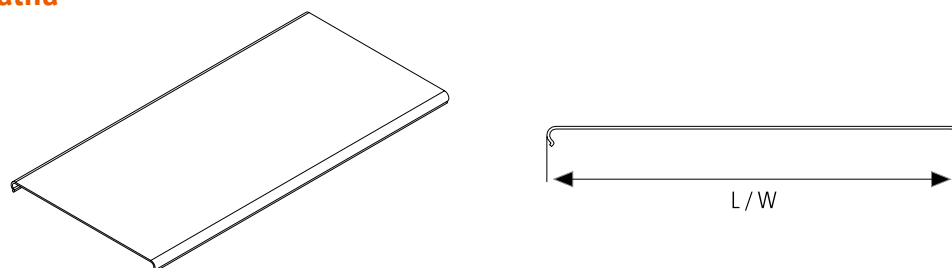
**Acessórios**
**Tampa para calha**
**TCM**

**G/Q**

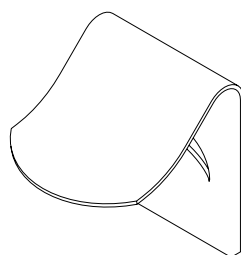
Código		Largura L(mm)	Peso (Kg)	Volume (m3)	Euros €	
G	Q				G	Q
TCMG050E3	TCMQ050E3	50	-	-	<b>4,20</b>	<b>6,30</b>
TCMG100E3	TCMQ100E3	100	-	-	<b>6,07</b>	<b>9,11</b>

**Mola fixação da tampa**
**FIXTAMP**

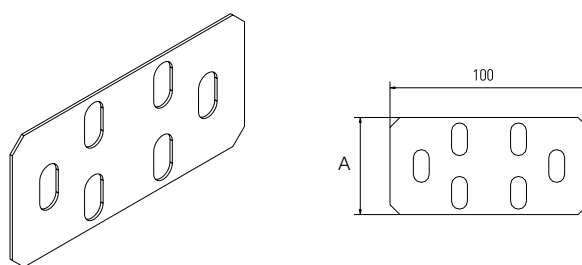
Código		Un/Emb.	Peso (Kg)	Volume (m3)	Euros €	
G	Q				G	Q
FIXTAMP	-	1	0,004	0,00001	<b>2,90</b>	-

**União simples**
**USM**

**. ABA 50 .**

Código		Altura A(mm)	Peso (Kg)	Volume (m3)	Euros €	
G	Q				G	Q
USM05050G	USM05050Q	49	0,155	0,00007	<b>4,00</b>	<b>6,40</b>
USM10050G	USM10050Q	49	-	-	<b>4,00</b>	<b>6,40</b>

### Acessórios

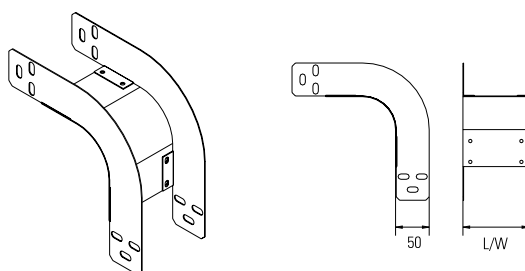
#### Curva interior



**CRIM**

#### . ABA 50 .

Código		Largura L(mm)	Peso (Kg)	Volume (m3)	Euros €	
G	Q				G	Q
CRIM05050G	CRIM05050Q	50	-	-	37,50	60,00
CRIM10050G	CRIM10050Q	100	-	-	40,80	65,28

#### Curva exterior

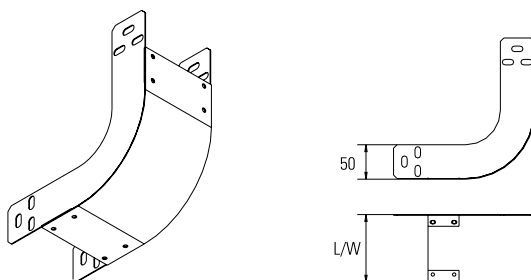

**CREM**

#### . ABA 50 .

Código		Largura L(mm)	Peso (Kg)	Volume (m3)	Euros €	
G	Q				G	Q
CREM05050G	CREM05050Q	50	-	-	37,50	60,00
CREM10050G	CREM10050Q	100	-	-	40,80	65,28

## Sistemas de Suspensão

### Acessórios

. Consolas Horizontais para Fixação à Parede	Pg. 56
. Consolas Horizontais Reforçadas para Fixação à Parede	
. Suportes de Consola Lateral para Fixação à Parede	Pg. 57
. Suportes de Consola Lateral para Fixação à Parede de Encaixe Rápido	
. Suportes de Consola de Tecto	Pg. 58
. Suportes de Consola de Tecto de Encaixe Rápido	
. Suportes Verticais Simples	Pg. 59
. Suportes Verticais Duplos	
. Consolas Horizontais para Suportes Verticais	
. Consolas Orientáveis Reforçadas	Pg. 60
. Esquadros para Fixação de Perfis à Viga (Furo Oval)	
. Esquadros para Fixação de Perfis à Viga (Furo Redondo)	Pg. 61
. Perfis Perfurados	
. Perfis Perfurados	Pg. 62
. Suspensões Centrais Interiores	
. Suspensões Centrais Exteriores	Pg. 63
. Varão Roscado M8	
. Distanciadores para Varão	Pg. 64
. Buchas de Fixação	
. Tacos Metálicos	
. Parafusos com Porca e Anilha	Pg. 65
. Patas de Fixação	
. Fixação Mural	



### Acessórios

#### Consola horizontal para fixação à parede

**CHP**

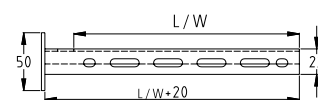
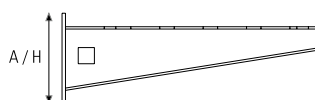
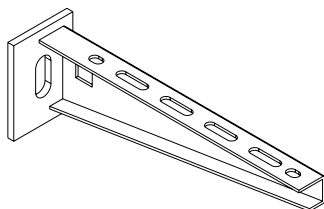

Código		Largura x Altura LxA(mm)	Un/Emb	Peso (Kg)	Volume (m3)	Euros €	
G	Q					G	Q
CHP100G	CHP100Q	100 x 45	25	6,185	0,00821	<b>6,46</b>	<b>9,69</b>
CHP200G	CHP200Q	200 x 70	25	8,320	0,01281	<b>7,54</b>	<b>11,31</b>
CHP300G	CHP300Q	300 x 70	25	16,620	0,02121	<b>8,75</b>	<b>13,13</b>
CHP400G	CHP400Q	400 x 90	10	8,800	0,01288	<b>13,95</b>	<b>20,93</b>
CHP500G	CHP500Q	500 x 110	10	11,450	0,02525	<b>19,58</b>	<b>29,37</b>
CHP600G	CHP600Q	600 x 110	10	14,135	0,03628	<b>21,47</b>	<b>32,12</b>

#### Consola horizontal reforçada para fixação à parede

**CHR**

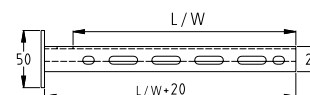
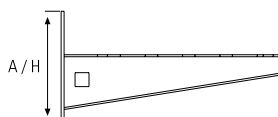
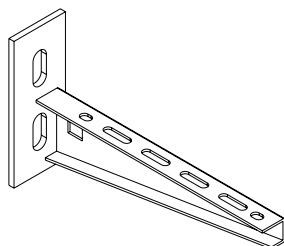

Código		Largura x Altura LxA(mm)	Un/Emb	Peso (Kg)	Volume (m3)	Euros €	
G	Q					G	Q
CHR100G	CHR100Q	100 x 110	25	8,395	0,00897	<b>6,98</b>	<b>10,47</b>
CHR200G	CHR200Q	200 x 110	25	-	-	<b>8,15</b>	<b>12,23</b>
CHR300G	CHR300Q	300 x 110	20	14,045	0,02092	<b>9,45</b>	<b>14,18</b>
CHR400G	CHR400Q	400 x 155	10	10,195	0,02510	<b>15,06</b>	<b>22,59</b>
CHR500G	CHR500Q	500 x 155	10	11,990	0,02479	<b>22,13</b>	<b>33,20</b>
CHR600G	CHR600Q	600 x 155	10	14,655	0,03584	<b>25,69</b>	<b>38,54</b>

**Acessórios**

**Suporte de consola lateral para fixação à parede**

**CHL**

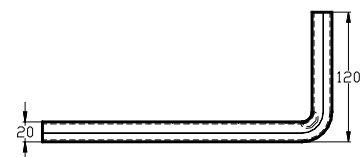
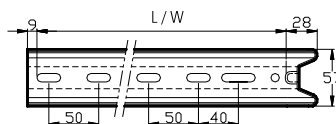
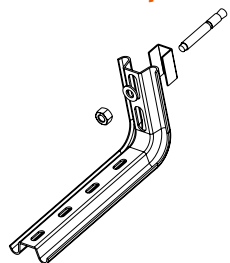

**G/Q**

Código		Largura L(mm)	Un/Emb	Peso (Kg)	Volume (m3)	Euros €	
G	Q					G	Q
CHL100G	CHL100Q	100	20	5,950	0,00807	4,00	6,00
CHL150G	CHL150Q	150	20	7,140	0,00807	4,50	6,75
CHL200G	CHL200Q	200	20	8,930	0,00807	4,80	7,20
CHL250G	CHL250Q	250	20	10,325	0,01285	5,40	8,10
CHL300G	CHL300Q	300	20	11,330	0,01285	5,70	8,55
CHL350G	CHL350Q	350	20	12,630	0,01280	6,50	9,75

**Suporte de consola lateral para fixação à parede de encaixe rápido**

**VHL**

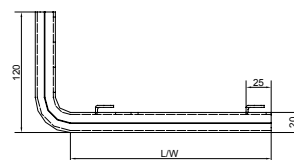
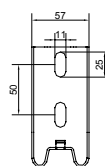
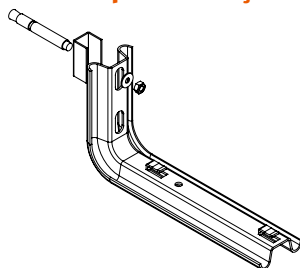

Código		Largura L(mm)	Un/Emb	Peso (Kg)	Volume (m3)	Euros €	
G	Q					G	Q
VHL100G	VHL100Q	100	20	7,495	0,00874	4,00	6,00
VHL150G	VHL150Q	150	20	7,495	0,00874	4,50	6,75
VHL200G	VHL200Q	200	20	8,775	0,00891	4,80	7,20
VHL250G	VHL250Q	250	20	-	-	5,40	8,10
VHL300G	VHL300Q	300	20	-	-	5,70	8,55

Apenas para calha varão electro soldado

## Acessórios

## Suporte de consola de teto

**CHT**

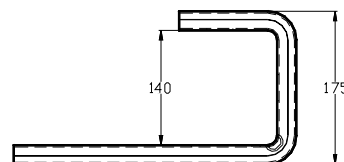
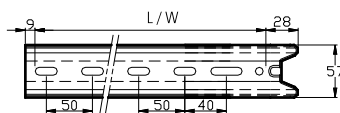
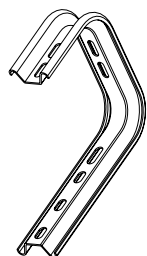

Código		Largura L(mm)	Un/Emb	Peso (Kg)	Volume (m3)	Euros €	
G	Q					G	Q
CHT100G	CHT100Q	100	10	5,075	0,00928	<b>6,80</b>	<b>10,20</b>
CHT150G	CHT150Q	150	15	8,550	0,01796	<b>7,04</b>	<b>10,56</b>
CHT200G	CHT200Q	200	15	9,745	0,01752	<b>7,70</b>	<b>11,55</b>
CHT250G	CHT250Q	250	10	7,220	0,01678	<b>9,57</b>	<b>14,36</b>
CHT300G	CHT300Q	300	10	7,600	0,01776	<b>10,45</b>	<b>15,68</b>

## Suporte de consola lateral de teto de encaixe rápido

**VHT**

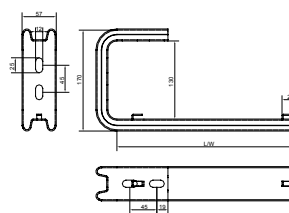
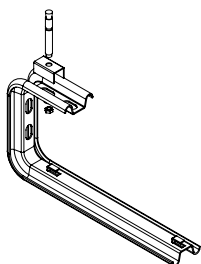

Código		Largura L(mm)	Un/Emb	Peso (Kg)	Volume (m3)	Euros €	
G	Q					G	Q
VHT100G	VHT100Q	100	10	5,080	0,00913	<b>6,80</b>	<b>10,20</b>
VHT150G	VHT150Q	150	15	-	-	<b>7,04</b>	<b>10,56</b>
VHT200G	VHT200Q	200	15	9,695	0,01790	<b>7,70</b>	<b>11,55</b>
VHT250G	VHT250Q	250	10	-	-	<b>9,57</b>	<b>14,36</b>
VHT300G	VHT300Q	300	10	-	-	<b>10,45</b>	<b>15,68</b>

Apenas para calha varão electro soldado

**Acessórios**

**Suporte vertical simples**

**SFT**

**G/Q**

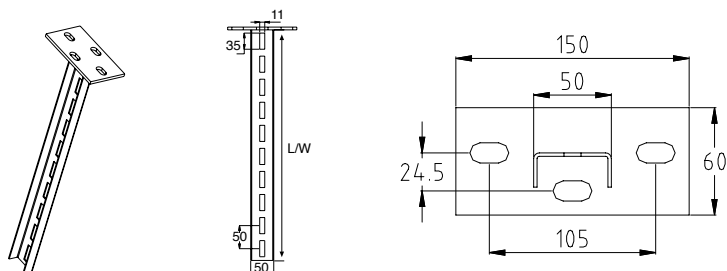

Código		Largura L(mm)	Un/Emb	Peso (Kg)	Volume (m3)	Euros €	
G	Q					G	Q
SFT050G	SFT050Q	500	10	10,105	0,03381	12,15	18,25

**Suporte vertical duplo**

**SFT**

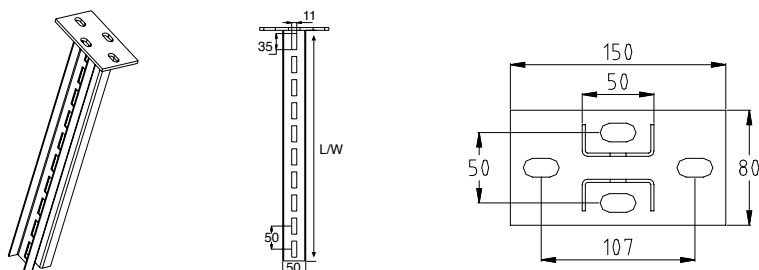

Código		Largura L(mm)	Un/Emb	Peso (Kg)	Volume (m3)	Euros €	
G	Q					G	Q
SFT052G	SFT052Q	500	10	17,855	0,03381	29,00	43,50

**Consola horizontal para suporte vertical**

**CHS**

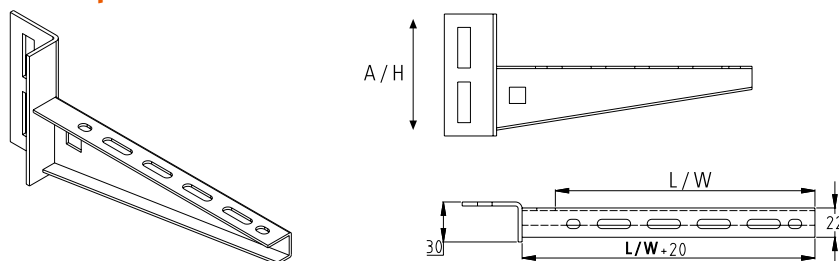

Código		Largura x Altura LxA(mm)	Un/Emb	Peso (Kg)	Volume (m3)	Euros €	
G	Q					G	Q
CHS100G	CHS100Q	100 x 70	25	3,625	0,00799	6,20	9,30
CHS200G	CHS200Q	200 x 105	25	9,500	0,01776	8,25	12,38
CHS300G	CHS300Q	300 x 105	25	15,425	0,02401	9,60	14,40

### Acessórios

#### Consola orientável reforçada

**CHO**

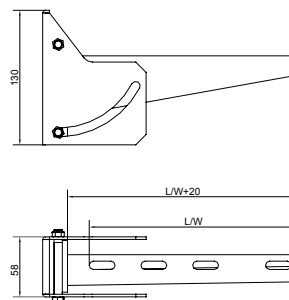
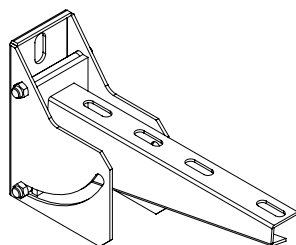

G	Código		Largura L(mm)	Peso (Kg)	Volume (m3)	Euros €	
	Q					G	Q
CH0100G	CH0100Q		100	-	-	36,05	54,08
CH0150G	CH0150Q		150	-	-	36,80	55,20
CH0200G	CH0200Q		200	-	-	37,60	56,40
CH0250G	CH0250Q		250	-	-	38,25	57,38
CH0300G	CH0300Q		300	-	-	38,92	58,38
CH0400G	CH0400Q		400	-	-	42,68	64,02
CH0500G	CH0500Q		500	-	-	46,95	70,43
CH0600G	CH0600Q		600	-	-	50,21	75,32

#### Esquadro para fixação de perfis à viga (furo oval)

**EFVO**

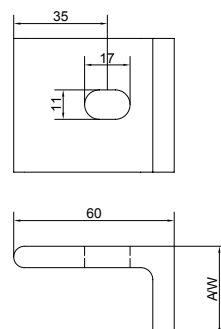
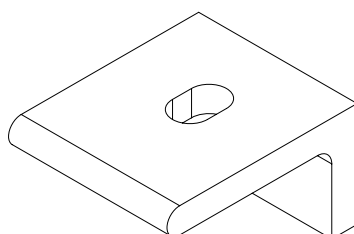

G	Código		Altura A(mm)	Peso (Kg)	Volume (m3)	Euros €	
	Q					G	Q
EFV0005G	EFV0005Q		5	-	-	4,25	6,38
EFV0010G	EFV0010Q		10	-	-	4,27	6,41
EFV0015G	EFV0015Q		15	-	-	4,30	6,45
EFV0020G	EFV0020Q		20	-	-	4,33	6,50
EFV0025G	EFV0025Q		25	-	-	4,35	6,53

### Acessórios

#### Esquadro para fixação de perfis à viga (furo redondo)

EFVR

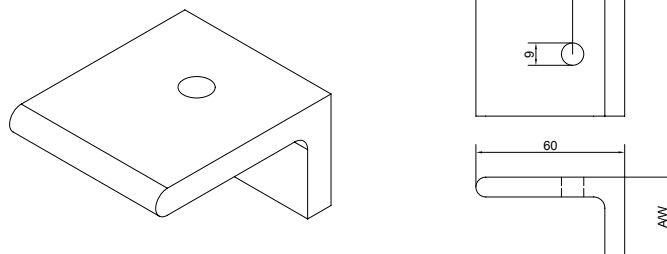

G/Q

Código		Altura A(mm)	Peso (Kg)	Volume (m3)	Euros €	
G	Q				G	Q
EFVR005G	EFVR005Q	5	-	-	4,27	6,40
EFVR010G	EFVR010Q	10	-	-	4,30	6,45
EFVR015G	EFVR015Q	15	-	-	4,33	6,46
EFVR020G	EFVR020Q	20	-	-	4,35	6,50
EFVR025G	EFVR025Q	25	-	-	4,37	6,60

#### Perfil perfurado

KHA

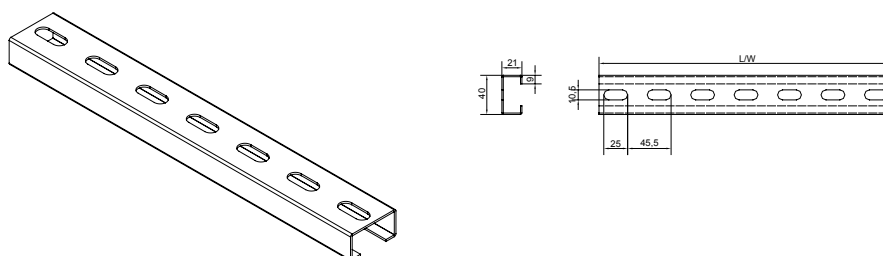

Código		Largura x Altura LxA(mm)	Peso (Kg)	Volume (m3)	Euros €	
G	Q				G	Q
KHA040G	KHA040Q	3000 x 40	3,250	0,00265	9,30	13,95

#### Perfil perfurado

KHB

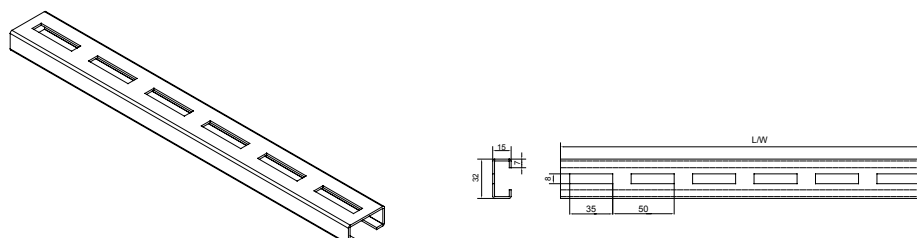

Código		Largura x Altura LxA(mm)	Peso (Kg)	Volume (m3)	Euros €	
G	Q				G	Q
KHB030G	KHB030Q	3000 x 30	2,130	0,00135	8,40	12,60

### Acessórios

#### Perfil perfurado

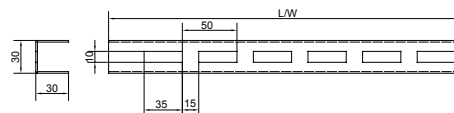
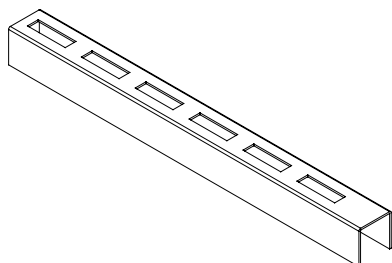
**KHD**

G	Código		Largura x Altura LxA(mm)	Peso (Kg)	Volume (m3)	Euros €	
	Q					G	Q
KHD030G	KHD030Q		3000 x 30	2,760	0,00294	<b>12,60</b>	<b>18,90</b>

#### Suspensão central interior

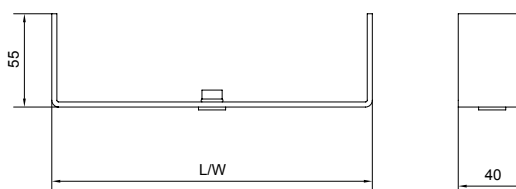
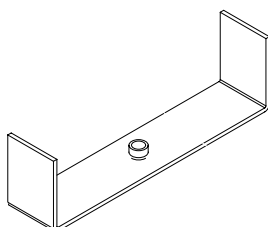
**SCI**

#### . ABA 30 .

G	Código		Largura L(mm)	Un/Emb.	Peso (Kg)	Volume (m3)	Euros €	
	Q						G	Q
SCI10030G	SCI10030Q		100	25	3,085	0,00369	<b>6,50</b>	<b>9,75</b>
SCI15030G	SCI15030Q		150	25	-	-	<b>6,75</b>	<b>10,13</b>
SCI20030G	SCI20030Q		200	25	-	-	<b>7,00</b>	<b>10,50</b>
SCI25030G	SCI25030Q		250	25	-	-	<b>7,50</b>	<b>11,25</b>
SCI30030G	SCI30030Q		300	25	-	-	<b>8,00</b>	<b>12,00</b>

#### . ABA 60 .

G	Código		Largura L(mm)	Un/Emb.	Peso (Kg)	Volume (m3)	Euros €	
	Q						G	Q
SCI10060G	SCI10060Q		100	25	-	-	<b>7,50</b>	<b>11,25</b>
SCI15060G	SCI15060Q		150	25	-	-	<b>7,75</b>	<b>11,63</b>
SCI20060G	SCI20060Q		200	25	-	-	<b>8,00</b>	<b>12,00</b>
SCI25060G	SCI25060Q		250	25	-	-	<b>7,50</b>	<b>12,75</b>
SCI30060G	SCI30060Q		300	25	-	-	<b>9,00</b>	<b>13,50</b>

### Acessórios

#### Suspensão central exterior

**SCE**

**G/Q**

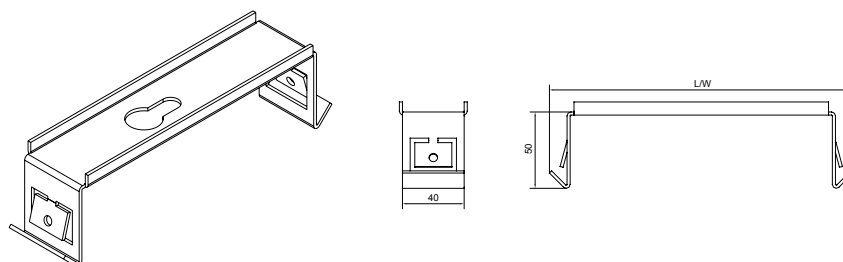

Código		Largura L(mm)	Un/Emb.	Peso (Kg)	Volume (m3)	Euros €	
G	Q					G	Q
SCE10000G	SCE10000Q	100	20	2,325	0,00816	7,20	10,80
SCE15000G	SCE15000Q	150	20	3,060	0,00799	7,60	11,40
SCE20000G	SCE20000Q	200	20	3,925	0,00852	8,40	12,60
SCE25000G	SCE25000Q	250	20	-	-	9,20	13,80
SCE30000G	SCE30000Q	300	20	5,780	0,00920	10,00	15,00

#### Suspensão central exterior calha de varão

**SUCA**

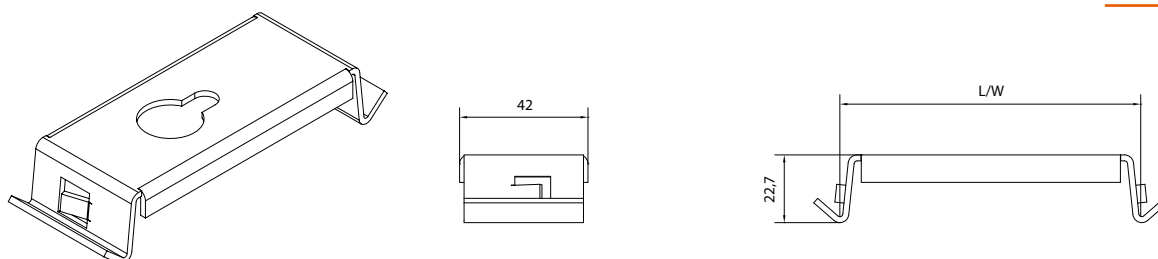

Código		Largura L(mm)	Un/Emb.	Peso (Kg)	Volume (m3)	Euros €	
G	Q					G	Q
SUCA060G	SUCA060Q	60	25	-	-	7,00	10,50
SUCA100G	SUCA100Q	100	25	-	-	7,20	10,80
SUCA150G	SUCA150Q	150	25	-	-	7,60	11,40
SUCA200G	SUCA200Q	200	25	-	-	8,40	12,60
SUCA300G	SUCA300Q	300	25	-	-	10,00	15,00

#### Varão roscado M8

**VAROSC**

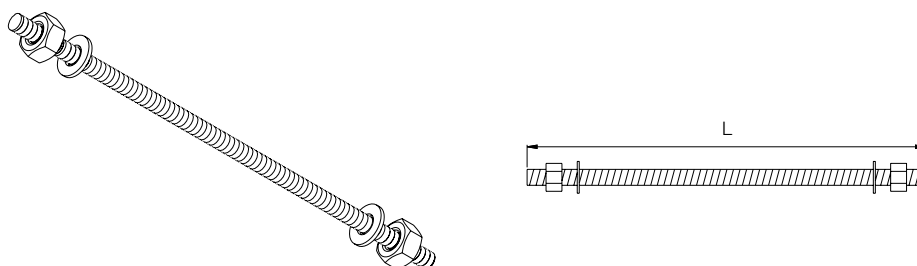

Código		Largura L(mm)	Peso (Kg)	Volume (m3)	Euros €	
G	Q				G	Q
VAROSC M8	-	1000	0,296	0,00016	1,60	-



### Acessórios

#### Distanciador para varão

**DVAR**

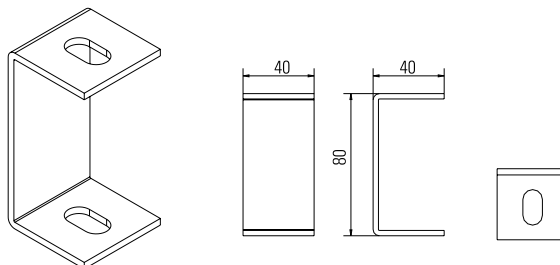

G	Código		Un/Emb.	Peso (Kg)	Volume (m3)	Euros €	
		Q				G	Q
DVARM10G		DVARM10Q	25	3,590	0,00367	<b>2,90</b>	<b>4,93</b>

#### Bucha de fixação

**BUC**

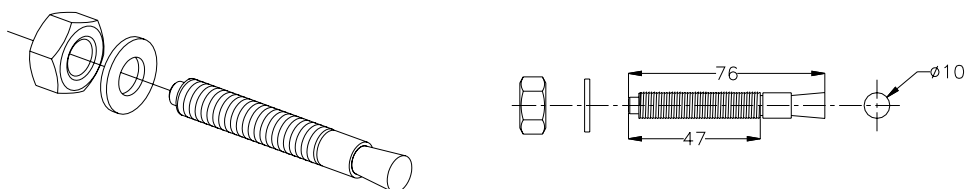

G	Código		Un/Emb.	Peso (Kg)	Volume (m3)	Euros €	
		Q				G	Q
BUCM0860G	-		50	1,530	0,00126	<b>0,96</b>	-
BUCM1080G	-		50	-	-	<b>1,20</b>	-

#### Taco metálico

**TACMT**

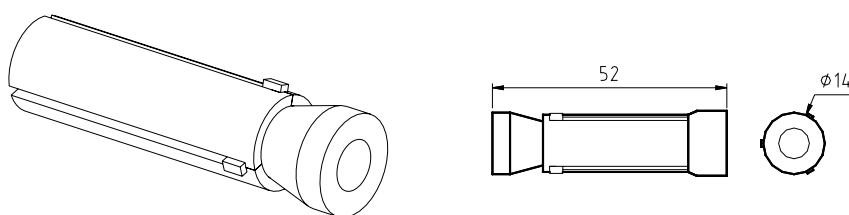

G	Código		Un/Emb.	Peso (Kg)	Volume (m3)	Euros €	
		Q				G	Q
TACMT M06	-		50	0,584	0,00085	<b>1,26</b>	-
TACMT M08	-		50	-	-	<b>1,92</b>	-

### Acessórios

#### Parafuso com porca: anilha mola/anilha capa M6x12

**PARAFUS**

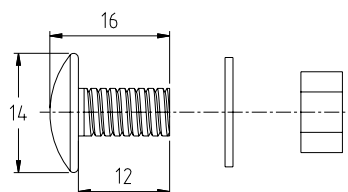
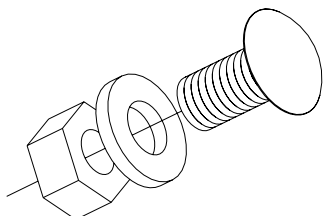

G/Q

Código		Un/Emb.	Peso (Kg)	Volume (m3)	Euros €	
G	Q				G	Q
PARAFUSG		100	0,810	0,00066	0,14	-

#### Pata de fixação

**PFCM**

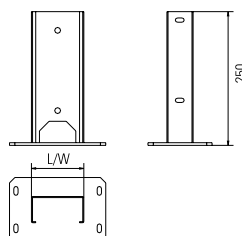
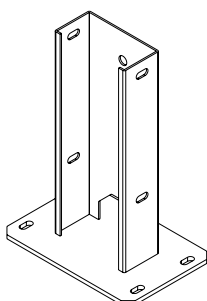

Código		Largura L(mm)	Peso (Kg)	Volume (m3)	Euros €	
G	Q				G	Q
PFCM05050G	PFCM05050Q	50	-	-	53,75	81,63
PFCM10050G	PFCM10050Q	100	1,520	0,00548	55,70	83,55

#### Fixação mural

**AFMM**

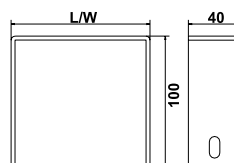
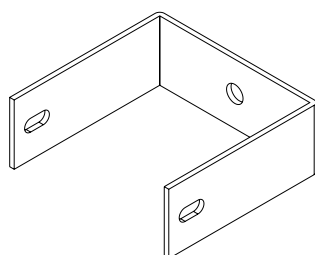

Código		Largura L(mm)	Peso (Kg)	Volume (m3)	Euros €	
G	Q				G	Q
AFMM05050G	AFMM05050Q	50	-	-	3,00	5,10
AFMM10050G	AFMM10050Q	100	-	-	3,50	5,95

Notas

---

---

---

---

---

---

---

---

---

---

---

---

---

---

---

## Caminho de Cabos em Chapa de Aço (Resistente ao Fogo)

. Calha Perfurada Estampada Resistente ao Fogo	Pg. 68
--	--------

### Acessórios

. Tapa Juntas	Pg. 69
. Uniões Laterais	
. Uniões Articuladas	

**FG/FQ**

. Curvas	Pg. 70
. Curvas a 45°	
. Cruzetas	

. Derivações "T"	Pg. 71
. Derivações Laterais	
. Cantos de Derivação Lateral Dupla	

. Ângulos Subida-Descida	Pg. 72
. Curvas Ângulo Subida	
. Curvas Ângulo Descida	

. Reduções Simples	Pg. 73
. Reduções Direitas	
. Reduções Esquerdas	

. Reduções Centrais	Pg. 74
. Topos	
. Separadores	

. Suportes para Caixas Derivação	Pg. 75
. Suportes Verticais Simples	

. Consolas Horizontais para Fixação à Parede	Pg. 76
. Consolas Horizontais Reforçadas para Fixação à Parede	

. Consolas Horizontais para Suportes Verticais	Pg. 77
. Ângulos de Fixação	
. Perfis Perfurados	

. Distanciadores para Varão	Pg. 78
. Varão Roscado	
. Buchas de Fixação	

### Caminho de Cabos

## Chapa de aço perfurada e estampada (resistente ao fogo)

**CFG/CFQ**

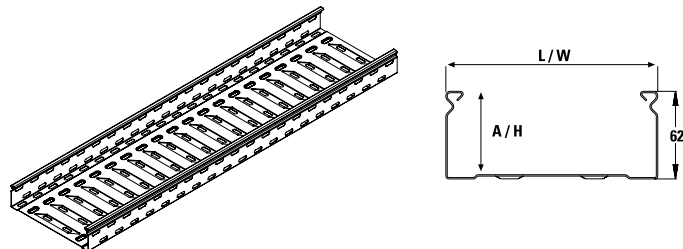

### . ABA 60 .

Código		Largura A(mm)	Espessura (mm)	Peso Atado (Kg) Calha 3m	Volume do Atado (m3) Calha 3m	Euros €	
G	Q					G	Q
CFG10060E3	CFQ10060E3	100	1,5	16,000	0,02340	<b>14,70</b>	<b>22,05</b>
CFG20060E3	CFQ20060E3	200	1,5	23,000	0,04290	<b>20,14</b>	<b>30,21</b>
CFG30060E3	CFQ30060E3	300	1,5	30,000	0,06240	<b>29,58</b>	<b>42,20</b>

Atados de 6m > Calha de 3m

### Acessórios

#### Tapa juntas

#### TAPACF

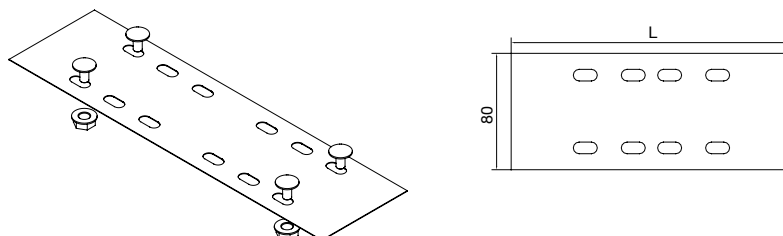

FG/FQ

#### . ABA 60 .

G	Código		Largura L(mm)	Peso (Kg)	Volume (m3)	Euros €	
		Q				G	Q
TAPACF100FG		TAPACF100FQ	93	0,114	0,00001	1,45	2,18
TAPACF200FG		TAPACF200FQ	193	0,203	0,00002	2,89	4,34
TAPACF300FG		TAPACF300FQ	293	0,260	0,00004	4,34	6,51

Tapa juntas inclui 4 parafusos M6x12 + 4 porcas mesa DIN6923 M6

#### União lateral

#### UNL

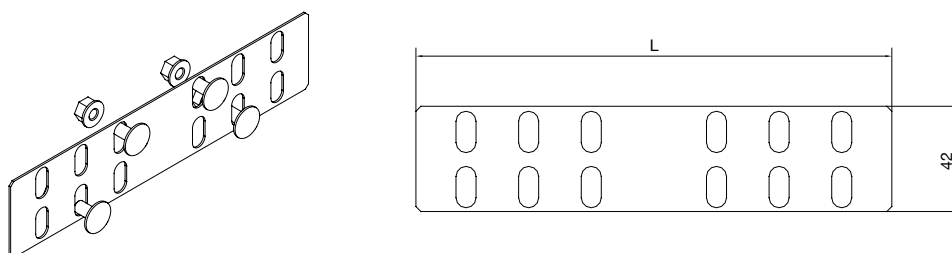

#### . ABA 60 .

G	Código		Largura L(mm)	Peso (Kg)	Volume (m3)	Euros €	
		Q				G	Q
UNL060FG		UNL060FQ	190	0,218	0,00349	1,47	2,21

União lateral inclui 4 parafusos M6x12 + 4 porcas mesa DIN6923 M6

#### União articulada

#### UNA

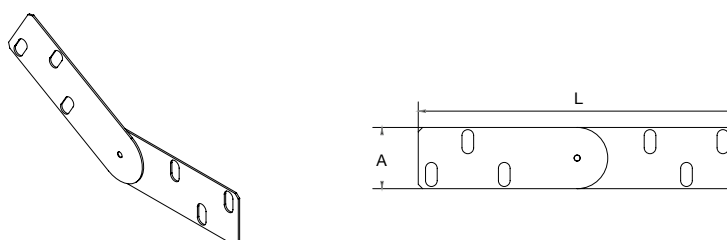

#### . ABA 60 .

G	Código		Medidas LxA(mm)	Peso (Kg)	Volume (m3)	Euros €	
		Q				G	Q
UNA05060FG		UNA05060FQ	240x60	0,148	0,00009	2,70	4,05

### Acessórios

#### Curva

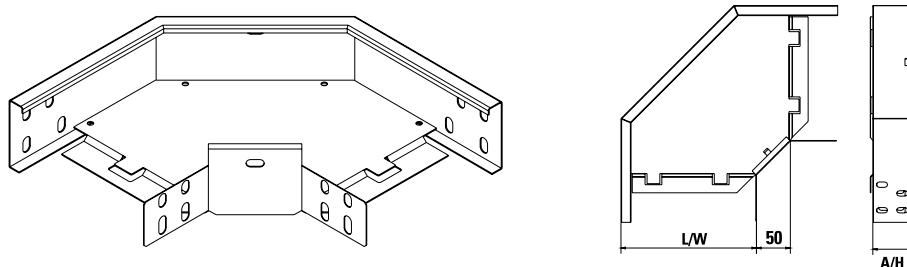

#### CURV

#### . ABA 60 .

G	Código	Q	Largura L(mm)	Peso (Kg)	Volume (m3)	Euros €	
						G	Q
CURV10060FG	CURV10060FQ		100	0,794	0,00361	25,50	38,25
CURV20060FG	CURV20060FQ		200	1,384	0,00892	37,61	56,42
CURV30060FG	CURV30060FQ		300	2,225	0,01590	53,25	79,88

#### Curva a 45°

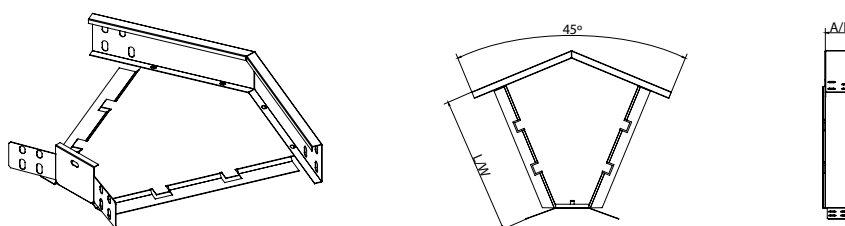

#### CUR45

#### . ABA 60 .

G	Código	Q	Largura L(mm)	Peso (Kg)	Volume (m3)	Euros €	
						G	Q
CUR4510060FG	CUR4510060FQ		100	1,375	-	25,50	38,25
CUR4520060FG	CUR4520060FQ		200	1,475	-	37,61	56,42
CUR4530060FG	CUR4530060FQ		300	1,595	0,01283	53,25	79,88

#### Cruzeta

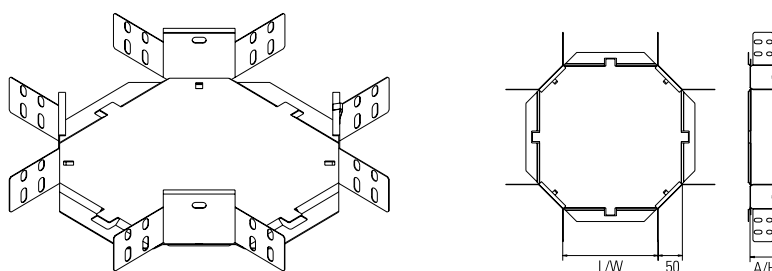

#### CRZT

#### . ABA 60 .

G	Código	Q	Largura L(mm)	Peso (Kg)	Volume (m3)	Euros €	
						G	Q
CRZT10060FG	CRZT10060FQ		100	1,115	-	53,14	79,71
CRZT20060FG	CRZT20060FQ		200	1,836	0,01446	65,17	97,76
CRZT30060FG	CRZT30060FQ		300	2,774	-	82,67	124,01

### Acessórios

#### Derivação "T"

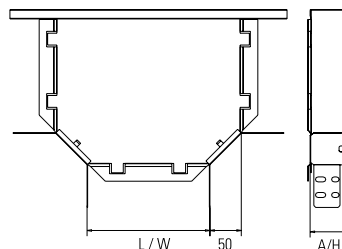
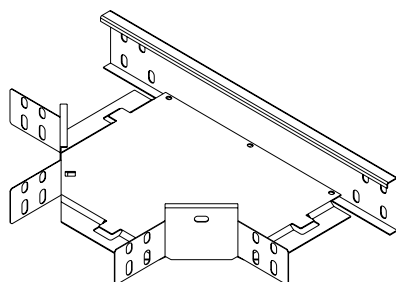

DRV T

FG/FQ

#### . ABA 60 .

G	Código		Largura L(mm)	Peso (Kg)	Volume (m3)	Euros €	
	Q					G	Q
DRV T10060FG	DRV T10060FQ		100	1,074	0,00567	39,47	59,21
DRV T20060FG	DRV T20060FQ		200	1,787	-	52,88	79,32
DRV T30060FG	DRV T30060FQ		300	2,750	0,01691	70,76	106,14

#### Derivação lateral

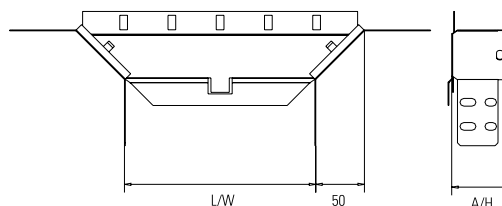
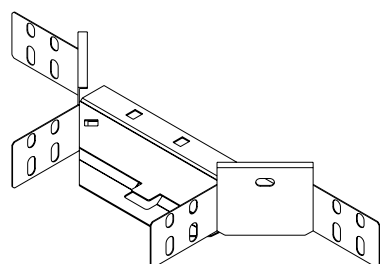

DRV L

#### . ABA 60 .

G	Código		Largura L(mm)	Peso (Kg)	Volume (m3)	Euros €	
	Q					G	Q
DRV L10060FG	DRV L10060FQ		100	0,494	0,00350	39,47	59,21
DRV L20060FG	DRV L20060FQ		200	0,600	-	52,88	79,32
DRV L30060FG	DRV L30060FQ		300	0,700	0,00572	70,76	106,14

#### Canto de derivação lateral dupla

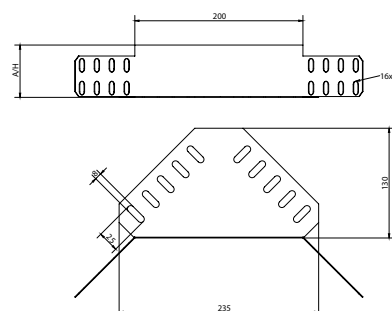
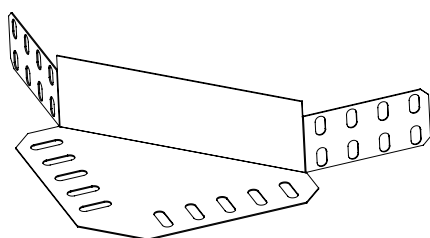

DRV D

#### . ABA 60 .

G	Código		Altura A(mm)	Peso (Kg)	Volume (m3)	Euros €	
	Q					G	Q
DRV D060FG	DRV D060FQ		60	0,462	0,00442	10,87	16,31



### Acessórios

#### Ângulo subida-descida

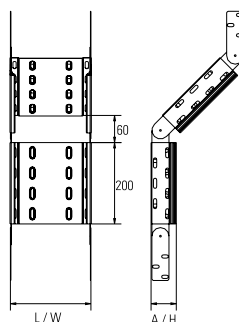
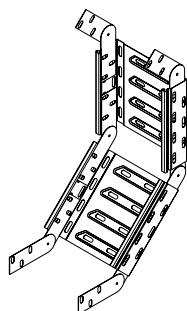

**ANG5**

#### . ABA 60 .

Código		Largura L(mm)	Peso (Kg)	Volume (m3)	Euros €	
G	Q				G	Q
ANGS10060FG	ANGS10060FQ	100	1,300	0,00551	<b>34,63</b>	<b>51,95</b>
ANGS20060FG	ANGS20060FQ	200	2,140	-	<b>37,43</b>	<b>56,15</b>
ANGS30060FG	ANGS30060FQ	300	2,780	-	<b>41,06</b>	<b>61,59</b>

#### Curva ângulo de subida

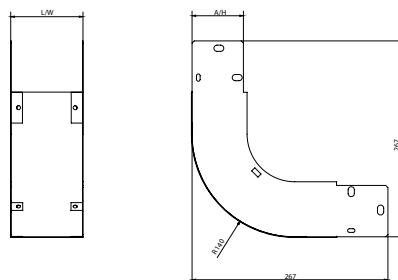
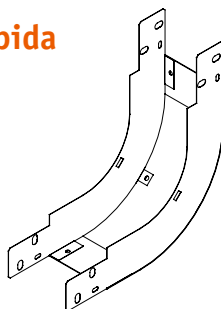

**CAS**

#### . ABA 60 .

Código		Largura L(mm)	Peso (Kg)	Volume (m3)	Euros €	
G	Q				G	Q
CAS10060FG	CAS10060FQ	100	1,018	-	<b>24,60</b>	<b>36,90</b>
CAS20060FG	CAS20060FQ	200	1,618	0,00042	<b>27,50</b>	<b>41,25</b>
CAS30060FG	CAS30060FQ	300	1,815	-	<b>30,55</b>	<b>45,83</b>

#### Curva ângulo de descida

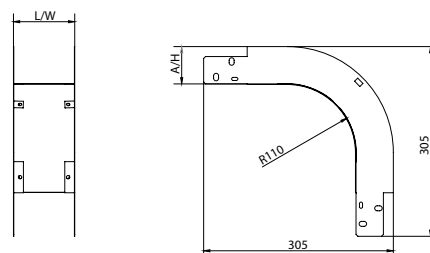
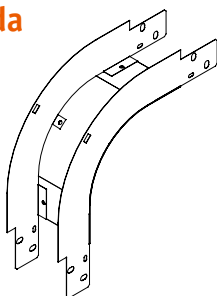

**CAD**

#### . ABA 60 .

Código		Largura L(mm)	Peso (Kg)	Volume (m3)	Euros €	
G	Q				G	Q
CAD10060FG	CAD10060FQ	100	1,078	0,00028	<b>24,60</b>	<b>36,90</b>
CAD20060FG	CAD20060FQ	200	1,429	0,00057	<b>27,50</b>	<b>41,25</b>
CAD30060FG	CAD30060FQ	300	1,783	0,00084	<b>30,55</b>	<b>45,83</b>

### Acessórios

#### Redução simples

RE

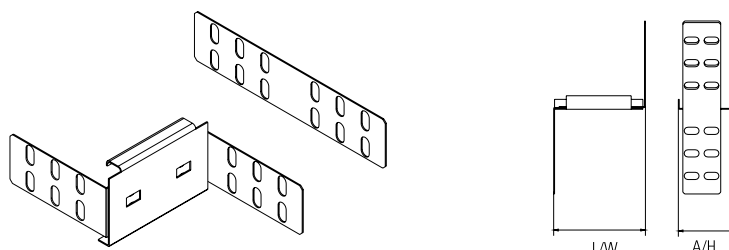

FG/FQ

#### . ABA 60 .

G	Código		Largura L(mm)	Peso (Kg)	Volume (m3)	Euros €	
		Q				G	Q
RE10060FG	RE10060FQ		100	0,436	-	12,36	18,54
RE20060FG	RE20060FQ		200	0,553	-	14,70	22,05

#### Redução direita

RED

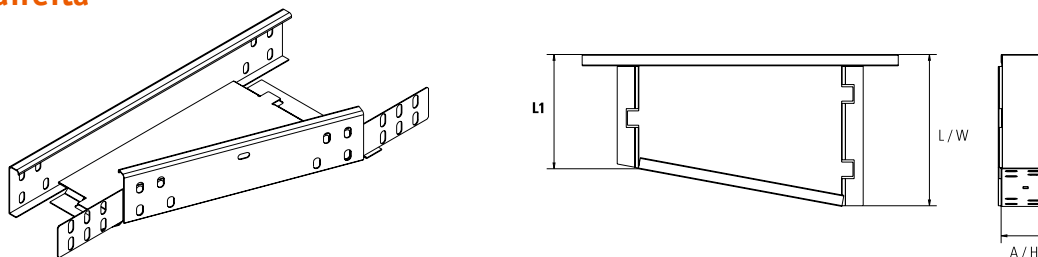

#### . ABA 60 .

G	Código		Largura L(mm)	Peso (Kg)	Volume (m3)	Euros €	
		Q				G	Q
RED200L160FG	RED200L160FQ		200	1,396	0,00665	68,00	93,00
RED300L160FG	RED300L160FQ		300	1,796	0,00960	72,00	108,00

L1 > Medida de redução pretendida

#### Redução esquerda

REE

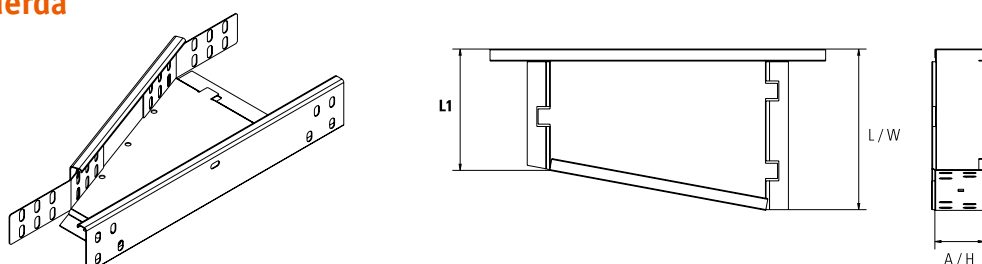

#### . ABA 60 .

G	Código		Largura L(mm)	Peso (Kg)	Volume (m3)	Euros €	
		Q				G	Q
REE200L160FG	REE200L160FQ		200	1,393	0,00665	68,00	93,00
REE300L160FG	REE300L160FQ		300	1,793	0,00960	72,00	108,00

L1 > Medida de redução pretendida

### Acessórios

#### Redução central

**REC**

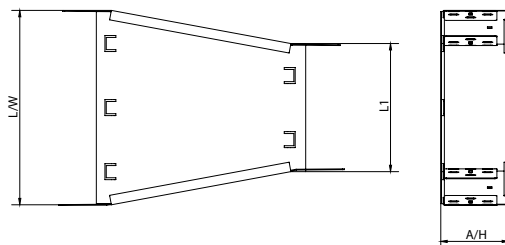
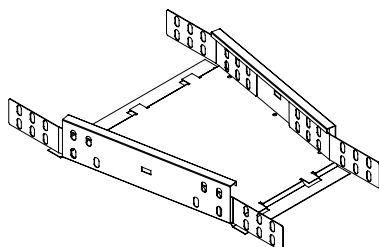

#### . ABA 60 .

G	Código		Largura L(mm)	Peso (Kg)	Volume (m3)	Euros €	
	G	Q				G	Q
REC200L160FG		REC200L160FQ	200	1,593	0,00665	<b>68,00</b>	<b>93,00</b>
REC300L160FG		REC300L160FQ	300	1,893	0,00960	<b>72,00</b>	<b>108,00</b>

#### Topo

**TOP**

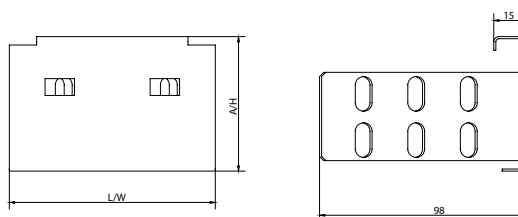
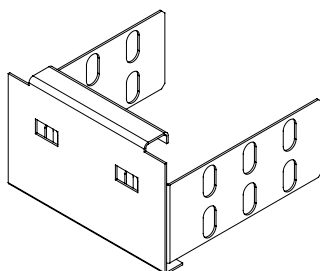

#### . ABA 60 .

G	Código		Largura L(mm)	Peso (Kg)	Volume (m3)	Euros €	
	G	Q				G	Q
TOP10060FG		TOP10060FQ	100	-	-	<b>11,00</b>	<b>16,50</b>
TOP20060FG		TOP20060FQ	200	-	-	<b>12,25</b>	<b>18,38</b>
TOP30060FG		TOP30060FQ	300	-	-	<b>16,00</b>	<b>24,00</b>

#### Separador

**SEPARA**

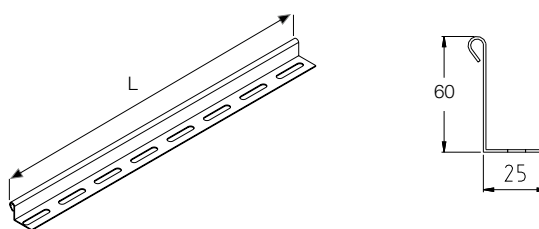
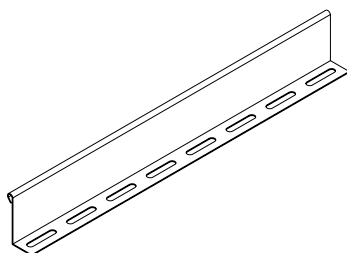

#### . ABA 60 .

G	Código		Comprimento L(mm)	Peso (Kg)	Volume (m3)	Euros €	
	G	Q				G	Q
SEPARA60FG3		SEPARA60FQ3	3000	2,800	0,00389	<b>4,65</b>	<b>6,98</b>

Medida 3m

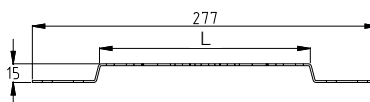
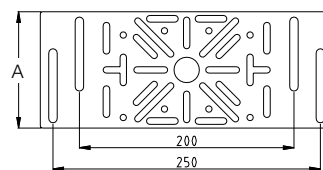
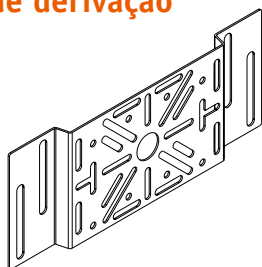
**Acessórios**
**Suporte para caixa de derivação**

**SFP**
**FG/FQ**

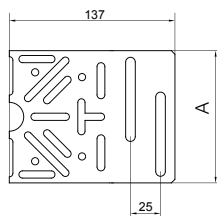
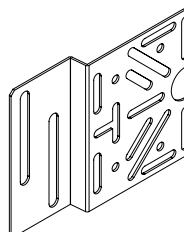
Código		Medidas LxA(mm)	Peso (Kg)	Volume (m3)	Euros €	
G	Q				G	Q
SFP170G	SFP170Q	170x110	7,385	0,00892	4,40	6,60

**Suporte para caixa de derivação**

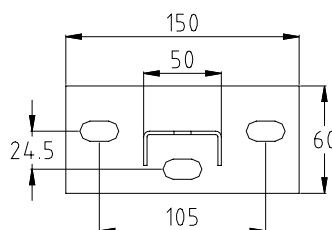
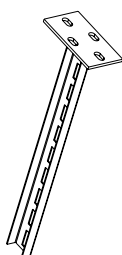
**SFP**

Código		Medidas LxA(mm)	Peso (Kg)	Volume (m3)	Euros €	
G	Q				G	Q
SFP085G	SFP085Q	85x110	-	-	3,40	5,10

**Suporte vertical simples**

**SFT**

Código		Largura L(mm)	Un/Emb.	Peso (Kg)	Volume (m3)	Euros €	
G	Q					G	Q
SFT050G	SFT050Q	500	10	10,105	0,03381	12,15	18,23

### Acessórios

#### Consola horizontal para fixação à parede

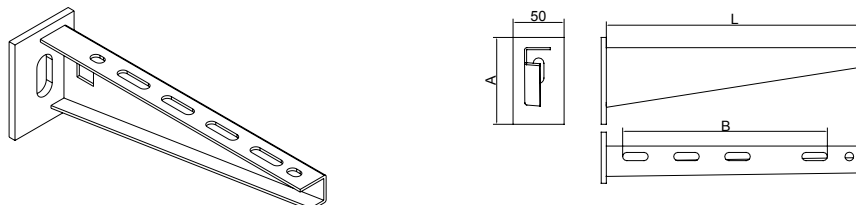
**CHP**



Código		Medidas BxL(mm)	Un/Emb.	Peso (Kg)	Volume (m3)	Euros €	
G	Q					G	Q
CHP100FG	CHP100FQ	100x150	25	6,785	0,00799	7,11	10,67
CHP150FG	CHP150FQ	100x200	25	-	-	8,00	12,00
CHP200FG	CHP200FQ	200x250	25	9,055	0,01234	8,30	12,45
CHP250FG	CHP250FQ	200x300	25	-	-	9,00	13,50
CHP300FG	CHP300FQ	300x350	20	14,565	0,02012	9,80	14,70
CHP350FG	CHP350FQ	300x400	20	-	-	10,50	15,75

Distância mínima entre suportes 1,2m

#### Consola horizontal reforçada para fixação à parede

**CHR**

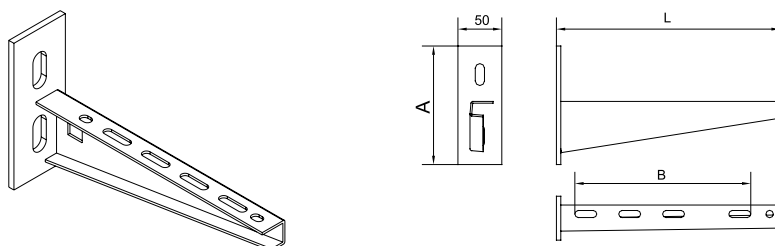

Código		Medidas BxL(mm)	Un/Emb.	Peso (Kg)	Volume (m3)	Euros €	
G	Q					G	Q
CHR100FG	CHR100FQ	100x150	25	-	-	7,68	11,52
CHR150FG	CHR150FQ	100x200	25	-	-	8,50	12,75
CHR200FG	CHR200FQ	200x250	25	-	-	8,97	13,46
CHR250FG	CHR250FQ	200x300	25	-	-	10,00	15,00
CHR300FG	CHR300FQ	300x350	20	-	-	10,58	15,87
CHR350FG	CHR350FQ	300x400	20	-	-	11,50	17,25

Distância mínima entre suportes 1,2m

### Acessórios

#### Consola horizontal para suporte vertical

**CHS**

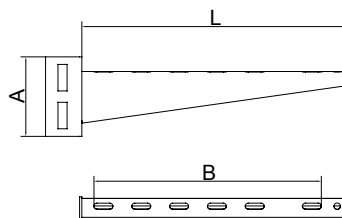
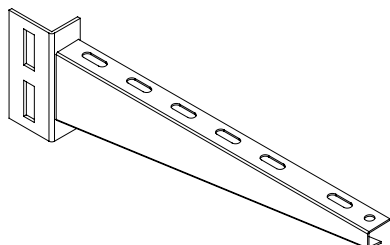

**FG/FQ**

Código		Medidas BxL(mm)	Un/Emb.	Peso (Kg)	Volume (m3)	Euros €	
G	Q					G	Q
CHS100FG	CHS100FQ	100x150	25	-	-	<b>6,82</b>	<b>10,23</b>
CHS200FG	CHS200FQ	200x250	25	-	-	<b>9,08</b>	<b>13,62</b>
CHS300FG	CHS300FQ	300x350	25	-	-	<b>10,75</b>	<b>16,13</b>

Distância mínima entre suportes 1,2m

#### Ângulo de fixação

**AFF**

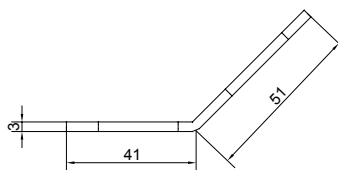
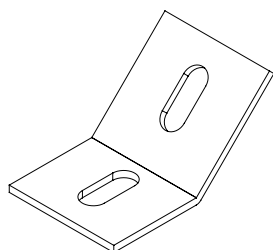

Código		Un/Emb.	Peso (Kg)	Volume (m3)	Euros €	
G	Q				G	Q
AFFM8G	AFFM8Q	25	0,108	0,00001	<b>1,50</b>	<b>2,25</b>

Ângulo de fixação inclui 2 parafusos M8x12 + 2 porcas DIN6923 M8

#### Perfil

**KHA**

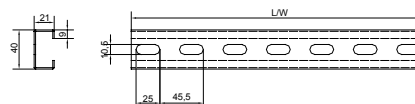
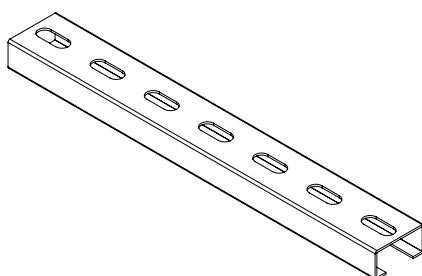

Código		Largura L(mm)	Peso (Kg)	Volume (m3)	Euros €	
G	Q				G	Q
KHA040G	KHA040Q	3000	3,250	0,00265	<b>9,30</b>	<b>13,95</b>

### Acessórios

#### Distanciador para varão

**DVAR**

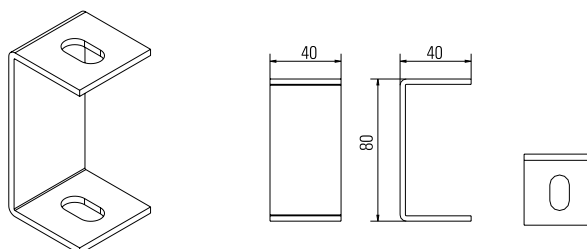

G	Código	Un/Emb.	Peso (Kg)	Volume (m3)	Euros €	
	Q				G	Q
DVAR010G	DVAR010Q	25	3,590	0,00367	<b>2,90</b>	<b>4,35</b>

#### Varão roscado

**VAROSF**

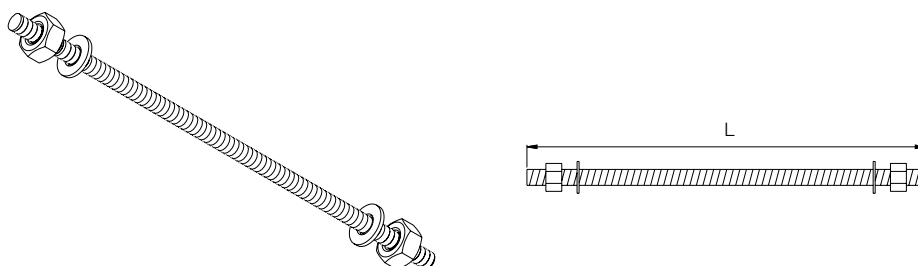

G	Código	Largura L(mm)	Peso (Kg)	Volume (m3)	Euros €	
	Q				G	Q
VAROSFM08	-	1000	-	-	<b>1,60</b>	-
VAROSFM10	-	1000	-	-	<b>2,75</b>	-

#### Bucha de fixação

**BUC**

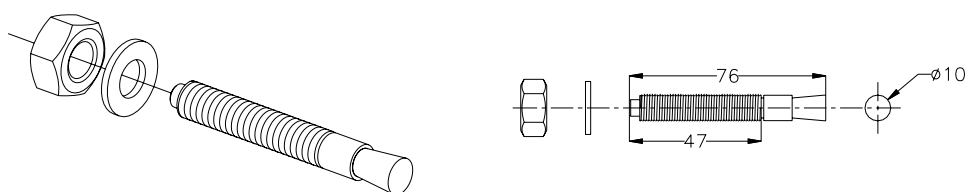

G	Código	Un/Emb.	Peso (Kg)	Volume (m3)	Euros €	
	Q				G	Q
BUCM0860	-	50	1,350	0,00126	<b>0,96</b>	-
BUCM1080	-	50	-	-	<b>1,20</b>	-

Notas



Notas

---

---

---

---

---

---

---

---

---

---

---

---

---

---

---



**INDELAGUE™**

Rua Quinta do Neves - Covão / 3750-792 Trofa / Portugal  
T.+351 234 612 310  
F.+351 234 624 058

[indelague@indelague.pt](mailto:indelague@indelague.pt)

[www.indelague.com](http://www.indelague.com)