

SIRCO

125 to 4000 A

sirco_296_a_1_cat



sirco_300_b

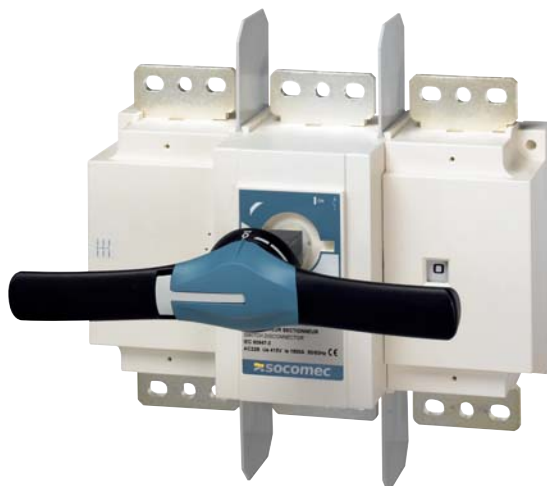

sirco_313_a_1_cat

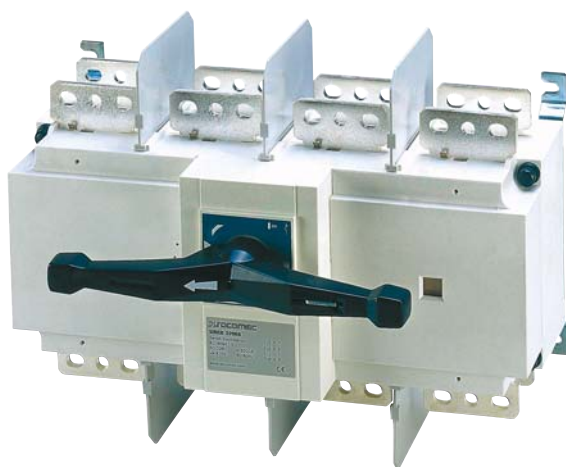

Functions

References

Accessories

Enclosed load break switches

Characteristics

Dimensions

Functions

SIRCO switches are manually operated or motorised multipolar load break switches. They break on and off under load and provide safety isolation for any low voltage circuit.

Conformity to standards

- IEC 60947-3
- EN 60947-3
- VDE 0660 - 107 (1992)
- NBN EN 60947-3
- BS EN 60947-3

Approvals and certifications⁽¹⁾

- Bureau Veritas
- Lloyd's Register of Shipping
- CEBEC (Belgium)
- FI (Finland)
- ASEFA
- KEMA
- CCA
- GOST (Russia)
- BBJ Poland (attestation of verification)
- PSA E03.15.605.G
- RENAULT EB03.15.613

(1) In progress for certain ratings.

General characteristics

- Fully visible breaking.
- High thermal and dynamic withstand.
- Arduous utilisation categories (AC-22 and AC-23).
- Good electrical and mechanical endurance.
- High resistance to humidity (supplied "tropicalised").

Available on request

- Early break auxiliaries.
- SIRCO 9 and 12 poles up to 1600 A.
- 3 pole + solid neutral.
- Early break advanced neutral for networks charged with harmonics.
- Conducting neutral.
- Neutral earthing stud.
- Connection terminals bolts not supplied from 800 to 4000 A.
- Double rated Neutral.



Illustrations

Front operation

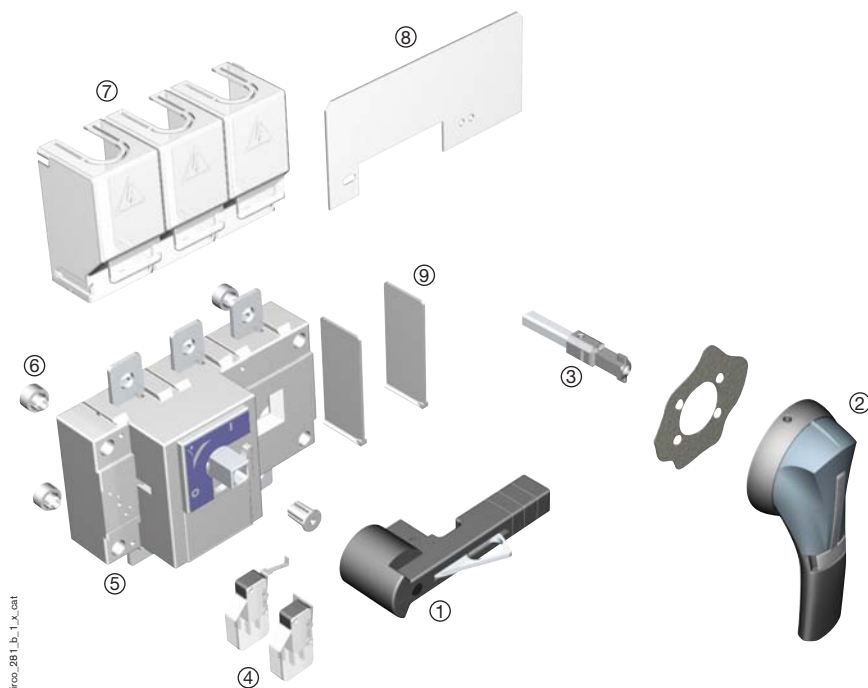

Overview (for further details, please see the installation instructions supplied with each device).

1. Direct front handle.
2. Door interlocked external handle.
3. Shaft extension.
4. IP2 Auxiliary contacts.
5. Switch body only.
6. Spacers.
7. Terminal shrouds.
8. Shrouded distribution block.
9. Inter phase barrier.

External right-side operation (consult us)

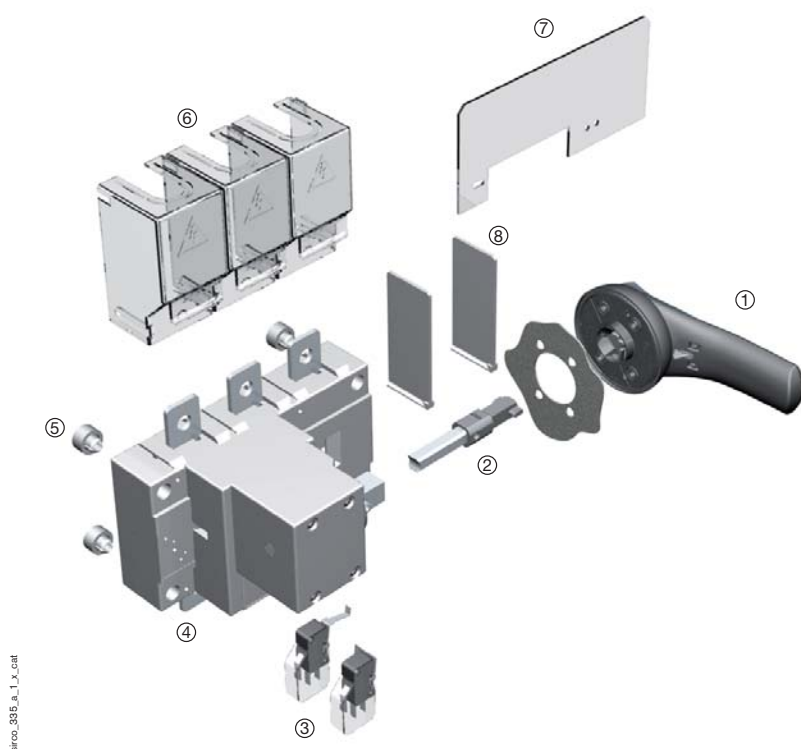

1. Door interlocked external right-side handle.
2. Shaft extension.
3. IP2 auxiliary contacts.
4. Switch body only.
5. Spacers.
6. Terminal shrouds.
7. Shrouded distribution block.
8. Inter phase barrier.

SIRCO

125 to 4000 A

Functions

References

Accessories

Enclosed load break switches

Characteristics

Dimensions

References

► Front operation 3 and 4 pole



Rating (A)	No. of poles	Switch body only	Direct handle	Door interlocked external handle	Shaft extensions for external handle	Auxiliary contacts	Terminal shrouds	Terminal screens	
125	3 P	2600 3014 ⁽¹⁾	Black* 2699 5042	S2 type Black IP55* 1421 2111 Black IP65 1423 2111 Red IP65 1424 2111	200 mm 1400 1020 320 mm* 1400 1032 500 mm 1400 1050	1 st NO/NC contact 2699 0031	3 P 2694 3014 ⁽²⁾⁽³⁾	3 P 2698 3012 ⁽²⁾⁽⁴⁾	
	4 P	2600 4014 ⁽¹⁾					4 P 2694 4014 ⁽²⁾⁽³⁾	P 2698 4012 ⁽²⁾⁽⁴⁾	
160	3 P	2600 3017 ⁽¹⁾	Red 2699 5043				3 P 2694 3021 ⁽²⁾⁽³⁾	3 P 2698 3020 ⁽²⁾⁽⁴⁾	
	4 P	2600 4017 ⁽¹⁾							4 P 2694 4021 ⁽²⁾⁽³⁾
200	3 P	2600 3021	Black* 2699 5052 Red 2699 5053				4 P 2694 4021 ⁽²⁾⁽³⁾	4 P 2698 4020 ⁽²⁾⁽⁴⁾	
	4 P	2600 4021							
250	3 P	2600 3026 ⁽¹⁾					2 nd NO/NC contact 2699 0032	3 P 2694 3051 ⁽²⁾⁽³⁾	3 P 2698 3050 ⁽²⁾⁽⁴⁾
	4 P	2600 4026 ⁽¹⁾							
315	3 P	2600 3032				3 P 2694 3051 ⁽²⁾⁽³⁾	3 P 2698 3050 ⁽²⁾⁽⁴⁾		
	4 P	2600 4032							
400	3 P	2600 3041 ⁽¹⁾				Red 2699 5053	4 P 2694 4051 ⁽²⁾⁽³⁾	4 P 2698 4050 ⁽²⁾⁽⁴⁾	
	4 P	2600 4041 ⁽¹⁾							
500	3 P	2600 3051 ⁽¹⁾				3 P 2694 3051 ⁽²⁾⁽³⁾	3 P 2698 3050 ⁽²⁾⁽⁴⁾		
	4 P	2600 4051 ⁽¹⁾							
630	3 P	2600 3064 ⁽¹⁾				3 P 2694 3051 ⁽²⁾⁽³⁾	3 P 2698 3050 ⁽²⁾⁽⁴⁾		
	4 P	2600 4064 ⁽¹⁾							

* Standard.

(1) Available enclosed (see page A.37 and A.38 "Enclosed load break switches").

(2) Top or bottom.

(3) 2 sets required to shroud top and bottom terminals on 3/4 pole switch.

(4) Order 2 references to shield top and bottom terminals.

For more informations: see "Accessories" pages.

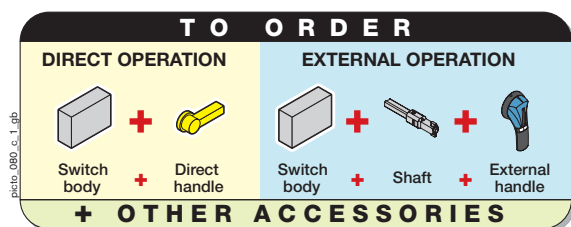

Load break switches
SIRCO



References

► Front operation 3 and 4 pole



Rating (A)	No. of poles	Switch body only	Direct handle	Door interlocked external handle**	Shaft extensions for external handle**	Auxiliary contacts	Terminal screens			
800	3 P	2600 3081 ⁽¹⁾	Black* 2799 7012	S4 type Black IP65* 1443 3111	200 mm 1401 1520	1 st NO/NC contact 2699 0031	3 P 2698 3080 ⁽²⁾⁽³⁾			
	4 P	2600 4081 ⁽¹⁾					4 P 2698 4080 ⁽²⁾⁽³⁾			
1000	3 P	2600 3099 ⁽¹⁾					Red IP65 1444 3111	320 mm* 1401 1532	2 nd NO/NC contact 2699 0032	3 P 2698 3120 ⁽²⁾⁽³⁾
	4 P	2600 4099 ⁽¹⁾								
CD 1250	3 P	2600 3119					Red 2799 7013	Black IP65* 2799 7136	320 mm* 2799 3015	4 P 2698 4200 ⁽²⁾⁽³⁾
	4 P	2600 4119								
1250	3 P	2600 3121 ⁽¹⁾		Red IP65 2799 7134	200 mm 2799 3018	320 mm* 2799 3018	4 P 2698 4200 ⁽²⁾⁽³⁾			
	4 P	2600 4121 ⁽¹⁾								
1600	3 P	2600 3161		Black IP65* 2799 7145	320 mm* 2799 3018	320 mm* 2799 3018	included	included		
	4 P	2600 4161								
1800	3 P	2600 3181	Red 2799 7062	Black IP65* 2799 7145	320 mm* 2799 3018	included	included			
	4 P	2600 4181								
2000	3 P	2600 3200	Black IP65* 2799 7145	320 mm* 2799 3018	320 mm* 2799 3018	included	included			
	4 P	2600 4200								
2500	3 P	2600 3250	Red IP65 2799 7134	200 mm 2799 3015	320 mm* 2799 3018	included	included			
	4 P	2600 4250								
3200	3 P	2600 3320	Red IP65 2799 7134	200 mm 2799 3015	320 mm* 2799 3018	included	included			
	4 P	2600 4320								
4000	3 P	2600 3400	Black* 2799 7062	Black IP65* 2799 7145	320 mm* 2799 3018	included	included			
	4 P	2600 4400								

* Standard.

** S type handle not suitable for SIRCO 2000 to 4000 A ratings.

(1) Available enclosed (see page A.37 and A.38 "Enclosed load break switches").

(2) Top or bottom.

(3) Order 2 references to shield top and bottom terminals.

For more informations: see "Accessories" pages.

SIRCO

125 to 4000 A

Functions

References

Accessories



Enclosed load break switches

Characteristics

Dimensions

References

► Front operation 6 and 8 pole

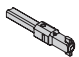
Rating (A) ⁽¹⁾	No. of poles ⁽¹⁾	Switch body only	Direct handle	Door interlocked external handle	Shaft extensions for external handle	Auxiliary contact	Terminal shrouds	Terminal screens											
125	6 P	2601 6013	Black* 4199 5012	S2 type Black IP55* 1421 2111	200 mm* 1400 1020		6 P 2694 3014 ⁽¹⁾⁽²⁾	6 P 1509 3012 ⁽¹⁾											
	8 P	2601 8013																	
160	6 P	2601 6016		Red/Yellow IP65 1424 2111	320 mm 1400 1032		8 P 2694 4014 ⁽¹⁾⁽²⁾	8 P 1509 4012 ⁽¹⁾											
	8 P	2601 8016																	
250	6 P	2601 6025	Black* 2799 7052			1 st NO/NC contact 2699 0061	2694 3021 ⁽¹⁾⁽²⁾	1509 3025 ⁽¹⁾											
	8 P	2601 8025					2694 4021 ⁽¹⁾⁽²⁾	1509 4025 ⁽¹⁾											
400	6 P	2601 6040					Red 2799 7053	S3 type Black IP65* 1433 3111	200 mm 1401 1520	2 nd NO/NC contact 2699 0062	6 P 2694 3051 ⁽¹⁾⁽²⁾	6 P 1509 3063 ⁽¹⁾							
	8 P	2601 8040																	
630	6 P	2601 6063	8 P 2694 4051 ⁽¹⁾⁽²⁾	8 P 1509 4063 ⁽¹⁾															
	8 P	2601 8063																	
800	6 P	2601 6080	/	Red/Yellow IP65 1434 3111	320 mm* 1401 1532			6 P 1509 3080 ⁽¹⁾											
	8 P	2601 8080										8 P 1509 4080 ⁽¹⁾							
1000	6 P	2601 6100											Black* 2799 7012						
	8 P	2601 8100										8 P 1509 4080 ⁽¹⁾							
1250	6 P	2601 6120																Red 2799 7013	
	8 P	2601 8120										8 P 1509 4080 ⁽¹⁾							
1600	6 P	2601 6160											1509 3160 ⁽¹⁾						
	8 P	2601 8160																	

* Standard.

(1) Top or bottom.

(2) 4 sets required to shroud top and bottom terminals on 6/8 pole switch.

For more informations : see "Accessories" pages.

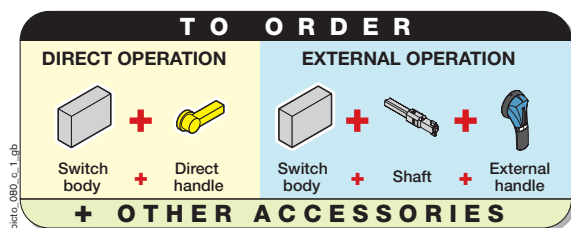

Accessories

Direct handle



References

Rating (A)	No. of poles	Handle colour	References
125 ... 160	3/4 P	Black	2699 5042
125 ... 160	6/8 P	Black	4199 5012
125 ... 160	3/4 P	Red	2699 5043
200 ... 630	3/4 P	Black	2699 5052
200 ... 630	3/4 P	Red	2699 5053
250 ... 630	6/8 P	Black	2799 7052
250 ... 630	6/8 P	Red	2799 7053
800 ... 3200	3/4 P	Black	2799 7012
800 ... 3200	3/4 P	Red	2799 7013
800 ... 1600	6/8 P	Black	2799 7012
800 ... 1600	6/8 P	Red	2799 7013
4000	3/4 P	Black	2799 7062
4000	3/4 P	Red	2799 7063

Door interlocked external handle



Use

The door interlocked external operation includes a padlockable handle, an escutcheon and must be combined with a shaft extensions.



References

Rating (A)	No. of poles	Handle type	Handle colour	External IP ⁽¹⁾	References
125 ... 630	3/4 P	S2	Black	IP55	1421 2111
125 ... 630	3/4 P	S2	Black	IP65	1423 2111
125 ... 630	3/4 P	S2	Red/Yellow	IP65	1424 2111
125 ... 160	6/8 P	S2	Black	IP55	1421 2111
125 ... 160	6/8 P	S2	Black	IP65	1423 2111
125 ... 160	6/8 P	S2	Red/Yellow	IP65	1424 2111
250 ... 1600	6/8 P	S3	Black	IP65	1433 3111
250 ... 1600	6/8 P	S3	Red/Yellow	IP65	1434 3111
800 ... 1800	3/4 P	S4	Black	IP65	1443 3111
800 ... 1800	3/4 P	S4	Red/Yellow	IP65	1444 3111
2000 ... 3200	3/4 P	V	Black	IP65	2799 7136
2000 ... 3200	3/4 P	V	Red	IP65	2799 7134
4000	3/4 P	V	Black	IP65	2799 7145
4000	3/4 P	-	Red		consult us

(1) IP: protection rating according to IEC 60529 standard.

S-type handle adapter



Use

Enables new S type handles to be mounted using old fixing holes for replacement or retrofit applications.

Dimensions

Adds 12 mm to the depth.

Référence

Colour	External IP ⁽¹⁾	Pack qty	Référence
Black	IP65	10	1493 0000

(1) IP: protection rating according to IEC 60529 standard.

SIRCO

125 to 4000 A

Functions

References

Accessories

Enclosed load break switches

Characteristics

Dimensions

Accessories

Alternative S-type handle cover colours



Use

For single lever handles S2, S3-type and for double lever handles S4-type.
Other colours: please consult us.

References

Colour	Pack qty	Handle type	References
Light grey	50	S2, S3	1401 0001
Dark grey	50	S2, S3	1401 0011
Light grey	50	S4	1401 0031
Dark grey	50	S4	1401 0041

Shaft extensions for external handle

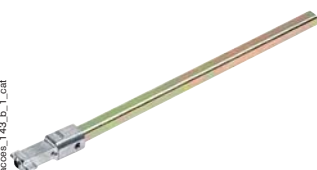

Use

Standard length:

- 200 mm,
- 250 mm,
- 300 mm,
- 400 mm,
- 500 mm,
- 750 mm.

Other lengths: please consult us.

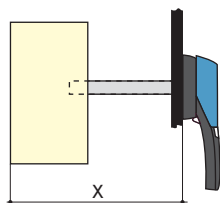

References

For 3/4 pole

Rating (A)	Dimension X (mm)	Shaft length (mm)	References
125 ... 160	125 ... 250	200	1400 1020
125 ... 160	125 ... 300	250	1400 1025
125 ... 160	125 ... 370	320	1400 1032*
125 ... 160	125 ... 550	500	1400 1050
125 ... 160	125 ... 850	750	1400 1075
200 ... 250	135 ... 265	200	1400 1020
200 ... 250	135 ... 315	250	1400 1025
200 ... 250	135 ... 385	320	1400 1032*
200 ... 250	135 ... 565	500	1400 1050
200 ... 250	135 ... 880	750	1400 1075
315 ... 630	165 ... 295	200	1400 1020
315 ... 630	165 ... 345	250	1400 1025
315 ... 630	165 ... 415	320	1400 1032*
315 ... 630	165 ... 595	500	1400 1050
315 ... 630	165 ... 940	750	1400 1075
800 ... 1800	221 ... 343	200	1401 1520
800 ... 1800	221 ... 463	320	1401 1532*
800 ... 1800	221 ... 543	400	1401 1540
2000 ... 3200	415 ... 570	200	2799 3015
2000 ... 3200	415 ... 690	320	2799 3018*
2000 ... 3200	415 ... 820	450	2799 3019
4000	651 ... 921	320	2799 3018*

For 6/8 pole

Rating (A)	Dimension X (mm)	Shaft length (mm)	References
125 ... 160	270 ... 436	200	1400 1020
125 ... 160	270 ... 556	320	1400 1032*
250	221 ... 308	200	1401 1520
250	221 ... 428	320	1401 1532*
250	221 ... 508	400	1401 1540
400 ... 1600	298 ... 385	200	1401 1520
400 ... 1600	298 ... 505	320	1401 1532*

* Standard.



Accessories

Auxiliary contacts

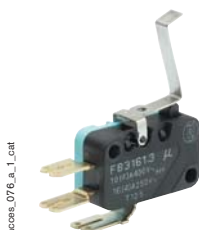

Use

Pre-break and signalling of positions 0 and I:

- 1 to 2 NO/NC auxiliary contacts,
- 1 to 4 NO + NC auxiliary contacts,
- 1 to 2 low level NO/NC auxiliary contacts.

Characteristics

NO/NC AC: IP2 with front operation.

Connection to the control circuit
6.35 mm fast-on connection.

Electrical characteristics
30 000 operations.

References

NO/NC contacts for 3/4 pole

Rating (A)	No. of AC	References
125 ... 3200	1 st	2699 0031
125 ... 3200	2 nd	2699 0032
4000	1 st	included
4000	2 nd	included

NO/NC contacts for 6/8 pole

Rating (A)	No. of AC	References
125 ... 1600	1 st	2699 0061
125 ... 1600	2 nd	2699 0062

NO + NC contacts for 3/4 pole

Rating (A)	No. of AC	References
125 ... 3200	1 st	2699 0141
125 ... 3200	2 nd	2699 0142

Low level NO/NC contacts for 3/4 pole

Rating (A)	No. of AC	References
125 ... 1800	1 st	2699 0301
125 ... 1800	2 nd	2699 0302

Characteristics

Rating (A)	Contact type	Nominal current (A)	Operating current I _g (A)									
			230 VAC		400 VAC		24 VDC			48 VDC		
			AC-12	AC-13/15	AC-12	AC-13/15	DC-12	DC-13	DC-14	DC-12	DC-13	DC-14
125 ... 4000	NO/NC	16	16	4	12	3	2.5	2.5	1	2.5	1.2	0.2
125 ... 3200	NO+NC	16	16	4	16	3	16	5	1	2.5	1.2	0.2

Door mounting kit

Use

Kit enables door mounting facility for the SIRCO range.

References

For 3/4 pole direct front operation

Rating (A)	No. of poles	References
125 ... 160	3 P	2699 3312
125 ... 160	4 P	2699 4312
200 ... 250	3 P	2699 3420
200 ... 250	4 P	2699 4420

Terminal shrouds



Use

Top or bottom protection against direct contact with terminals or connection parts.

Advantage

Perforations allowing remote thermographic inspection without removal.

The terminal shrouds also provide phase separation SIRCOs from 125 to 630 A.

References

Rating (A)	No. of poles	Position	References
125 ... 160	3/6 P	top or bottom	2694 3014 ⁽¹⁾⁽²⁾
125 ... 160	4/8 P	top or bottom	2694 4014 ⁽¹⁾⁽²⁾
200 ... 250	3/6 P	top or bottom	2694 3021 ⁽¹⁾⁽²⁾
200 ... 250	4/8 P	top or bottom	2694 4021 ⁽¹⁾⁽²⁾
315 ... 630	3/6 P	top or bottom	2694 3051 ⁽¹⁾⁽²⁾
315 ... 630	4/8 P	top or bottom	2694 4051 ⁽¹⁾⁽²⁾

(1) 2 sets required to shroud top and bottom terminals on 3/4 pole switch.
(2) 4 sets required to shroud top and bottom terminals on 6/8 pole switch.

SIRCO

125 to 4000 A

Functions

References

Accessories

Enclosed load break switches

Characteristics

Dimensions

Accessories

Terminal screens



accres_079_a_1_cat

Use

Top or bottom protection against direct contacts with terminals or connection parts.

References

For 3/4 pole

Rating (A)	No. of poles	Position	References
125 ... 160	3 P	top or bottom	2698 3012 ⁽¹⁾
125 ... 160	4 P	top or bottom	2698 4012 ⁽¹⁾
200 ... 250	3 P	top or bottom	2698 3020 ⁽¹⁾
200 ... 250	4 P	top or bottom	2698 4020 ⁽¹⁾
315 ... 630	3 P	top or bottom	2698 3050 ⁽¹⁾
315 ... 630	4 P	top or bottom	2698 4050 ⁽¹⁾
800 ... CD 1250	3 P	top or bottom	2698 3080 ⁽¹⁾
800 ... CD 1250	4 P	top or bottom	2698 4080 ⁽¹⁾
1250 ... 1800	3 P	top or bottom	2698 3120 ⁽¹⁾
1250 ... 1800	4 P	top or bottom	2698 4120 ⁽¹⁾
2000 ... 3200	3 P	top or bottom	2698 3200 ⁽¹⁾
2000 ... 3200	4 P	top or bottom	2698 4200 ⁽¹⁾
4000	3/4 P	top and bottom	included

(1) Order 2 references to shield top and bottom terminals.

For 6/8 pole

Rating (A)	No. of poles	Position	References
125 ... 160	6 P	top or bottom	1509 3012
125 ... 160	8 P	top or bottom	1509 4012
250	6 P	top or bottom	1509 3025
250	8 P	top or bottom	1509 4025
400 ... 630	6 P	top or bottom	1509 3063
400 ... 630	8 P	top or bottom	1509 4063
800 ... 1250	6 P	top or bottom	1509 3080
800 ... 1250	8 P	top or bottom	1509 4080
1600	6 P	top or bottom	1509 3160
1600	8 P	top or bottom	1509 4160

Shrouded distribution block



repair_027_a_2_cat

Use

Easy connection of several cables, can be clipped onto a symmetric DIN rail.

References

Rating (A)	No. of poles	No of feeders per section (mm ²)	References
125	3/4 P	2 x 25 + 7 x 10	5420 4108
125	3/4 P	2 x 25 + 2 x 16 + 9 x 10	5420 4112
160	3/4 P	1 x 35 + 3 x 25 + 8 x 16	5420 4016

Bottom distribution kit

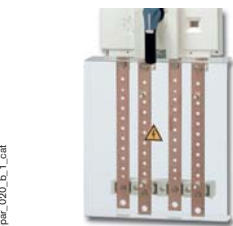

repair_020_b_1_cat

Use

Easy connection of several equipotential conductors, mounted top of the SIRCO.

References

Rating (A)	No. of poles	No of feeders per section (mm ²)	References
125 ... 160	3 P	1 x 95 + 8 x 25	5411 3016
125 ... 160	4 P	1 x 95 + 8 x 25	5411 4016
200 ... 250	3 P	1 x 150 + 8 x 50	5411 3025
200 ... 250	4 P	1 x 150 + 8 x 50	5411 4025
315 ... 400	3 P	1 x 240 + 8 x 95	5411 3040
315 ... 400	4 P	1 x 240 + 8 x 95	5411 4040
500 ... 630	3 P	1 x 300 + 8 x 150	5411 3063
500 ... 630	4 P	1 x 300 + 8 x 150	5411 4063



Accessories

Cage terminals



Use

Connection of bare copper cables onto the terminals (without terminal lugs).

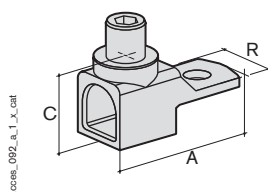
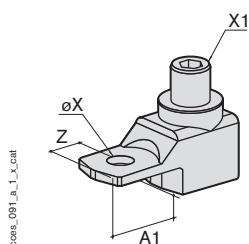

References

Rating (A)	No. of poles	References
125 ... 160	3 P	5400 3016
125 ... 160	4 P	5400 4016
200 ... 250	3 P	5400 3025
200 ... 250	4 P	5400 4025
315 ... 400	3 P	5400 3040
315 ... 400	4 P	5400 4040
500 ... 630	3 P	5400 3063
500 ... 630	4 P	5400 4063

Connections

Rating (A)	Section flexible cable (mm ²)	Section rigid cable (mm ²)	Width flexible bar (mm)	Stripped over (mm)
125 ... 160	16 ... 95	16 ... 95	13	22
200 ... 250	16 ... 185	16 ... 185	18	27
315 ... 400	50 ... 240	50 ... 300	20	34
500 ... 630	70 ... 300	70 ... 300	24	34

Dimensions

Rating (A)	A	A1	C	R	ØX	X1	Z
125 ... 160	47.5	22.5	25	20	8.5	M12	10
200 ... 250	62	31.5	31.5	25	10.5	M16	14
315 ... 400	71.5	32	38	32	10.5	M20	15
500 ... 630	76.5	37	38	40	12.5	M20	15

Copper bars connection kits

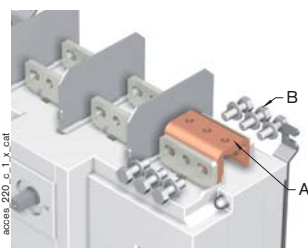

Fig.1

Use

To allow connection between the two power terminals from a same pole for 2000 to 3200 A ratings (Fig. 1 and Fig 2).

For 3200 A rating, the connection piece (part A) are delivered bridged from factory. Bolt sets must be ordered separately.

Dimensions

See page A.43, for connection kit assembly.

Technical notice for these specific accessories is downloadable from www.socomec.com

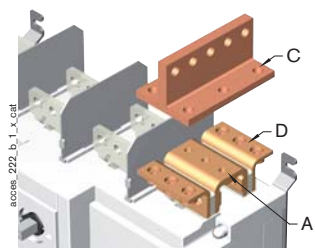

Fig.2

References

Top or bottom flat connection - Fig. 1

Rating (A)	Part	Qty to order per pole ⁽¹⁾	References
2000 ... 2500	Connection piece - part A	1	2619 1200
2000 ... 2500	Bolt set - part B	1	2699 1200
3200	Connection piece - part A	/	standard
3200	Bolt set - part B	1	2699 1200

(1) Example for 3-pole device: order 3 times the quantities.

Top or bottom edgewise connection - Fig. 2

Rating (A)	Part	Qty to order per pole ⁽¹⁾	References
2000 ... 2500	Connection piece - part A	1	2619 1200
2000 ... 2500	T piece - part C	1	2629 1200 ⁽²⁾
2000 ... 2500	Right angle - part D	2	2639 1200 ⁽²⁾
3200	Connection piece - part A	/	standard
3200	T piece - part C	1	2629 1200 ⁽²⁾
3200	Right angle - part D	2	2639 1200 ⁽²⁾

(1) Example for 3-pole device equipped top only: order 3 times the quantities.

(2) Bolt set is provided with the accessories.

SIRCO

125 to 4000 A

Functions

References

Accessories

Enclosed load break switches

Characteristics

Dimensions

Accessories

Inter phase barriers



Use

Safety isolating separation between the terminals, essential for use at 690 VAC or in a polluted or dusty atmosphere. The terminal shrouds also provide phase separation for SIRCOs from 125 to 630 A.

References

Rating (A)	No. of poles	References
125 ... 160	3 P	2998 0033
125 ... 160	4 P	2998 0034
200 ... 250	3 P	2998 0023
200 ... 250	4 P	2998 0024
315 ... 630	3 P	2998 0013
315 ... 630	4 P	2998 0014
800 ... 3200	3/4 P	included

Handle key interlocking accessories

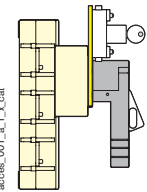

Fig. 1

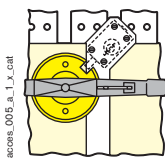

Fig. 2

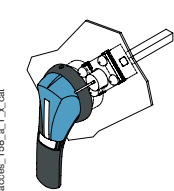

Fig. 3

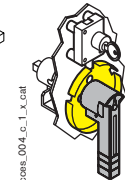

Fig. 4

Use

Locking in position 0 of the front operation handle:

- using a padlock (not supplied) and factory integrated into the handle. From 125 to 1800 A, the padlock on the external front operation handle also locks the door,
- using lock (not included): see diagrams opposite,
- using undervoltage coil: the SIRCO can only be closed if the coil is live.

For 6/8 pole, please consult us.

References

Locking using RONIS EL11AP lock (not included)

Rating (A)	No. of poles	Operation	Figure	References
125 ... 630	3/4 P	direct front	1	2699 6008 ⁽¹⁾
125 ... 1800	3/4 P	external front	3	1499 7701
800 ... 3200	3/4 P	direct front	2	2699 6027
2000 ... 4000	3/4 P	external front	4	2799 7002
4000	3/4 P	direct front	2	2699 7017

Locking using CASTELL lock (not included)

Rating (A)	No. of poles	Operation	Lock type	Figure	References
125 ... 1800	3/4 P	external front	FS	3	1499 7703
125 ... 1800	3/4 P	external front	K	3	1499 7702
2000 ... 4000	3/4 P	external front	K	2	2799 7003
125 ... 160	6/8 P	external front	K	2	4109 8507
250 ... 630	6/8 P	external front	K	2	2999 8707
800 ... 1600	6/8 P	external front	K	2	2799 7003

Locking using 230 VAC undervoltage coil (other voltages: please consult us)

Rating (A)	No. of poles	Operation	References
125 ... 630	3/4 P	external front	2699 9063 ⁽²⁾
800 ... 3200	3/4 P	direct front	2699 9315 ⁽²⁾

(1) Front operation handle included.

(2) The locking system is mounted directly on the device.



Accessories

Other specific accessories



bd_03_04_01

- Mechanical coupling device for making switches with “n” poles with the same or different ratings.
- Mechanical interlocking device.

Enclosed load break switches

Steel enclosure for front operation



codf_295_a_1_cat

General characteristics

- Adapted to mechanical risk and dust hazard.
- S-type black handle lockable in position 0.
- Protection degree: IP55 / Ik 10 (IP65 on request).
- Colour: polyester powder RAL 7032.
- Gland plates: top and bottom.
- Material: XC steel, thickness 1.5 to 2 mm.
- Coating: epoxy polyester powder.
- Wall mounting: 4 holes in the back of the casing.
- Door: solid with hinges.
- Locking system: 3 mm double-bar key (key supplied).
- Miscellaneous: 2 earth connection points, disconnectable solid neutral link for 3+N, extension boxes for top and/or bottom connections available, IP20 incoming terminal shrouds.

Please consult us.

SIRCO

125 to 4000 A

Functions
References
Accessories

Enclosed load break switches
Characteristics
Dimensions

Enclosed load break switches

Polyester enclosure for front operation



Functions

- Emergency breaking.
- Breaking for mechanical maintenance.
- Safety isolation in the vicinity of any low voltage final circuit.

Conformity to standards

- IEC 60364
- EN 60204-1
- EN 60439
- EN 60695-2-11

General characteristics

- Adapted to chemical attack, dust hazard, contamination hazard and atmospheric corrosion.
- S-type black handle lockable in position 0.
- Protection degree: IP55 (IP65 on request).
- Colour: RAL 7030.
- Gland plates: none.
- Material: glass fibre reinforced polyester.
- Coating: none.
- Wall mounting: 4 fixing lugs supplied, not mounted.
- Locking system: screws.
- Miscellaneous: high comparative tracking index, high resistance to chemicals, self-extinguishing at 960°C, 2 earth connection points, connection on top switch via a set of descending bars.

Accessories

- Auxiliary contacts (see page A.33).
- Terminal shrouds (see page A.33).

Connection

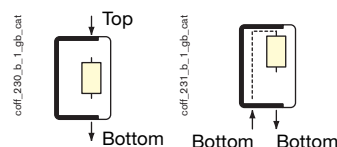

References (1)(2)

Rating (A)	No. of poles	Reference	Reference
125	3 P	3115 3012	3125 3012
125	4 P	3115 4012	3125 4012
160	3 P	3115 3016	3125 3016
160	4 P	3115 4016	3125 4016
250	3 P	3115 3025	3125 3025
250	4 P	3115 4025	3125 4025
400	3 P	3115 3040	3125 3040
400	4 P	3115 4040	3125 4040
500	3 P	3115 3050	3125 3050
500	4 P	3115 4050	3125 4050

(1) Combined fuse version: please consult us.

(2) For rating 16 to 100 A, see page A.18 "SIRCO M & MV".

Connection

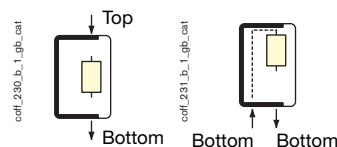

Dimensions

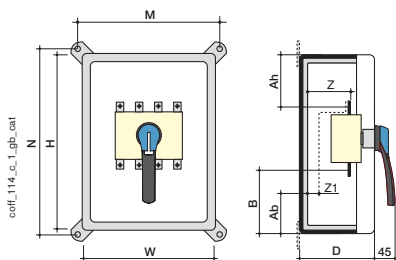

Rating (A)	No. of poles	H x W x D (mm)	Max. connection section (mm²)	M	N	Z	Z1	Ah	B	Weight (kg)	Ab	B	Weight (kg)
125	3/4 P	360 x 270 x 171	50	271	361	33	-	120	126	5	-	-	*
125	3/4 P	360 x 270 x 201	50	271	361	62	28	-	-	-	166	205	6
160	3/4 P	360 x 270 x 171	95	271	361	33	-	120	126	5	-	-	*
160	3/4 P	360 x 270 x 201	95	271	361	62	28	-	-	-	166	205	6
250	3/4 P	540 x 360 x 171	150	361	541	35	-	200	210	8	-	-	*
250	3/4 P	540 x 360 x 201	150	361	541	55	25	-	-	-	279	360	10
400	3/4 P	720 x 540 x 201	240	541	721	42	-	258	258	18	316	433	23
500	3/4 P	720 x 540 x 201	240	541	721	51	38	258	258	18	316	433	24

* Please consult us.



Characteristics (according to IEC 60947-3)

Thermal current I_{th} (40°C)	125 A	160 A	200 A	250 A	315 A	400 A	500 A	630 A	800 A
Rated insulation voltage U_i (V)	800	800	800	800	1000	1000	1000	1000	1000
Rated impulse withstand voltages U_{imp} (kV)	8	8	8	8	12	12	12	12	12

Rated operational currents I_e (A)

Rated voltage	Load duty category	A/B ⁽¹⁾	A/B ⁽¹⁾	A/B ⁽¹⁾	A/B ⁽¹⁾	A/B ⁽¹⁾	A/B ⁽¹⁾	A/B ⁽¹⁾	A/B ⁽¹⁾
400 VAC	AC-21 A / AC-21 B	125/125	160/160	200/200	250/250	315/315	400/400	500/500	630/630
	AC-22 A / AC-22 B	125/125	160/160	200/200	250/250	315/315	400/400	500/500	630/630
	AC-23 A / AC-23 B	125/125	160/160	200/200	250/250	315/315	400/400	500/500	630/630
500 VAC	AC-21 A / AC-21 B	125/125	160/160	200/200	250/250	315/315	400/400	500/500	630/630
	AC-22 A / AC-22 B	125/125	125/125	200/200	250/250	315/315	400/400	500/500	630/630
	AC-23 A / AC-23 B	100/100	100/100	160/200	200/250	315/315	315/315	315/315	630/800
690 VAC ⁽²⁾	AC-20 A / AC-20 B	125/125	160/160	200/200	250/250	315/315	400/400	500/500	630/630
	AC-21 A / AC-21 B	125/125	160/160	160/200	200/250	315/315	400/400	500/500	800/800
	AC-22 A / AC-22 B	125/125	125/125	125/160	125/160	250/315	250/315	250/315	800/800
	AC-23 A / AC-23 B	63/80	63/80	80/100	100/125	160/200	160/200	160/200	200/250
220 VDC	DC-20 A / DC-20 B	125/125	160/160	200/200	250/250	315/315	400/400	500/500	630/630
	DC-21 A / DC-21 B	125/125	160/160	160/200	250/250	315/315	400/400	500/500	630/630
	DC-22 A / DC-22 B	125/125	160/160	160/200	250/250	315/315	400/400	500/500	800/800
	DC-23 A / DC-23 B	125/125	125/125	160/160	200/200	315/315	400/400	500/500	800/800
440 VDC	DC-20 A / DC-20 B	125/125	160/160	200/200	250/250	315/315	400/400	500/500	630/630
	DC-21 A / DC-21 B	125 ⁽⁴⁾ /125 ⁽⁴⁾	160 ⁽⁴⁾ /160 ⁽⁴⁾	160 ⁽⁴⁾ /200 ⁽⁴⁾	200 ⁽⁴⁾ /200 ⁽⁴⁾	315 ⁽⁴⁾ /315 ⁽⁴⁾	400 ⁽⁴⁾ /400 ⁽⁴⁾	400 ⁽⁴⁾ /500 ⁽⁴⁾	500 ⁽⁴⁾ /800 ⁽³⁾
	DC-22 A / DC-22 B	125 ⁽⁴⁾ /125 ⁽⁴⁾	125 ⁽⁴⁾ /125 ⁽⁴⁾	160 ⁽⁴⁾ /160 ⁽⁴⁾	200 ⁽⁴⁾ /200 ⁽⁴⁾	315 ⁽⁴⁾ /315 ⁽⁴⁾	400 ⁽⁴⁾ /400 ⁽⁴⁾	400 ⁽⁴⁾ /400 ⁽⁴⁾	500 ⁽⁴⁾ /800 ⁽³⁾
	DC-23 A / DC-23 B	125 ⁽³⁾ /125 ⁽³⁾	125 ⁽³⁾ /125 ⁽³⁾	160 ⁽³⁾ /160 ⁽³⁾	200 ⁽³⁾ /200 ⁽³⁾	315 ⁽³⁾ /315 ⁽³⁾	400 ⁽³⁾ /400 ⁽³⁾	400 ⁽³⁾ /400 ⁽³⁾	500 ⁽³⁾ /800 ⁽³⁾
500 VDC	DC-20 A / DC-20 B	125/125	160/160	200/200	250/250	315/315	400/400	500/500	630/630
	DC-21 A / DC-21 B	125 ⁽⁴⁾ /125 ⁽⁴⁾	125 ⁽⁴⁾ /125 ⁽⁴⁾	160 ⁽⁴⁾ /200 ⁽⁴⁾	200 ⁽⁴⁾ /200 ⁽⁴⁾	315 ⁽⁴⁾ /315 ⁽⁴⁾	400 ⁽⁴⁾ /400 ⁽⁴⁾	400 ⁽⁴⁾ /400 ⁽⁴⁾	500 ⁽⁴⁾ /800 ⁽³⁾
	DC-22 A / DC-22 B	125 ⁽³⁾ /125 ⁽³⁾	125 ⁽³⁾ /125 ⁽³⁾	160 ⁽³⁾ /160 ⁽³⁾	200 ⁽³⁾ /200 ⁽³⁾	315 ⁽³⁾ /315 ⁽³⁾	315 ⁽³⁾ /400 ⁽³⁾	315 ⁽³⁾ /400 ⁽³⁾	500 ⁽³⁾ /800 ⁽³⁾
	DC-23 A / DC-23 B	125 ⁽³⁾ /125 ⁽³⁾	125 ⁽³⁾ /125 ⁽³⁾	160 ⁽³⁾ /160 ⁽³⁾	200 ⁽³⁾ /200 ⁽³⁾	315 ⁽³⁾ /315 ⁽³⁾	315 ⁽³⁾ /400 ⁽³⁾	315 ⁽³⁾ /400 ⁽³⁾	500 ⁽³⁾ /800 ⁽³⁾

Operational power in AC-23 (kW) ⁽¹⁾⁽⁵⁾

At 400 VAC without pre-break AC	63/63	80/80	100/100	132/132	160/160	220/220	280/280	280/280	450/450
At 500 VAC without pre-break AC	63/63	63/63	110/140	140/160	220/220	220/220	220/220	220/220	450/560
At 690 VAC without pre-break AC	55/75	55/75	75/90	90/110	150/185	150/185	150/185	150/185	185/220

Reactive power (kvar) ⁽⁵⁾

At 400 VAC	55	75	90	115	145	185	230	290	365
------------	----	----	----	-----	-----	-----	-----	-----	-----

Fuse protected short-circuit withstand ⁽⁶⁾

Prospective short-circuit (kA rms)	100	100	80	50	100	100	100	70	50
Associated fuse rating (A)	125	160	200	250	315	400	500	630	800

Overload capacity

Rated short-time withstand current 0,3 s. I_{cw} (kA rms)	15	15	17	17	25	25	25	25	50
Rated peak withstand current (kA peak) ⁽⁶⁾	20	20	30	30	45	45	45	45	55

Connection

Minimum Cu cable section (mm ²)	35	50	70	95	150	185	240	2 x 150	2 x 185
Minimum Cu busbar section (mm ²)	-	-	-	-	-	-	-	2 x 30 x 5	2 x 40 x 5
Maximum Cu cable section (mm ²)	50	95	95	150	240	240	240	2 x 300	2 x 300
Maximum Cu busbar width (mm)	25	25	32	32	40	40	40	50	63
Min. tightening torque (Nm)	9	9	20	20	20	20	20	40	-

Mechanical characteristics

Endurance (number of operating cycles)	10 000	10 000	10 000	10 000	5 000	5 000	5 000	5 000	3000
Operating effort (Nm)	6.5	6.5	10	10	14.5	14.5	14.5	14.5	37
Weight of 3 P switch (kg)	1	1.5	2	2	3.5	3.5	3.5	3.5	8
Weight of 4 P switch (kg)	1.5	1.5	2	2	4	4	4.5	4.5	10

(1) A/B: Category with index A = frequent operation - Category with index B = infrequent operation. (2) With terminal shrouds or phase barrier. (3) 4-pole device with 2 pole in series by polarity. (4) 3-pole device with 2 pole in series for the + and 1 pole for the -. (5) The power value is given for information only, the current values vary from one manufacturer to another. (6) For a rated operating voltage U_{ge} = 400 VAC.

SIRCO

125 to 4000 A

Functions

References

Accessories

Enclosed load break switches

▶ Characteristics

▶ Dimensions

Characteristics (according to IEC 60947-3)

Thermal current I_{th} (40°C)	1000 A	CD 1250 A	1250 A	1600 A	1800 A	2000 A	2500 A	3200 A	4000 A
Rated insulation voltage U_i (V)	1000	1000	1000	1000	1000	1000	1000	1000	1000
Rated impulse withstand voltages U_{imp} (kV)	12	12	12	12	12	12	12	12	12

Rated operational currents I_e (A)

Rated voltage	Load duty category	A/B ⁽¹⁾	A/B ⁽¹⁾	A/B ⁽¹⁾	A/B ⁽¹⁾	A/B ⁽¹⁾	A/B ⁽¹⁾	A/B ⁽¹⁾	A/B ⁽¹⁾	A/B ⁽¹⁾
400 VAC	AC-21 A / AC-21 B	1000/1000	1250/1250	1250/1250	1600/1600	1800/1800	2000/2000	2500/2500	3200/3200	3200/3200
	AC-22 A / AC-22 B	1000/1000	1250/1250	1250/1250	1600/1600	1800/1800	2000/2000	2000/2500	2500/3200	2500/2500
	AC-23 A / AC-23 B	1000/1000	1250/1250	1250/1250	1250/1250	1250/1250	1600/1600	1600/1600	1600/1600	1250/1250
500 VAC	AC-21 A / AC-21 B	800/800	800/800	1250/1250	1600/1600	1600/1600	2000/2000	2500/2500	3200/3200	3200/3200
	AC-22 A / AC-22 B	800/800	800/800	1250/1250	1250/1250	1250/1250	1600/2000	1600/2000	2000/2000	2000/2000
	AC-23 A / AC-23 B	630/800	630/800	1000/1000	1000/1000	1000/1000	1000/1000	1000/1000	1000/1000	1000/1000
690 VAC ⁽²⁾	AC-20 A / AC-20 B	1000/1000	1250/1250	1250/1250	1600/1600	1800/1800	2000/2000	2500/2500	3200/3200	4000/4000
	AC-21 A / AC-21 B	800/800	800/800	1000/1000	1000/1000	1000/1000	2000/2000	2000/2500	2000/2500	2000/2500
	AC-22 A / AC-22 B	800/800	800/800	1000/1000	1000/1000	1000/1000	1000/1000	1000/1000	1000/1000	1000/1000
	AC-23 A / AC-23 B	200/250	200/250	500/500	500/500	500/500	800/800	800/800	800/800	800/800
220 VDC	DC-20 A / DC-20 B	1000/1000	1250/1250	1250/1250	1600/1600	1800/1800	2000/2000	2500/2500	3200/3200	4000/4000
	DC-21 A / DC-21 B	1000/1000	1250/1250	1250/1250	1250/1250	1250/1250	2000/2000	2000/2500	2000/2500	2000/2500
	DC-22 A / DC-22 B	1000/1000	1250/1250	1250/1250	1250/1250	1250/1250	1250/1600	1250/1600	1250/1600	1250/1600
	DC-23 A / DC-23 B	1000/1000	1250/1250	1250/1250	1250/1250	1250/1250	1250 ⁽³⁾ /1250 ⁽³⁾	1250 ⁽³⁾ /1250 ⁽³⁾	1250 ⁽³⁾ /1250 ⁽³⁾	1250/1250
440 VDC	DC-20 A / DC-20 B	1000/1000	1250/1250	1250/1250	1600/1600	1800/1800	2000/2000	2500/2500	3200/3200	4000/4000
	DC-21 A / DC-21 B	1000 ⁽³⁾ /1000 ⁽³⁾	1250 ⁽³⁾ /1250 ⁽³⁾	1250 ⁽³⁾ /1250 ⁽³⁾	1250 ⁽³⁾ /1250 ⁽³⁾	1250 ⁽³⁾ /1250 ⁽³⁾	2000/2000	2000/2000	2000/2000	2000/2000
	DC-22 A / DC-22 B	1000 ⁽³⁾ /1000 ⁽³⁾	1250 ⁽³⁾ /1250 ⁽³⁾	1250 ⁽³⁾ /1250 ⁽³⁾	1250 ⁽³⁾ /1250 ⁽³⁾	1250 ⁽³⁾ /1250 ⁽³⁾	1250 ⁽³⁾ /1250 ⁽³⁾	1250 ⁽³⁾ /1250 ⁽³⁾	1250 ⁽³⁾ /1250 ⁽³⁾	1250/1250
	DC-23 A / DC-23 B	1000 ⁽³⁾ /1000 ⁽³⁾	1250 ⁽³⁾ /1250 ⁽³⁾	1250 ⁽³⁾ /1250 ⁽³⁾	1250 ⁽³⁾ /1250 ⁽³⁾	1250 ⁽³⁾ /1250 ⁽³⁾	1000 ⁽³⁾ /1000 ⁽³⁾	1000 ⁽³⁾ /1000 ⁽³⁾	1000 ⁽³⁾ /1000 ⁽³⁾	1000 ⁽³⁾ /1000 ⁽³⁾
500 VDC	DC-20 A / DC-20 B	1000/1000	1250/1250	1250/1250	1600/1600	1800/1800	2000/2000	2500/2500	3200/3200	4000/4000
	DC-21 A / DC-21 B	1000 ⁽³⁾ /1000 ⁽³⁾	1250 ⁽³⁾ /1250 ⁽³⁾	1250 ⁽³⁾ /1250 ⁽³⁾	1250 ⁽³⁾ /1250 ⁽³⁾	1250 ⁽³⁾ /1250 ⁽³⁾	1250/1250	1250/1250	1250/1250	1250/1250
	DC-22 A / DC-22 B	1000 ⁽³⁾ /1000 ⁽³⁾	1250 ⁽³⁾ /1250 ⁽³⁾	1250 ⁽³⁾ /1250 ⁽³⁾	1250 ⁽³⁾ /1250 ⁽³⁾	1250 ⁽³⁾ /1250 ⁽³⁾	1250 ⁽³⁾ /1250 ⁽³⁾	1250 ⁽³⁾ /1250 ⁽³⁾	1250 ⁽³⁾ /1250 ⁽³⁾	1250 ⁽³⁾ /1250 ⁽³⁾
	DC-23 A / DC-23 B	1000 ⁽³⁾ /1000 ⁽³⁾	1250 ⁽³⁾ /1250 ⁽³⁾	1250 ⁽³⁾ /1250 ⁽³⁾	1250 ⁽³⁾ /1250 ⁽³⁾	1250 ⁽³⁾ /1250 ⁽³⁾	1000 ⁽³⁾ /1000 ⁽³⁾	1000 ⁽³⁾ /1000 ⁽³⁾	1000 ⁽³⁾ /1000 ⁽³⁾	1000 ⁽³⁾ /1000 ⁽³⁾

Operational power in AC-23 (kW)⁽¹⁾⁽⁵⁾

At 400 VAC without pre-break AC	560/560	710/710	710/710	710/710	710/710	710/710	710/710	710/710	710/710
At 500 VAC without pre-break AC	450/560	450/560	710/710	710/710	710/710	710/710	710/710	710/710	710/710
At 690 VAC without pre-break AC	185/220	185/220	475/475	475/475	475/475	750/750	750/750	750/750	750/750

Reactive power (kvar)⁽⁵⁾

At 400 VAC	460	575	575	-	-	-	-	-	-
------------	-----	-----	-----	---	---	---	---	---	---

Fuse protected short-circuit withstand ⁽⁶⁾

Prospective short-circuit (kA rms)	100	100	100	100	100	100	100	-	-
Associated fuse rating (A)	1000	1250	1250	2 x 800	2 x 800	2 x 1000	2 x 1250	-	-

Overload capacity

Rated short-time withstand current 0,3 s I_{LW} (kA rms)	65	65	100	100	100	100	100	110	110
Rated peak withstand current (kA peak) ⁽⁶⁾	80	80	110	110	110	110	110	120	150

Connection

Minimum Cu cable section (mm ²)	2 x 240	-	-	-	-	-	-	-	-
Minimum Cu busbar section (mm ²)	2 x 50 x 5	2 x 60 x 5	2 x 60 x 5	2 x 80 x 5	3 x 100 x 5	3 x 100 x 5	4 x 100 x 5	4 x 100 x 5	4 x 100 x 10
Maximum Cu cable section (mm ²)	4 x 185	4 x 185	4 x 185	6 x 185	6 x 185	-	-	-	-
Maximum Cu busbar width (mm)	63	63	100	100	100	125	125	125	125
Min. tightening torque (Nm)	-	-	40	40	40	40	40	40	40

Mechanical characteristics

Endurance (number of operating cycles)	3 000	3 000	4 000	4 000	4 000	3 000	3 000	3 000	2 500
Operating effort (Nm)	37	37	56	56	56	75	75	75	110
Weight of 3 P switch (kg)	8	8	12	12	12	22	22	22	90
Weight of 4 P switch (kg)	10	10	15	15	15	25	25	25	102

(1) A/B: Category with index A = frequent operation - Category with index B = infrequent operation. (2) With terminal shrouds or phase barrier. (3) 4-pole device with 2 pole in series by polarity. (4) 3-pole device with 2 pole in series for the + and 1 pole for the -. (5) The power value is given for information only, the current values vary from one manufacturer to another. (6) For a rated operating voltage $U_e = 400$ VAC.



Dimensions

► Front operation

• SIRCO 125 to 630 A

Direct front operation

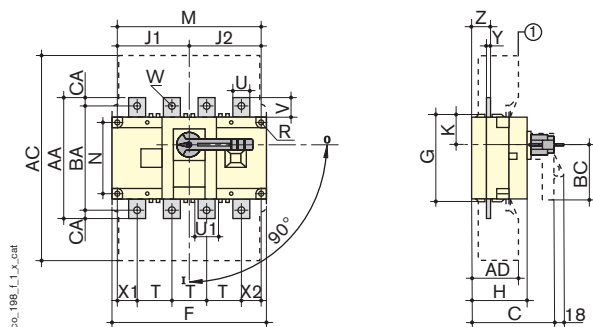

1. Terminal shrouds

External front operation

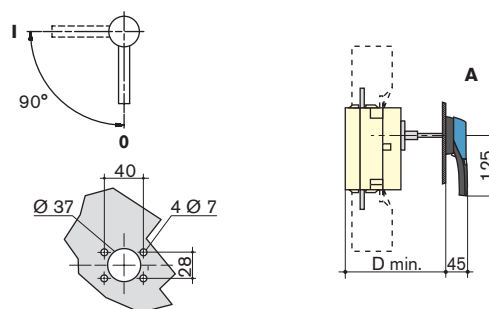

A. S2 type handle

Rating	Overall dimensions		Terminal shrouds		Switch body										Switch mounting								Connection terminals											
(A)	C	D min.	AC	AD	F 3p.	F 4p.	G	H	J1 3p.	J1 4p.	J2	K	BC	M 3p.	M 4p.	N	R	T	U	U1	V	W	X1 3p.	X1 4p.	X2	Y	Z	AA	BA	CA				
125	115	125	235	50	140	170	93	65	45	75	75	31.5	80	120	150	65	5.5	36	20	20.5	25	9	28	22	20	3.5	20.5	135	115	10				
160	115	125	235	50	140	170	93	65	45	75	75	31.5	80	120	150	65	5.5	36	20	20.5	25	9	28	22	20	3.5	20.5	135	115	10				
200	125	135	280	60	180	230	108	75	55	105	105	34	115	160	210	80	5.5	50	25	25.5	30	11	33	33	27	3.5	22.5	160	130	15				
250	125	135	280	60	180	230	108	75	55	105	105	34	115	160	210	80	5.5	50	25	25.5	30	11	33	33	27	3.5	22.5	160	130	15				
315	160	165	401	89	230	290	170	110	75	135	135	55	115	210	270	140	7	65	32	45.5	37.5	11	42.5	37.5	37.5	5	36	235	205	15				
400	160	165	401	89	230	290	170	110	75	135	135	55	115	210	270	140	7	65	32	45.5	37.5	11	42.5	37.5	37.5	5	36	235	205	15				
500	160	165	401	89	230	290	170	110	75	135	135	55	115	210	270	140	7	65	32	45.5	37.5	13	42.5	37.5	37.5	5	36	235	205	15				
630	160	165	400	89	230	290	170	110	75	135	135	55	115	210	270	140	7	65	45	45.5	50	13	42.5	37.5	37.5	5	36	260	220	20				

• SIRCO 800 to 1800 A

Direct front operation

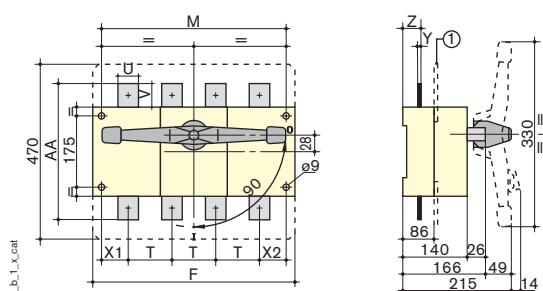

1. Terminal screens

External front operation

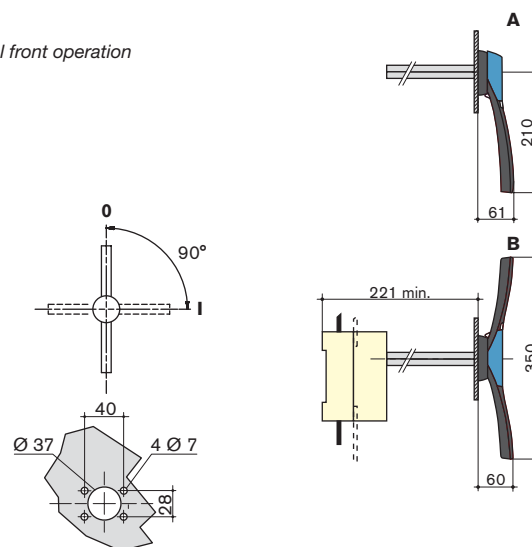

A. Handle single lever S3 type
B. Handle double lever S4 type

Rating (A)	Switch body		Switch mounting		Connection terminals									
	F 3p.	F 4p.	M 3p.	M 4p.	T	U	V	Y	X1	X2	Z	AA		
800	280	360	255	335	80	50	60.5	7	47.5	47.5	46.5	321		
1000	280	360	255	335	80	50	60.5	7	47.5	47.5	46.5	321		
CD 1250	280	360	255	335	80	60	65	7	47.5	47.5	46.5	330		
1250	372	492	347	467	120	90	44	8	53.5	53.5	47.5	288		
1600	372	492	347	467	120	90	44	8	53.5	53.5	47.5	288		
1800	372	492	347	467	120	90	44	8	53.5	53.5	47.5	288		

SIRCO

125 to 4000 A

Functions

References

Accessories

Enclosed load break switches

Characteristics

► **Dimensions**

Dimensions

► Front operation

• SIRCO 2000 to 3200 A

Direct front operation

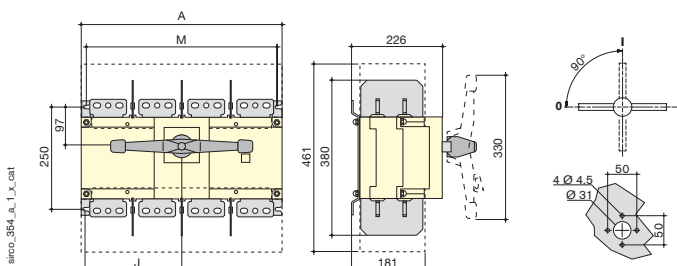

Rating (A)	Overall dimensions		Switch body		Switch mounting	
	A 3p.	A 4p.	J 3p.	J 4p.	M 3p.	M 4p.
2000 ... 3200	372	492	173.5	233.5	347	467

• SIRCO 4000 A

Direct front operation

External front operation

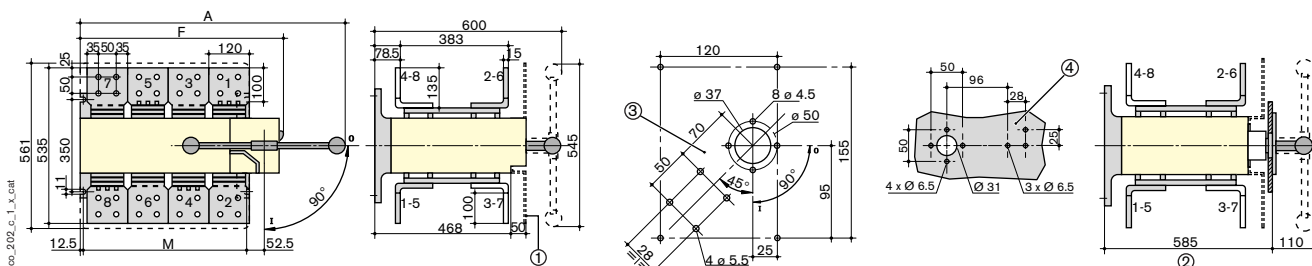

1. Terminal screens
2. Min. length with coupling part for shaft extension (shaft 40 mm): 635 mm
3. Door drilling with RONIS EL11AP lock
4. Door drilling with CASTELL K lock

Rating (A)	Overall dimensions		Switch body		Switch mounting	
	A 3p.	A 4p.	F 3p.	F 4p.	M 3p.	M 4p.
4000	684	804	470	590	347	467



Dimensions

► Connection terminals

• SIRCO 800 to 1000 A

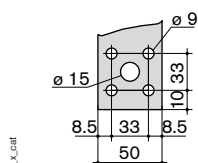

siro_207_a_1_x_cat

• SIRCO CD 1250 A

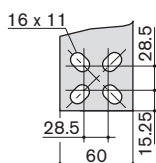

siro_270_b_1_x_cat

• SIRCO 1250 to 3200 A

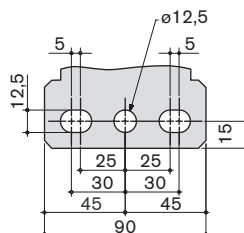

siro_098_a_1_x_cat

• SIRCO 4000 A

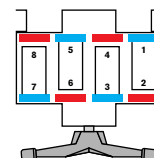

siro_273_a_1_x_cat

Top terminals
Bottom terminals

Note: Screws and bolts not suitable for SIRCO 800 to 4000 A ratings.

► Copper bars connection kits

• Fig. 1

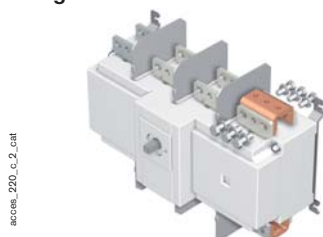

siro_224_a_1_x_cat

• Fig. 2

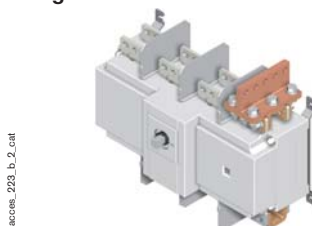

siro_225_a_1_x_cat

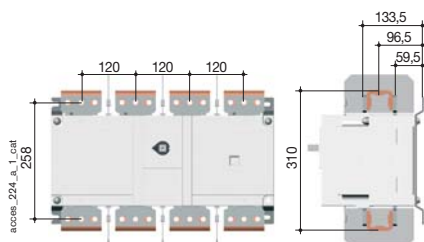

siro_224_a_1_x_cat

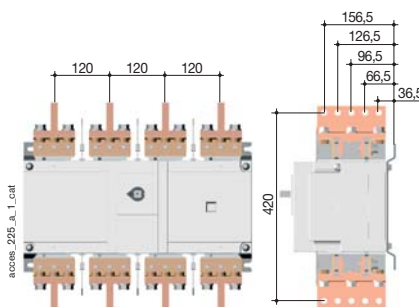

siro_225_a_1_x_cat

► Door drilling

• With RONIS EL11AP lock

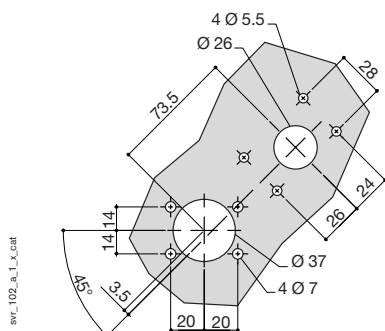

siro_102_a_1_x_cat

• With CASTELL K lock for SIRCO 125 to 1800 A

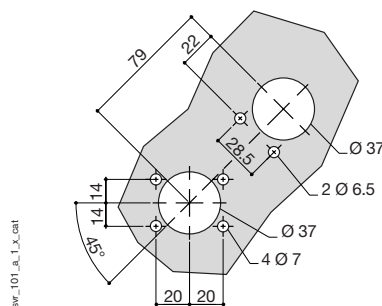

siro_101_a_1_x_cat

• With CASTELL K lock for SIRCO 2000 to 3200 A

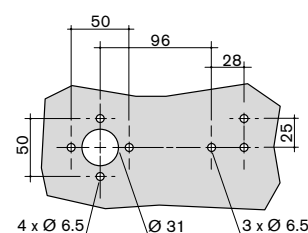

siro_224_b_1_x_cat